

Electoral Roll - 2014

State - (S10) -Karnataka

| No.,Name and Reservation Status of Assembly Constituency | 154-Rajarajeshwarinagar (Gen) | Part No. 326 | | | | | | | | | | | | |
|--|---|-----------------------------|-----------|----------|----------------------------|----------------|----------------------|--------|--|----------|-------------------|----------|--------|--|
| No.,Name and Reservation Status of Parliamentary Constituency(ies) in which the Assembly Constituency is located | | 23 - Bangalore Rural (Gen) | | | | | | | | | | | | |
| 1. DETAILS OF REVISION | | | | | | | | | | | | | | |
| Year of Revision | 2014 | Roll Identification | | | | | | | | | | | | |
| Qualifying Date | 01-01-2014 | Basic (Mother) Roll of 2014 | | | | | | | | | | | | |
| Type of Revision | Summary Revision | | | | | | | | | | | | | |
| Date of Publication | 31-01-2014 | | | | | | | | | | | | | |
| 2. DETAILS OF PART & POLLING AREA | | | | | | | | | | | | | | |
| No. & Name of the Sections in the Part | | | | | | | | | | | | | | |
| 01 B E M L Layout,Pincode - 560098 | | | | | | | | | | | | | | |
| 02 Gattigere Gram tana Gattigere Revenu,Pincode - 560098 | <table border="1" style="width: 100%; border-collapse: collapse;"> <tr> <td>Main Metro</td> <td>Bangalore</td> </tr> <tr> <td>Ward No.</td> <td>160 - Rajarajeshwari Nagar</td> </tr> <tr> <td>Police Station</td> <td>Rajarajeshwari Nagar</td> </tr> <tr> <td>Taluka</td> <td></td> </tr> <tr> <td>District</td> <td>B.B.M.P (CENTRAL)</td> </tr> <tr> <td>Pin Code</td> <td>560098</td> </tr> </table> | Main Metro | Bangalore | Ward No. | 160 - Rajarajeshwari Nagar | Police Station | Rajarajeshwari Nagar | Taluka | | District | B.B.M.P (CENTRAL) | Pin Code | 560098 | |
| Main Metro | Bangalore | | | | | | | | | | | | | |
| Ward No. | 160 - Rajarajeshwari Nagar | | | | | | | | | | | | | |
| Police Station | Rajarajeshwari Nagar | | | | | | | | | | | | | |
| Taluka | | | | | | | | | | | | | | |
| District | B.B.M.P (CENTRAL) | | | | | | | | | | | | | |
| Pin Code | 560098 | | | | | | | | | | | | | |
| 3. POLLING STATION DETAILS | | | | | | | | | | | | | | |
| No. And Name of Polling Station | Type of Polling Station (Male/Female/General) | General | | | | | | | | | | | | |
| 326-B.E.T. School, Newbuilding, Room No-4, BEML Layout 3rd stage Rajarajeshwarinagar Bangalore | | | | | | | | | | | | | | |
| Address of Polling Station | Number of Auxiliary Polling Stations in this Part | 0 | | | | | | | | | | | | |
| B.E.T. School, Newbuilding, Room No-3 B.E.M.L. Layout 3rd Stage | | | | | | | | | | | | | | |
| 4. NUMBER OF ELECTORS | | | | | | | | | | | | | | |
| Starting Sl. No. | Ending Sl.No. | Male | Female | Others | Total | | | | | | | | | |
| 1 | 1161 | 583 | 561 | 0 | 1144 | | | | | | | | | |

No.,Name and Reservation Status of Assembly Constituency

154 - Rajarajeshwarinagar(GEN) Part No. 326

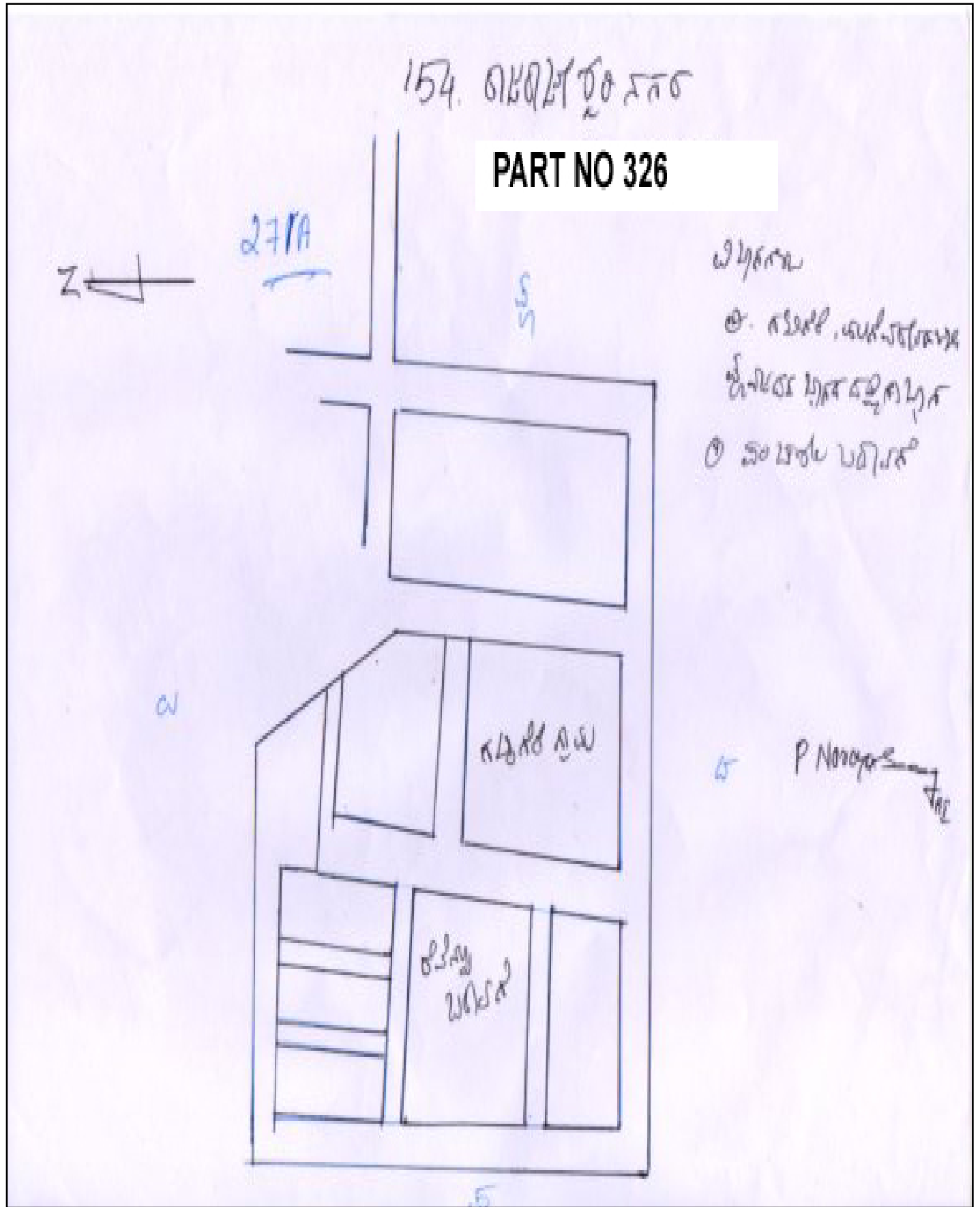

Section No.:001)B E M L Layout, , Ward No: 160 -560098 Continued

| | | | | | | | | |
|------|------------|---|----|------------|---|----|------------|---|
| 1 | REJ5633300 | Name : A.Meena Husband's Name: SHRINIVASALU House No.:K.T.HANUMIAIAH BULDING Age: 28 Sex: Female | 2 | REJ5633425 | Name : Shrinivasalu Father's Name: VENKATARAMANAPP A House No.:K.T.HANUMIAIAH BULDING Age: 28 Sex: Male | 3 | REJ5600176 | Name : Puttaraju.B Father's Name: BASAVARAJU House No.:01 Age: 30 Sex: Male |
| 4 | REJ5799887 | Name : Gayathri.H Husband's Name: PUTTARAJU.B House No.:01 Age: 28 Sex: Female | 5 | REJ6041701 | Name : Gangadhar Father's Name: AYYA DHORE House No.:01 Age: 46 Sex: Male | 6 | REJ6080964 | Name : Selvi Husband's Name: GANGADHAR House No.:01 Age: 40 Sex: Female |
| 7 | REJ6102313 | Name : Chandra Husband's Name: PERUMAL House No.:01 Age: 25 Sex: Female | 8 | REJ6115802 | Name : Chandra Husband's Name: PERUMAL House No.:01 Age: 25 Sex: Female | 9 | REJ6137921 | Name : Papamma Husband's Name: Late.Perumal House No.:01 Age: 24 Sex: Female |
| 10 | REJ6154561 | Name : Chandra Husband's Name: PERUMAL House No.:01 Age: 28 Sex: Female | 11 | REJ6158364 | Name : Perumal Father's Name: RAMAN House No.:1 Age: 29 Sex: Male | 12 | REJ6140537 | Name : Chandra Father's Name: PERUMAL House No.:1 Age: 25 Sex: Female |
| 13 | REJ6166748 | Name : Rukku Mani Husband's Name: Late.Palaniswamy House No.:1 Age: 32 Sex: Female | 14 | REJ5787346 | Name : Basavaraju.D.J Father's Name: JAVAREGOWDA House No.:1/8/2 Age: 44 Sex: Male | 15 | REJ5633060 | Name : Annappa.M Father's Name: MUNIYAPPA.V House No.:02 Age: 42 Sex: Male |
| 16 | REJ6188312 | Name : S.Chidanandaiah Father's Name: MAHANTHAIH.S.M House No.:2A Age: 51 Sex: Male | 17 | REJ6189906 | Name : Uma Devi.H.M Husband's Name: CHIDANANDAIAH .S.M House No.:2A Age: 40 Sex: Female | 18 | REJ5876289 | Name : Ramanand .M Father's Name: CHANDRASHEKARAIA H.M House No.:B2 Age: 63 Sex: Male |
| 19 | REJ5876321 | Name : Usha Ramanand Husband's Name: RAMANAND.M House No.:B2 Age: 51 Sex: Female | 20 | REJ6218341 | Name : Smitha Holla Husband's Name: Srikanth KS House No.:B-2, Rajsadan Age: 28 Sex: Female | 21 | REJ5975875 | Name : Ananda.B.M Father's Name: B.P.MADHAIH House No.:03 Age: 43 Sex: Male |
| # 22 | REJ5945464 | Name : Arun Chakravarty Sethu Father's Name: Sethu Chakravarty House No.:Flat G3,Sri Gowri Agency Age: 27 Sex: Male | 23 | REJ6083950 | Name : Shilpi Bandil Husband's Name: AMIT BANDIL House No.:A3 Age: 31 Sex: Female | 24 | REJ6057731 | Name : Shilpi Bindil Husband's Name: AMIT House No.:A3 Age: 31 Sex: Female |
| 25 | REJ6058689 | Name : Amit Bindil Father's Name: SURESH BINDIL House No.:A3 Age: 19 Sex: Male | 26 | REJ6036750 | Name : Shilpi Bandil Husband's Name: AMIT BANDIL House No.:A3 Age: 31 Sex: Female | 27 | REJ5633839 | Name : Radha.S Husband's Name: SHANMUGA.A House No.:04 Age: 24 Sex: Female |
| 28 | REJ5634076 | Name : Shwetha.C.J Father's Name: LATE.JAYARAMA House No.:04 Age: 24 Sex: Female | 29 | REJ5634092 | Name : Sheela.C.J Husband's Name: SIDDARAJU.C.N House No.:04 Age: 29 Sex: Female | 30 | REJ6002406 | Name : Padmashree Husband's Name: E.RAMESH House No.:5/D Age: 26 Sex: Female |

Section No.:001)B E M L Layout, , Ward No: 160 -560098 Continued

| | | | | | | | | |
|----|------------|---|----|------------|--|----|------------|---|
| 31 | REJ6002430 | Name : E.Ramesh Father's Name: URUF CHENAIAH House No.:5/D Age: 29 Sex: Male | 32 | REJ6002380 | Name : K.Mariyamma Father's Name: CHANAIAH URUF House No.:5/D Age: 66 Sex: Female | 33 | REJ5975909 | Name : Chanaiah Uruf Father's Name: LATE.I.P.ESHWARAIAH House No.:5/D Age: 28 Sex: Male |
| 34 | REJ5518071 | Name : P N Nandini Husband's Name: A S Veerendra Kumar House No.:7 Age: 38 Sex: Female | 35 | REJ5517933 | Name : A S Veerendra Kumar Father's Name: A C Shivashankar House No.:7 Age: 44 Sex: Male | 36 | REJ6217384 | Name : Geetha Ramdas Husband's Name: Ramdas B S House No.:#7, Flat NO. G2 Age: 58 Sex: Female |
| 37 | REJ5975792 | Name : Jyothi.R Mother's Name: ANJALI.R House No.:09 Age: 24 Sex: Female | 38 | REJ5975586 | Name : Mani.R Mother's Name: ANJALI.R House No.:09 Age: 19 Sex: Male | 39 | REJ6092225 | Name : Malatesh Kulkarni Father's Name: ACHUTA RAO .K.KULKARNI House No.:09 Age: 37 Sex: Male |
| 40 | REJ6054837 | Name : Ashwini Kulkarni Husband's Name: ASHOK RAO KULKARNI House No.:09 Age: 27 Sex: Female | 41 | REJ6067276 | Name : Joel Fernandes Father's Name: JOHN FERNANDES House No.:09 Age: 20 Sex: Male | 42 | REJ6052161 | Name : Sudhabai Husband's Name: ACHUTHA RAO .K.KULKARNI House No.:09 Age: 61 Sex: Female |
| 43 | REJ5975115 | Name : Sathyavathi.R Mother's Name: R.ANJALI House No.:09 Age: 22 Sex: Female | 44 | REJ6151187 | Name : Mani.R Mother's Name: R.ANJALI House No.:09 Age: 19 Sex: Male | 45 | REJ6128995 | Name : Mani.R Father's Name: R.ANJALI House No.:09 Age: 19 Sex: Male |
| 46 | REJ5518154 | Name : Kiran M G Father's Name: Guligowda House No.:10 Age: 22 Sex: Male | 47 | REJ5975123 | Name : Usha D.Hegade Husband's Name: DAYANANDA S.HEGADE House No.:11 Age: 51 Sex: Female | 48 | REJ5975206 | Name : Manisha D.Hegade Mother's Name: USHA.D.HEGADE House No.:11 Age: 24 Sex: Female |
| 49 | REJ5634175 | Name : P.G.Vijayalakshmi Husband's Name: P.K.GANAPATHY House No.:12 Age: 38 Sex: Female | 50 | REJ5633409 | Name : P.K.Ganapathi Father's Name: P.P.KARIAPPA House No.:12 Age: 39 Sex: Male | 51 | REJ6140198 | Name : Anitha.N Husband's Name: KRISHNA MURTHY.N.P House No.:12 Age: 38 Sex: Female |
| 52 | REJ6176234 | Name : Krishna Murthy.N.P Father's Name: NARASIMHAIAH House No.:12 Age: 38 Sex: Male | 53 | REJ5975107 | Name : N.B.Anusuya Husband's Name: SOMASHEKARIAIAH House No.:12 Age: 46 Sex: Female | 54 | REJ5975925 | Name : Somashekaraiah Father's Name: SIDDAPPA LINGAPPA House No.:12 Age: 47 Sex: Male |
| 55 | REJ5975693 | Name : Somashekaraiah Father's Name: SIDDALINGAPPA House No.:12 Age: 47 Sex: Male | 56 | REJ5975669 | Name : Nityashree.K.S Husband's Name: SOMASHEKARIAIAH House No.:12 Age: 20 Sex: Female | 57 | REJ5787411 | Name : Pavithra.A.S Husband's Name: YOGANARASIMHA MURTHY.E.R House No.:12/7 Age: 25 Sex: Female |
| 58 | REJ5632948 | Name : Suma.B.M Father's Name: MAHADEVAIAH House No.:13 Age: 33 Sex: Female | 59 | REJ5517867 | Name : Sandhya K J Husband's Name: Narasegowda N House No.:14 Age: 25 Sex: Female | 60 | REJ5633953 | Name : Chaitra Husband's Name: MAHADEVA RAO House No.:15 Age: 31 Sex: Female |

Section No.:001)B E M L Layout, , Ward No: 160 -560098 Continued

| | | | | | |
|-------------------------------------|-------------|-------------------------------------|-------------|----------------------------------|-------------|
| 61 | REJ6181218 | 62 | REJ5517990 | 63 | REJ5518105 |
| Name : B.K.Nagaraja | | Name : Pooja P | | Name : Prakasha | |
| Father's Name: T.KARIYAPPA | | Father's Name: Prakasha | | Father's Name: MAllapa Late | |
| House No.:15 | | House No.:16 | | House No.:16 | |
| Age: 31 | Sex: Male | Age: 19 | Sex: Female | Age: 50 | Sex: Male |
| 64 | REJ5633847 | 65 | REJ5633821 | 66 | REJ5633573 |
| Name : Maruthi | | Name : Subhash.N.Singennava | | Name : Komala.T | |
| Father's Name: OBILOSH | | Father's Name: NEELAPPA SINGENNAVAR | | Husband's Name: MARUTHI | |
| House No.:17 | | House No.:17 | | House No.:17 | |
| Age: 31 | Sex: Male | Age: 31 | Sex: Male | Age: 26 | Sex: Female |
| 67 | REJ5633680 | 68 | REJ6186944 | 69 | REJ6177356 |
| Name : Chinna | | Name : S Lalitha | | Name : Pavana. M.N | |
| Father's Name: VENKATAPATHI NAIDU.B | | Mother's Name: G Nagarathna | | Husband's Name: Prakash | |
| House No.:17 | | House No.:17 | | House No.:17 | |
| Age: 31 | Sex: Male | Age: 42 | Sex: Female | Age: 36 | Sex: Female |
| 70 | REJ6191431 | 71 | REJ6181119 | 72 | REJ6136543 |
| Name : Prakash | | Name : Satish | | Name : Satish | |
| Father's Name: Shivalingappa | | Father's Name: Mani | | Father's Name: Mani | |
| House No.:17 | | House No.:17 | | House No.:17 | |
| Age: 36 | Sex: Male | Age: 24 | Sex: Male | Age: 24 | Sex: Male |
| 73 | REJ6158422 | 74 | REJ6150379 | 75 | REJ6100598 |
| Name : G Nagarathna | | Name : Baiju Haridas | | Name : Baiju Haridas | |
| Husband's Name: G Subbaraju | | Father's Name: Haridas | | Father's Name: Late.Haridas | |
| House No.:17 | | House No.:17 | | House No.:17 | |
| Age: 42 | Sex: Female | Age: 35 | Sex: Male | Age: 35 | Sex: Male |
| 76 | REJ6130819 | 77 | REJ6107452 | 78 | REJ5633003 |
| Name : Sathyabhama | | Name : G Nagarathhna | | Name : Yashodha.H.P | |
| Father's Name: Mani | | Husband's Name: G Subbaraju | | Husband's Name: KALAPPA.H.P | |
| House No.:17 | | House No.:17 | | House No.:18 | |
| Age: 22 | Sex: Female | Age: 42 | Sex: Female | Age: 48 | Sex: Female |
| 79 | REJ5632989 | 80 | REJ5633094 | 81 | REJ5517792 |
| Name : Kalappa.H.P | | Name : Madhura.H.K | | Name : Jyothi B J | |
| Father's Name: PUTTE GOWDA | | Father's Name: KALAPPA.H.P | | Husband's Name: Seetharam B K | |
| House No.:18 | | House No.:18 | | House No.:18 | |
| Age: 53 | Sex: Male | Age: 23 | Sex: Female | Age: 32 | Sex: Female |
| 82 | REJ5517958 | 83 | REJ5517941 | 84 | REJ5517743 |
| Name : M C Channakeshava | | Name : R Bhanumathi | | Name : Seetharam B K | |
| Father's Name: J Channayya | | Husband's Name: M C Channakeshava | | Father's Name: Koragappa Rai | |
| House No.:18 | | House No.:18 | | House No.:18 | |
| Age: 44 | Sex: Male | Age: 34 | Sex: Female | Age: 35 | Sex: Male |
| 85 | REJ5517735 | 86 | REJ5517834 | 87 | REJ6111751 |
| Name : Vidhya B R | | Name : P Savitha | | Name : Kalpana.S.C | |
| Father's Name: Ramanna B A | | Husband's Name: Narayana Swamy | | Husband's Name: APPAJA CHARI.J.C | |
| House No.:18 | | House No.:18 | | House No.:19 | |
| Age: 21 | Sex: Female | Age: 33 | Sex: Female | Age: 43 | Sex: Female |
| 88 | REJ6140941 | 89 | REJ6044549 | 90 | REJ6057814 |
| Name : Deepak.J.A | | Name : Guggari Parashurama | | Name : Renuka.P | |
| Father's Name: APPAJICHAR.J.C | | Father's Name: RAMAPPA | | Husband's Name: PARASHURAMA | |
| House No.:19 | | House No.:19 | | House No.:19 | |
| Age: 21 | Sex: Male | Age: 42 | Sex: Male | Age: 34 | Sex: Female |

Section No.:001)B E M L Layout, , Ward No: 160 -560098 Continued

| | | | | | | | | |
|-----|------------|---|-----|------------|---|-----|------------|--|
| 91 | REJ5975099 | Name : P.Meera Husband's Name: PANEER SELVAM House No.:20 Age: 33 Sex: Female | 92 | REJ5975891 | Name : S.Panneer Selvam Father's Name: SUNDARA VELU House No.:20 Age: 32 Sex: Male | 93 | REJ5975917 | Name : Asha.S Husband's Name: KOTRESHAPPA House No.:23 Age: 26 Sex: Female |
| 94 | REJ5975552 | Name : Rani Husband's Name: MANI House No.:23 Age: 41 Sex: Female | 95 | REJ5975594 | Name : Kotreshappa.K Father's Name: KAREGOWDA House No.:23 Age: 31 Sex: Male | 96 | REJ5975214 | Name : Shivamma Husband's Name: KAREGOWDA House No.:23 Age: 49 Sex: Female |
| 97 | REJ5975081 | Name : Mani Father's Name: SHENMUKHA House No.:23 Age: 50 Sex: Male | 98 | REJ6115455 | Name : Kotreshappa .K Father's Name: KAREGOWDA House No.:23 Age: 31 Sex: Male | 99 | REJ6150569 | Name : Kotreshappa.K Father's Name: KAREGOWDA House No.:23 Age: 31 Sex: Male |
| 100 | REJ5836879 | Name : Anandappa Father's Name: NANJAPPA House No.:23/72 Age: 69 Sex: Male | 101 | REJ5836853 | Name : Gowramma Husband's Name: ANANDAPPA House No.:23/72 Age: 65 Sex: Female | 102 | REJ5836945 | Name : Anitha Father's Name: ANANDAPPA House No.:23/72 Age: 42 Sex: Female |
| 103 | REJ5518279 | Name : Sreenag.H.P Father's Name: PRANESH.H.K House No.:24 Age: 19 Sex: Male | 104 | REJ5633938 | Name : Pratheek Patil Father's Name: KEMPANNA PATIL House No.:24 Age: 20 Sex: Male | 105 | REJ5836937 | Name : B.N.Visweswara Father's Name: LATE.B. NANJACHAR House No.:25 Age: 61 Sex: Male |
| 106 | REJ5836994 | Name : H.A. Mohan Kumari Husband's Name: B.N.VISWESWARA House No.:25 Age: 46 Sex: Female | 107 | REJ6165864 | Name : Punith.C Father's Name: CHANDRAPPA.S House No.:25 Age: 19 Sex: Male | 108 | REJ5787312 | Name : Narasimhaiah.P.S Father's Name: SUBBIAIH House No.:26 Age: 32 Sex: Male |
| 109 | REJ5787072 | Name : Subbaiah Father's Name: LATE.NARAYANAPPA House No.:26 Age: 61 Sex: Male | 110 | REJ5787452 | Name : Balakrishna.S Father's Name: SUBBIAIH House No.:26 Age: 30 Sex: Male | 111 | REJ5787130 | Name : Narayanamma Husband's Name: SUBBIAIH House No.:26 Age: 44 Sex: Female |
| 112 | REJ5787262 | Name : Sunitha.N Husband's Name: NARASIMHAIAH.P.S House No.:26 Age: 28 Sex: Female | 113 | REJ5518014 | Name : Punith H Father's Name: Hiriyanra House No.:26 Age: 20 Sex: Male | 114 | REJ5517925 | Name : Sowmya H Father's Name: Shiva Prasad B K House No.:26 Age: 21 Sex: Female |
| 115 | REJ5836986 | Name : Spandana.V.S Father's Name: SIDDARAMANA GOWDA House No.:26 Age: 20 Sex: Female | 116 | REJ6090021 | Name : Sathisha Father's Name: CHIKKA MARI GOWDA House No.:26 Age: 22 Sex: Male | 117 | REJ5836895 | Name : Mahesh Kumar.G Mother's Name: JAYAMMA House No.:26/1 Age: 26 Sex: Male |
| 118 | REJ5633086 | Name : Kiran.N Mother's Name: LAKSHMI House No.:27 Age: 19 Sex: Male | 119 | REJ5633722 | Name : Naveen Kumar.B.R Father's Name: RAJANNA.K.L House No.:27-28 Age: 23 Sex: Male | 120 | REJ5633623 | Name : Punith Kumar Father's Name: RAJANNA.K.L House No.:27-28 Age: 20 Sex: Male |

Section No.:001)B E M L Layout, , Ward No: 160 -560098 Continued

| | | | | | | | | |
|-----|------------|--|-----|------------|---|-----|------------|---|
| 121 | REJ5633557 | Name : Rajanna.K.L Father's Name: LINGAPPA House No.:27-28 Age: 54 Sex: Male | 122 | REJ5633854 | Name : Sushilamma Husband's Name: RAJANNA.K.L House No.:27-28 Age: 42 Sex: Female | 123 | REJ5633995 | Name : Gadigaiah Hiremat Father's Name: GANGAIAH House No.:28 Age: 31 Sex: Male |
| 124 | REJ5633912 | Name : Basavaraj Hiremat Father's Name: GANGAIAH HEREMAT House No.:28 Age: 35 Sex: Male | 125 | REJ5975727 | Name : Geetha .P Husband's Name: VINAY House No.:28 Age: 23 Sex: Female | 126 | REJ5517818 | Name : Hemalatha K M Husband's Name: Girish C M House No.:29 Age: 31 Sex: Female |
| 127 | REJ5518535 | Name : Janaki Kallapur Husband's Name: RAMACHANDRA House No.:30 Age: 60 Sex: Female | 128 | REJ6176416 | Name : Pallavi.H.V Father's Name: VIJAYA KUMAR.H.R House No.:30 Age: 19 Sex: Female | 129 | REJ6104947 | Name : [Allavi.H.V Father's Name: VIJAYA KUMAR.H.R House No.:30 Age: 19 Sex: Female |
| 130 | REJ5975131 | Name : R.Palanivel Father's Name: V.RAJAGOPAL House No.:30 Age: 30 Sex: Male | 131 | REJ5975834 | Name : P.Amudha Husband's Name: R.PALANIVEL House No.:30 Age: 22 Sex: Female | 132 | REJ6218697 | Name : Sowmya H S Father's Name: SureshRaje Urs House No.:No 30 Age: 25 Sex: Female |
| 133 | REJ5975826 | Name : Shanthamma Husband's Name: NAGARAJU House No.:32 Age: 62 Sex: Female | 134 | REJ5975149 | Name : Nagaraju Father's Name: CHANDALLI MADAPPA House No.:32 Age: 64 Sex: Male | 135 | REJ6160733 | Name : Shanthamma Husband's Name: NAGARAJAPPA.P.C House No.:32 Age: 52 Sex: Female |
| 136 | REJ6177497 | Name : Nagarajappa.P.C Father's Name: CHANDHALLI MADHAPPA House No.:32 Age: 50 Sex: Male | 137 | REJ5975255 | Name : G.V.Gopala Krishna Father's Name: J.VENKATAPATHIAH House No.:33/1 Age: 56 Sex: Male | 138 | REJ5975172 | Name : G.Ramya Kashyap Father's Name: J.V.GOPALA KRISHANA House No.:33/1 Age: 24 Sex: Female |
| 139 | REJ5974985 | Name : N.Nagaraj Father's Name: NAGAIAH House No.:35 Age: 29 Sex: Male | 140 | REJ5975032 | Name : N. Shoba Husband's Name: NAGARAJ.N House No.:35 Age: 24 Sex: Female | 141 | REJ6191365 | Name : Aruna.S Father's Name: SIDDALINGAPPA.S House No.:36 Age: 21 Sex: Male |
| 142 | REJ6120596 | Name : Aruna.S Father's Name: SIDDALINGAPPA.S House No.:36 Age: 21 Sex: Male | 143 | REJ6123723 | Name : Kamakshamma Husband's Name: Devendra House No.:36 37 Age: 34 Sex: Female | 144 | REJ5518097 | Name : Mariyamamma Husband's Name: Huchappa House No.:37 Age: 64 Sex: Female |
| 145 | REJ5517883 | Name : Lakshmi Husband's Name: Thimmasha.H House No.:37 Age: 25 Sex: Female | 146 | REJ5517909 | Name : Shashikala H Husband's Name: Sheshadri House No.:37 Age: 32 Sex: Female | 147 | REJ5876339 | Name : Shyamamma Husband's Name: LATE. KRISHNA MURTHY House No.:37 Age: 66 Sex: Female |
| 148 | REJ5836960 | Name : K.K.Manjunath Father's Name: LATE. K.K.KRISHNA MURTHY House No.:37 Age: 42 Sex: Male | 149 | REJ5836838 | Name : Nagaveni Father's Name: KASHI HEGADE House No.:38 Age: 23 Sex: Female | 150 | REJ5876313 | Name : Vinay Father's Name: NARAYAN House No.:38 Age: 32 Sex: Male |

Section No.:001)B E M L Layout, , Ward No: 160 -560098 Continued

| | | | | | | | | |
|-----|------------|---|-----|------------|---|-----|------------|--|
| 151 | REJ5836911 | Name : Manju Father's Name: KASHI HEGADE House No.:38 Age: 21 Sex: Male | 152 | REJ6193874 | Name : Ranjitha.J Father's Name: G.C.JAVARE GOWDA House No.:40 Age: 19 Sex: Female | 153 | REJ6192181 | Name : Roopa S N Husband's Name: Vishwanath.B.G House No.:40/4 Age: 40 Sex: Female |
| 154 | REJ6101000 | Name : Vishwanath B G Father's Name: Gangadharappa House No.:40/4 Age: 39 Sex: Male | 155 | REJ5517982 | Name : Shwetha M Husband's Name: Nagabhushan P G House No.:40/6 Age: 26 Sex: Female | 156 | REJ5518063 | Name : Nagabhushan P G Father's Name: Easwaranna G P House No.:40/6 Age: 34 Sex: Male |
| 157 | REJ6131056 | Name : T.Basavaraju Father's Name: THONDACHAR.B House No.:41 Age: 52 Sex: Male | 158 | REJ6155337 | Name : Sujatha Husband's Name: T.BASAVARAJU House No.:41 Age: 50 Sex: Female | 159 | REJ6171672 | Name : T.Basavaraju Father's Name: T.THONDACHAR House No.:41 Age: 22 Sex: Male |
| 160 | REJ6033070 | Name : Prajna Hegade Father's Name: VENKATAGIRI House No.:42 Age: 25 Sex: Female | 161 | REJ6038806 | Name : Lavanya Hegade Father's Name: VENKATAGIRI HEGADE House No.:42 Age: 19 Sex: Female | 162 | REJ6056683 | Name : Naveen Dixit Father's Name: DAMIDHAR DIXIT House No.:42 Age: 27 Sex: Male |
| 163 | REJ6093488 | Name : Anasuya Hegade Husband's Name: VENKATAGIRI HEGADE House No.:42 Age: 57 Sex: Female | 164 | REJ6090385 | Name : Prajna Hegade Father's Name: VENKATAGIRI House No.:42 Age: 25 Sex: Female | 165 | REJ6184360 | Name : Venkatagiri Hegade Father's Name: RAMACHANDRA House No.:42 Age: 60 Sex: Male |
| 166 | REJ6095350 | Name : Anasuya Hegade Husband's Name: VENKATAGIRI HEGADE House No.:42 Age: 57 Sex: Female | 167 | REJ5975800 | Name : K.Roopesh Rajput Father's Name: R.KAMALA SINGH House No.:43 Age: 20 Sex: Male | 168 | REJ5517826 | Name : Prasanna Murthy Father's Name: C Channaiah House No.:46 Age: 39 Sex: Male |
| 169 | REJ5518162 | Name : Chandra Shekhar Mother's Name: Gowramma House No.:46 Age: 30 Sex: Male | 170 | REJ5517917 | Name : Shobha H Husband's Name: Prasanna Murthy House No.:46 Age: 34 Sex: Female | 171 | REJ5518212 | Name : Gowramma Husband's Name: C Channaiah House No.:46 Age: 61 Sex: Female |
| 172 | REJ5633532 | Name : Vinaya.S.N.Bhatta Husband's Name: S.N.BHATTA House No.:47/3 Age: 31 Sex: Female | 173 | REJ5975768 | Name : Bhaskara.B.R Father's Name: B.RAMEGOWDA House No.:49 Age: 42 Sex: Male | 174 | REJ5975057 | Name : Bhaskara.B.R Father's Name: B.RAME GOWDA House No.:49 Age: 42 Sex: Male |
| 175 | REJ5975024 | Name : Dhanalakshmi Husband's Name: MANJUNATHA.J House No.:50 Age: 22 Sex: Female | 176 | REJ5836952 | Name : Sunitha Mary Husband's Name: GEORE DAVID.R House No.:50 Age: 27 Sex: Female | 177 | REJ5975016 | Name : Manjunatha.J Father's Name: JAVARANAYAKA House No.:50 Age: 31 Sex: Male |
| 178 | REJ5975222 | Name : Murthy .B.Sunkade Father's Name: BISHTAPPA House No.:50 Age: 34 Sex: Male | 179 | REJ5975248 | Name : Ganagamma.M.Sunkade Husband's Name: MURTHY.B.SUNKADE House No.:50 Age: 25 Sex: Female | 180 | REJ5975628 | Name : Kavitha.R Father's Name: RAJU.B House No.:50 Age: 20 Sex: Female |

Section No.:001)B E M L Layout, , Ward No: 160 -560098 Continued

| | | | | | | | | |
|-----------------|-------------------|-------------|-----------------|-----------------------|-------------|-----------------|-----------------------|-------------|
| 181 | REJ5633144 | | 182 | REJ6079610 | | 183 | REJ5517719 | |
| Name : | Shyam.J | | Name : | Gayathri .B.R | | Name : | D R Vasantha | |
| Father's Name: | JAGANATH.J.M | | Husband's Name: | KISHOR KUMAR.T | | Husband's Name: | S S Mahesh Kumar | |
| House No.: | 57 | | House No.: | 57/1 | | House No.: | 63 | |
| Age: | 20 | Sex: Male | Age: | 29 | Sex: Female | Age: | 34 | Sex: Female |
| 184 | REJ5518147 | | 185 | REJ6218267 | | 186 | REJ6217145 | |
| Name : | S S Mahesha Kumar | | Name : | Ajaykumar Yavagal | | Name : | Suvarna Yavagal | |
| Father's Name: | Shambhulingayya | | Mother's Name: | Suvarna Yavagal | | Husband's Name: | Pralhad Yavagal | |
| House No.: | 63 | | House No.: | Door No 64, Shri Hari | | House No.: | Door No 64, Shri Hari | |
| Age: | 41 | Sex: Male | Age: | 29 | Sex: Male | Age: | 58 | Sex: Female |
| 187 | REJ5633466 | | 188 | REJ6095715 | | 189 | REJ5518436 | |
| Name : | Poornima | | Name : | Raghavendra.N | | Name : | Sumithamma | |
| Husband's Name: | SHIVANNA.H.C | | Father's Name: | NARASIMHA MURTHY | | Father's Name: | SHIVANNA | |
| House No.: | 65 | | House No.: | 65 | | House No.: | 70 | |
| Age: | 34 | Sex: Female | Age: | 69 | Sex: Male | Age: | 46 | Sex: Female |
| 190 | REJ5518345 | | 191 | REJ5787197 | | 192 | REJ5633763 | |
| Name : | Vijay Kumar. K.S | | Name : | Shambulingaiah | | Name : | Abhishek .K.S | |
| Father's Name: | SHAMBHULINGAIAH | | Father's Name: | KENCHEGOWDA | | Father's Name: | SIDDARAMU | |
| House No.: | 70 | | House No.: | 70 | | House No.: | 72 | |
| Age: | 29 | Sex: Male | Age: | 56 | Sex: Male | Age: | 24 | Sex: Male |
| 193 | REJ5836796 | | 194 | REJ5634167 | | 195 | REJ5633987 | |
| Name : | Siddaraju | | Name : | J.Srikanth | | Name : | Shanthamma | |
| Father's Name: | GANGAIAH | | Father's Name: | JAYARAMA.T | | Husband's Name: | JAYARAMA.T | |
| House No.: | 72/3 | | House No.: | 72/10 | | House No.: | 72/10 | |
| Age: | 19 | Sex: Male | Age: | 22 | Sex: Male | Age: | 40 | Sex: Female |
| 196 | REJ5634035 | | 197 | REJ5634027 | | 198 | REJ6085690 | |
| Name : | T.Jayarama | | Name : | J.Lakshmi | | Name : | Shivaprasad B.K | |
| Father's Name: | THAMMEGOWDA | | Father's Name: | JAYARAMA.T | | Father's Name: | KUMAR.B.A | |
| House No.: | 72/10 | | House No.: | 72/10 | | House No.: | 72/26 | |
| Age: | 47 | Sex: Male | Age: | 19 | Sex: Female | Age: | 31 | Sex: Male |
| 199 | REJ5876347 | | 200 | REJ5876305 | | 201 | REJ5600267 | |
| Name : | Rudresh.N | | Name : | Shashikala.S | | Name : | Darshan.S.E | |
| Father's Name: | NARASIMHAIH | | Husband's Name: | NARAYANA.N | | Father's Name: | ERE GOWDA | |
| House No.: | 73 | | House No.: | 73 | | House No.: | 73/112 | |
| Age: | 25 | Sex: Male | Age: | 20 | Sex: Female | Age: | 27 | Sex: Male |
| 202 | REJ5518360 | | 203 | REJ5599931 | | 204 | REJ5518469 | |
| Name : | Ananda.K.S | | Name : | S.M.Ere Gowda | | Name : | Sunanda | |
| Father's Name: | KALABORE GOWDA | | Father's Name: | LATE.MARIGOWDA | | Husband's Name: | S.M.ERE GOWDA | |
| House No.: | 73/112 | | House No.: | 73/112 | | House No.: | 73/112 | |
| Age: | 32 | Sex: Male | Age: | 58 | Sex: Male | Age: | 44 | Sex: Female |
| 205 | REJ5518519 | | 206 | REJ6078810 | | 207 | REJ6040893 | |
| Name : | S.E.Lohith | | Name : | Mahadeva.K | | Name : | Deegowda.P | |
| Father's Name: | S.M.ERE GOWDA | | Father's Name: | KENCHAPPA | | Father's Name: | DEVEGOWDA | |
| House No.: | 73/112 | | House No.: | 73/115 | | House No.: | 73/115 | |
| Age: | 26 | Sex: Male | Age: | 39 | Sex: Male | Age: | 63 | Sex: Male |
| 208 | REJ6035158 | | 209 | REJ5517842 | | 210 | REJ5518196 | |
| Name : | Sowmya Mahadeva | | Name : | Apoorva .R | | Name : | Akihila.R | |
| Husband's Name: | MAHADEVA | | Father's Name: | RAMA MOGERA | | Father's Name: | RAMA MOGERA | |
| House No.: | 73/115 | | House No.: | 75/2 | | House No.: | 75/2 | |
| Age: | 23 | Sex: Female | Age: | 19 | Sex: Female | Age: | 25 | Sex: Female |

Section No.:001)B E M L Layout, , Ward No: 160 -560098 Continued

| | | | | | | | | |
|-----|------------|---|-----|------------|--|-----|------------|--|
| 211 | REJ5518121 | Name : Rama Mogera Father's Name: SADIYA MOGERA House No.:75/2 Age: 57 Sex: Male | 212 | REJ5799853 | Name : Prabhavathi Husband's Name: RAMA MOGERA House No.:75/2 Age: 52 Sex: Female | 213 | REJ6169296 | Name : Chandrakala K.S Father's Name: Shivanna House No.:75/2 Age: 19 Sex: Female |
| 214 | REJ5634084 | Name : M.Darshan Father's Name: MADAN KUMAR.H.N House No.:76/2 Age: 23 Sex: Male | 215 | REJ6002422 | Name : S.Gayathri Husband's Name: N.VENKATARAMANA House No.:77 Age: 56 Sex: Female | 216 | REJ6103063 | Name : Savitha Husband's Name: Venugopal House No.:79 Age: 26 Sex: Female |
| 217 | REJ5836812 | Name : Bhagyamma Husband's Name: T.K.KUMARA House No.:81 Age: 35 Sex: Female | 218 | REJ5836929 | Name : Avinash.T.K Father's Name: T.K.KUMARA House No.:81 Age: 21 Sex: Male | 219 | REJ5836978 | Name : T.K.Kumara Father's Name: CHALUVIAIAH House No.:81 Age: 42 Sex: Male |
| 220 | REJ6089833 | Name : Shashi Kumar.C Father's Name: CHOWDAPPA House No.:84 Age: 23 Sex: Male | 221 | REJ6038194 | Name : Shashi Kumar.C Father's Name: CHOWDAPPA House No.:84 Age: 23 Sex: Male | 222 | REJ5633797 | Name : M.Jagadish Rao Father's Name: N.MUKUNDA RAO House No.:85 Age: 22 Sex: Male |
| 223 | REJ6060966 | Name : N.Mukunda Rao Father's Name: LATE.NARASINGA RAO House No.:85 Age: 51 Sex: Male | 224 | REJ6074272 | Name : Chandra Bayi Husband's Name: N.MUKUNDA RAO House No.:85 Age: 46 Sex: Female | 225 | REJ6076731 | Name : Chandra Bayi Husband's Name: N.MUKUNDA RAO House No.:85 Age: 46 Sex: Female |
| 226 | REJ5975073 | Name : Ramya Narayana Murthy Husband's Name: NARAYANA MURTHY.M.K House No.:86 Age: 25 Sex: Female | 227 | REJ5836846 | Name : Narayana Murthy.K Father's Name: KAMBE GOWDA House No.:86 Age: 32 Sex: Male | 228 | REJ5975743 | Name : Narayana .M.K Father's Name: KAMBEGOWDA.K House No.:86 Age: 32 Sex: Male |
| 229 | REJ6218853 | Name : Vinaya Shruthi B Father's Name: BALAKRISHNAN S House No.:NO 86 1ST E MAIN Age: 49 Sex: Female | 230 | REJ5517859 | Name : Papanna N Father's Name: Nanje gowda House No.:94 Age: 49 Sex: Male | 231 | REJ5517800 | Name : K C Kamalamma Husband's Name: Papanna N House No.:94 Age: 49 Sex: Female |
| 232 | REJ5975164 | Name : Geetha.A.K Husband's Name: V.RAMACHANDRA House No.:94 Age: 34 Sex: Female | 233 | REJ5975511 | Name : V.Ramachandra Mother's Name: PARVATHI House No.:94 Age: 38 Sex: Male | 234 | REJ5975859 | Name : V.Ramachandra Mother's Name: PARVATHI House No.:94 Age: 38 Sex: Male |
| 235 | REJ5876297 | Name : Nagamani Husband's Name: VEERABADRA House No.:94 Age: 38 Sex: Female | 236 | REJ5828934 | Name : Mallika K Murthy Husband's Name: Krishnamurthy.M.S House No.:96 Age: 56 Sex: Female | 237 | REJ5828900 | Name : Krishnamurthy.M.S Father's Name: suryanarayana Rao House No.:96 Age: 64 Sex: Male |
| 238 | REJ6089007 | Name : C.Kavya Father's Name: N.CHANDRASHEKAR House No.:99 Age: 19 Sex: Female | 239 | REJ5518378 | Name : Raghavendra Harsoor Father's Name: VENKATESH HARSOOR House No.:B-102 Age: 32 Sex: Male | 240 | REJ5518493 | Name : Bhargavi Harsoor Husband's Name: RAGHAVENDRA HARSOOR House No.:B-102 Age: 27 Sex: Female |

Section No.:001)B E M L Layout, , Ward No: 160 -560098 Continued

| | | | | | | | | |
|-----|------------|---|-----|------------|---|-----|------------|---|
| 241 | REJ5633243 | Name : Anthoni Mykal Father's Name: JANI MYKAL House No.:B-108 Age: 33 Sex: Male | 242 | REJ6104079 | Name : Smruthi.M Father's Name: R.MURALI MOHAN House No.:103 Age: 19 Sex: Female | 243 | REJ5633268 | Name : Lohith Kumar.A Mother's Name: ANNAPURNA ASHOK House No.:106 Age: 33 Sex: Male |
| 244 | REJ5975065 | Name : Mahalakshmi .T Father's Name: THAMANNA.R House No.:106/73 Age: 19 Sex: Female | 245 | REJ5975180 | Name : Thamanna.R Father's Name: RAME GOWDA House No.:106/73 Age: 46 Sex: Male | 246 | REJ5975818 | Name : Uma Husband's Name: THAMANNA.R House No.:106/73 Age: 37 Sex: Female |
| 247 | REJ6177109 | Name : Ramachandra Father's Name: LATE.BALLAPPA House No.:107 Age: 47 Sex: Male | 248 | REJ6195960 | Name : Sunita Husband's Name: RAMACHANDRA House No.:107 Age: 36 Sex: Female | 249 | REJ5975883 | Name : Kristina Anthoni Husband's Name: ANTHONI MAICAL House No.:108 Age: 33 Sex: Female |
| 250 | REJ5975040 | Name : Anthoni Maikal Father's Name: ANTHONI MAIKAL House No.:108 Age: 33 Sex: Male | 251 | REJ5633318 | Name : Christina Anthony Husband's Name: M.ANTHONY House No.:B-108 Age: 33 Sex: Female | 252 | REJ5633227 | Name : Nagashree.R.G Husband's Name: JAGADISH.A.R House No.:B-110 Age: 26 Sex: Female |
| 253 | REJ5633359 | Name : Jagadish.A.R Father's Name: A.RAMAKRISHNA House No.:B-110 Age: 22 Sex: Male | 254 | REJ5633391 | Name : Prabha.V.L Husband's Name: LAKSHMINARAYANA. V.S House No.:A-113 Age: 58 Sex: Female | 255 | REJ5633177 | Name : Namitha.V.L Father's Name: LAKSHMINARAYANA. V.S House No.:A-113 Age: 39 Sex: Female |
| 256 | REJ5633334 | Name : Lakshmi Narayana.V.S Father's Name: SHANKAR NARAYANA.V.L House No.:A-113 Age: 59 Sex: Male | 257 | REJ6094643 | Name : Nagaraju.K Father's Name: KENCHAPPA House No.:115 Age: 34 Sex: Male | 258 | REJ5518329 | Name : Divya Rupha.K Father's Name: KANAGASUNDARAM GANESHAN House No.:119 Age: 27 Sex: Female |
| 259 | REJ5975784 | Name : Bindhu.M Father's Name: N.MURALIDHARA House No.:133/73 Age: 19 Sex: Female | 260 | REJ5633375 | Name : Sushma Jaqueline Husband's Name: RICHARD PHILLIPS House No.:135/136 Age: 29 Sex: Female | 261 | REJ5799895 | Name : Puttathayamma.R Husband's Name: ANANDA BABU.G.A House No.:135/136-A Age: 42 Sex: Female |
| 262 | REJ5813167 | Name : A.Sumathi Husband's Name: R.ARMUGAM House No.:136/137 Age: 39 Sex: Female | 263 | REJ6002463 | Name : Sagayanashan Moses Father's Name: LATE.MYCHEL House No.:169 Age: 49 Sex: Male | 264 | REJ6002455 | Name : Mary Husband's Name: MOSES House No.:169 Age: 43 Sex: Female |
| 265 | REJ6120406 | Name : Basavaiah Father's Name: KUNTAIAH House No.:173/4 Age: 22 Sex: Male | 266 | REJ6197149 | Name : Basavaiah Father's Name: KUNTAIAH House No.:173/4 Age: 41 Sex: Male | 267 | REJ6161459 | Name : Basavaiah Father's Name: KUNTAIAH House No.:173/4 Age: 41 Sex: Male |
| 268 | REJ6180723 | Name : Basavaiah Father's Name: KUNTAIAH House No.:173/4 Age: 41 Sex: Male | 269 | REJ5633946 | Name : Veerabadra Father's Name: MURUGESH House No.:186/8 Age: 23 Sex: Male | 270 | REJ5634050 | Name : Venkatesh.V Father's Name: C.VENKATA SWAMY House No.:189/11 Age: 34 Sex: Male |

Section No.:001)B E M L Layout, , Ward No: 160 -560098 Continued

| | | | | | | | | |
|-----|------------|--|-----|------------|---|-----|------------|--|
| 271 | REJ5517784 | Name : Rajani.T Husband's Name: SATEESH.M.K House No.:199 Age: 36 Sex: Female | 272 | REJ5518139 | Name : Sateesh.M.K Father's Name: KAMALAKAR.B House No.:199 Age: 44 Sex: Male | 273 | REJ5518550 | Name : Krishna Murthy.G.S Father's Name: SESHAGIRI RAO.S House No.:202 Age: 39 Sex: Male |
| 274 | REJ5518394 | Name : Shreelakshmi .S Husband's Name: KRISHNA MURTHY.G.S House No.:202 Age: 39 Sex: Female | 275 | REJ5634209 | Name : Chaya Kulkarni Husband's Name: KASHINATHA KULKARNI House No.:203 Age: 53 Sex: Female | 276 | REJ5799879 | Name : Srimathi Chaya Kulkarni Husband's Name: KASHINATH KULKARNI House No.:B-203 Age: 53 Sex: Female |
| 277 | REJ5599642 | Name : Shri Sushrutha Kulkarni Father's Name: KASHINATHA KULKARNI House No.:B-203 Age: 32 Sex: Male | 278 | REJ5518402 | Name : Kashinatha Kulkarni Father's Name: BHIMASENA RAO KULKARNI House No.:B-203 Age: 62 Sex: Male | 279 | REJ5518568 | Name : Karthik Kulkarni Father's Name: KASHINATHA KULKARNI House No.:b-203 Age: 20 Sex: Male |
| 280 | REJ5600051 | Name : Srimathi Chandrayi Chakravarthi SUSHRUTHA KULKARNI House No.:B-203 Age: 33 Sex: Female | 281 | REJ5517974 | Name : Soumya C W Father's Name: Chidambar Rav House No.:204 Age: 20 Sex: Female | 282 | REJ5518592 | Name : Banumathi Sridharan Husband's Name: SRIDHARAN House No.:207 Age: 54 Sex: Female |
| 283 | REJ5599683 | Name : Saish Sridharan Father's Name: SRIDHARAN House No.:B-207 Age: 25 Sex: Male | 284 | REJ5518337 | Name : R.Sridharan Rajagopalan RAJA GOPALAN House No.:B-207 Age: 57 Sex: Male | 285 | REJ5518444 | Name : Chithra Husband's Name: K.NATARAJAN House No.:B-209 Age: 36 Sex: Female |
| 286 | REJ5518485 | Name : Natarajan Father's Name: R.M.KRISHNA MURTHY House No.:B-209 Age: 44 Sex: Male | 287 | REJ5800644 | Name : Chinthamani Husband's Name: LATE.S.SATHYIAH House No.:B-209 Age: 79 Sex: Female | 288 | REJ5599758 | Name : Rajashri Shivamagepa Salotagi SHIVAYOGEPPA SALOTAGI House No.:213 Age: 34 Sex: Female |
| 289 | REJ5599998 | Name : Shivayogeppa Salotagi Father's Name: BASAGONDAPPA SALOTAGI House No.:213 Age: 39 Sex: Male | 290 | REJ5632880 | Name : H.D.R.Prasanna Father's Name: LATE.H.R.DAKSHINA MURTHY House No.:214 Age: 66 Sex: Male | 291 | REJ5518451 | Name : Vani Prasanna Father's Name: H.D.RUDRA PRASANNA House No.:214 Age: 35 Sex: Female |
| 292 | REJ5518527 | Name : Manju Prasanna Husband's Name: H.D.RUDRA PRASANNA House No.:214 Age: 55 Sex: Female | 293 | REJ6132732 | Name : Gouri Mani Jena Husband's Name: Subhash Chandra Jena House No.:214 Age: 31 Sex: Female | 294 | REJ5633151 | Name : Debabrata Ghosh Father's Name: SANJOY GHOSH House No.:215 Age: 21 Sex: Male |
| 295 | REJ5633201 | Name : Saraswati Ghosh Husband's Name: DEBABRATA GHOSH House No.:215 Age: 39 Sex: Female | 296 | REJ5799861 | Name : Munmun Ghosh Husband's Name: SUBRATA GHOSH House No.:220 A Age: 36 Sex: Female | 297 | REJ5599592 | Name : Subrata Ghosh Father's Name: SUBHAS CHANDRA GHOSH House No.:220 A Age: 41 Sex: Male |
| 298 | REJ5836903 | Name : Sanjiv Ghosh Father's Name: LATE.SUBHASH CHANDRA GHOSH House No.:220A Age: 39 Sex: Male | 299 | REJ5518600 | Name : Suma Ramanna Husband's Name: ANIL NAGARAGATTA House No.:281 Age: 38 Sex: Female | 300 | REJ5975347 | Name : Chandran Umapathi Father's Name: V.CHANDRAN House No.:281 Age: 41 Sex: Male |

Section No.:001)B E M L Layout, , Ward No: 160 -560098 Continued

| | | | | | | | | |
|-----|------------|--|-----|------------|--|-----|------------|---|
| 301 | REJ5975198 | Name : Shashikala Umapathi Husband's Name: UMAPATHI House No.:281 Age: 36 Sex: Female | 302 | REJ5975750 | Name : Gayathri Husband's Name: GOVINDA RAJAN House No.:281-B Age: 26 Sex: Female | 303 | REJ5975776 | Name : Govindarajan Subramanian SUBRAMANIAN Father's Name: House No.:281-B Age: 29 Sex: Male |
| 304 | REJ6078992 | Name : Sagar.K Father's Name: KRISHNA KUMAR.S House No.:287/2 Age: 20 Sex: Male | 305 | REJ5813183 | Name : Subhashis Mandal Father's Name: BIMAL MANDAL House No.:301 Age: 43 Sex: Male | 306 | REJ5518584 | Name : M.Beulah Husband's Name: M.D.Y.YESWANTH KUMAR House No.:304 Age: 31 Sex: Female |
| 307 | REJ5518352 | Name : M.D.Y.Yeswanth Kumar Father's Name: M.P.DAIVADHEENAM House No.:304 Age: 27 Sex: Male | 308 | REJ6033203 | Name : Shailaja Kori Husband's Name: RAVINDRANATH KORI House No.:306 Age: 23 Sex: Female | 309 | REJ6071948 | Name : Shailaja Kori Husband's Name: RAVINDRANATH KORI House No.:306 Age: 30 Sex: Female |
| 310 | REJ6061980 | Name : Ravindranath Kori Father's Name: SHANKARAPPA KORI House No.:306 Age: 65 Sex: Male | 311 | REJ6090690 | Name : Ravindranath Kori Father's Name: SHANKARAPPA KORI House No.:306 Age: 23 Sex: Male | 312 | REJ6087613 | Name : Vani Kori Father's Name: RAVINDRANATH KORI House No.:306 Age: 32 Sex: Female |
| 313 | REJ5518303 | Name : Anand Jatti Mother's Name: KASTURA BAI House No.:B-306 Age: 39 Sex: Male | 314 | REJ5518543 | Name : Jyoti Kori Husband's Name: ANAND JATTI House No.:B-306 Age: 34 Sex: Female | 315 | REJ5517768 | Name : Nagaraja M L Father's Name: Lakshminarayanappa House No.:309 Age: 52 Sex: Male |
| 316 | REJ5975867 | Name : Maithra Nagaraja Husband's Name: M.L.NAGARAJA House No.:309 Age: 48 Sex: Female | 317 | REJ5975842 | Name : Sumuk.M.N Father's Name: NAGARAJA.M.L House No.:309 Age: 19 Sex: Male | 318 | REJ5787551 | Name : Raghavendra Bhat Father's Name: Krishna Murthy Bhat House No.:S F 310 Age: 36 Sex: Male |
| 319 | REJ5517727 | Name : Lalitha Husband's Name: Late Gopalakrishna T K House No.:SF 310 Age: 56 Sex: Female | 320 | REJ5517750 | Name : T G Nagaveni Husband's Name: Raghavendra Bhat House No.:SF 310 Age: 29 Sex: Female | 321 | REJ5518261 | Name : Betsy Varghese Husband's Name: NARANAM MOOZHYY House No.:311 Age: 31 Sex: Female |
| 322 | REJ5632864 | Name : Jaison Philip Chacko Father's Name: K.C.CHACKO House No.:311 Age: 37 Sex: Male | 323 | REJ5599667 | Name : Anandteerth Shirhatti Father's Name: VASUDEO SHIRHATTI House No.:312 Age: 38 Sex: Male | 324 | REJ5518410 | Name : Jaya Shirhatti Husband's Name: ANANDTEERTH SHIRHATTI House No.:312 Age: 32 Sex: Female |
| 325 | REJ5518618 | Name : Srilatha.B Husband's Name: SRIKANTH.B House No.:319 Age: 27 Sex: Female | 326 | REJ5633029 | Name : Srikanth Booria Father's Name: MALLESHAM BOORIA House No.:319 A Age: 31 Sex: Male | 327 | REJ6068878 | Name : Narendra Babu M Father's Name: A MURUGAN House No.:339 Age: 35 Sex: Male |
| 328 | REJ5633706 | Name : Sajida Banu Husband's Name: MOHAMMED ABDUL SALAM House No.:345 Age: 50 Sex: Female | 329 | REJ6218465 | Name : Ruchira Dilip Rao Husband's Name: SUDEEP RANGANATH GOPAL House No.:No. 371 "Vaishnavi" Age: 30 Sex: Female | 330 | REJ6218234 | Name : Praveen Satyanarayana Father's Name: Satyanarayana Venkatarama Shastry House No.:#375, GF-4 Age: 30 Sex: Male |

Section No.:001)B E M L Layout, , Ward No: 160 -560098 Continued

| | | | | | | | | |
|-----------------|-------------------------|-------------|----------------|-------------------------------|-------------|-----------------|------------------------|-------------|
| 331 | REJ6152524 | | 332 | REJ5518477 | | 333 | REJ5518501 | |
| Name : | Narasimhan .N | | Name : | Sreehari.S | | Name : | Manjula .R | |
| Father's Name: | LATE.RAGHAVACHAR | | Father's Name: | M.SUDHAKARAN NAIR | | Husband's Name: | SREEHARI.S | |
| House No.: | 380 | | House No.: | 405 | | House No.: | 405 | |
| Age: | 20 | Sex: Male | Age: | 40 | Sex: Male | Age: | 33 | Sex: Female |
| 334 | REJ5634126 | | 335 | REJ5634142 | | 336 | REJ5634134 | |
| Name : | Sudhakar Pai.U | | Name : | Sunil Pai.U | | Name : | Shree Lakshmi Nayak | |
| Father's Name: | SRINIVAS PAI.U | | Father's Name: | SUDHAKAR PAI.U | | Husband's Name: | SUNIL PAI.U | |
| House No.: | 410 | | House No.: | 410 | | House No.: | 410 | |
| Age: | 73 | Sex: Male | Age: | 33 | Sex: Male | Age: | 27 | Sex: Female |
| 337 | REJ5634118 | | 338 | REJ5975156 | | 339 | REJ5975537 | |
| Name : | Ratna.S Pai | | Name : | Santhosh.V Suryavanshi | | Name : | Nimesha.S | |
| Husband's Name: | SUDHAKAR.U PAI | | Father's Name: | VISHWANATH RAO SURYAVANSHI | | Husband's Name: | SANTHOSH.V | |
| House No.: | 410 | | House No.: | A-411 | | House No.: | A-411 | |
| Age: | 64 | Sex: Female | Age: | 38 | Sex: Male | Age: | 37 | Sex: Female |
| 340 | REJ5599626 | | 341 | REJ5599832 | | 342 | REJ5599907 | |
| Name : | Poornima.T.H | | Name : | Deepak Kumar Payeng | | Name : | Dimmi Payeng | |
| Husband's Name: | MALLIKARJUNA VASANAD | | Father's Name: | SASHIDHAR PAYENG | | Husband's Name: | DEEPAK KUMAR PAYENG | |
| House No.: | 413 | | House No.: | 417 | | House No.: | 417 | |
| Age: | 35 | Sex: Female | Age: | 40 | Sex: Male | Age: | 33 | Sex: Female |
| 343 | REJ5800651 | | 344 | REJ5800636 | | 345 | REJ5975230 | |
| Name : | Shwetha.J.Pai | | Name : | K.Janardhana Pai | | Name : | Kattimani .R.S | |
| Husband's Name: | K.JANARDHANA PAI | | Father's Name: | K.ANANTHA PAI | | Father's Name: | KATTIMANI.R.S | |
| House No.: | 419 A | | House No.: | 419 A | | House No.: | 419/B | |
| Age: | 31 | Sex: Female | Age: | 40 | Sex: Male | Age: | 55 | Sex: Male |
| 346 | REJ5518428 | | 347 | REJ5518311 | | 348 | REJ5599881 | |
| Name : | Akshay.R.K | | Name : | R.S.Kattimani | | Name : | Chandrakala.R.K | |
| Father's Name: | R.S.KATTIMANI | | Father's Name: | S.G.KATTIMANI | | Husband's Name: | R.S.KATTIMANI | |
| House No.: | A-419 B | | House No.: | A-419 B | | House No.: | A-419 B | |
| Age: | 21 | Sex: Male | Age: | 55 | Sex: Male | Age: | 49 | Sex: Female |
| 349 | REJ5517966 | | 350 | REJ5633870 | | 351 | REJ5633888 | |
| Name : | Duleep Saurab S | | Name : | Bharath.S.S | | Name : | Shreekala.G.C | |
| Father's Name: | T Shivakumar | | Father's Name: | SHIVA SWAMY.H.S | | Husband's Name: | BHARATH.S.S | |
| House No.: | 474 | | House No.: | 515 | | House No.: | 515 | |
| Age: | 20 | Sex: Male | Age: | 32 | Sex: Male | Age: | 26 | Sex: Female |
| 352 | REJ5813191 | | 353 | REJ5518055 | | 354 | REJ5632922 | |
| Name : | Allan Richard Gunjal | | Name : | Shashidhara | | Name : | Vijaya.K.Gowda | |
| Father's Name: | JEMS GUNJAL | | Father's Name: | Krishnaiah | | Husband's Name: | K.N.KRISHNE GOWDA | |
| House No.: | 575 | | House No.: | 594 | | House No.: | 714 | |
| Age: | 27 | Sex: Male | Age: | 58 | Sex: Male | Age: | 57 | Sex: Female |
| 355 | REJ5518386 | | 356 | REJ5975370 | | 357 | REJ6114102 | |
| Name : | K.N.Krishne Gowda | | Name : | Kanthamma | | Name : | Sanjana Patanari | |
| Father's Name: | LATE.NARASIMHE GOWDA | | Father's Name: | VENKATESHI | | Husband's Name: | SUPRASH PATANARI | |
| House No.: | 714 | | House No.: | 912 | | House No.: | 917 | |
| Age: | 64 | Sex: Male | Age: | 37 | Sex: Female | Age: | 68 | Sex: Female |
| 358 | REJ5633292 | | 359 | REJ5600101 | | 360 | REJ5600028 | |
| Name : | R.Hemavathy | | Name : | Biswas Nagar | | Name : | K.R.Prasad | |
| Husband's Name: | H.SUNIL | | Father's Name: | K.R.PRASAD | | Father's Name: | N.S.KRISHNA MURTHY | |
| House No.: | 934 | | House No.: | 945 | | House No.: | 945 | |
| Age: | 33 | Sex: Female | Age: | 33 | Sex: Male | Age: | 68 | Sex: Male |

Section No.:001)B E M L Layout, , Ward No: 160 -560098 Continued

| | | | | | | | | |
|-----------------|-----------------|-------------|-----------------|-----------------|-------------|-----------------|------------------|-------------|
| 361 | REJ5632963 | | # 362 | REJ5633045 | | 363 | REJ5600218 | |
| Name : | Shantha Prasad | | Name : | D.Chowdaiah | | Name : | Prakash Babu.H.V | |
| Husband's Name: | K.R.PRASAD | | Father's Name: | LATE.DEVARAIAH | | Father's Name: | VEERABHADRAPPA.T | |
| House No.: | 945 | | House No.: | 945 | | House No.: | 1036 | |
| Age: | 65 | Sex: Female | Age: | 101 | Sex: Male | Age: | 57 | Sex: Male |
| 364 | REJ5633110 | | 365 | REJ5518030 | | 366 | REJ5518188 | |
| Name : | Leelavathy.R | | Name : | S Keshavamurthy | | Name : | S K V Sunandamma | |
| Husband's Name: | PRAKASH BABU.V | | Father's Name: | Late Rangayya | | Husband's Name: | S Keshava murthy | |
| House No.: | 1036 | | House No.: | 1183 | | House No.: | 1183 | |
| Age: | 53 | Sex: Female | Age: | 74 | Sex: Male | Age: | 75 | Sex: Female |
| 367 | REJ5518006 | | 368 | REJ5517875 | | 369 | REJ5599808 | |
| Name : | H K Hari | | Name : | P Hemamala | | Name : | Jaya Ram.N | |
| Father's Name: | S Keshavamurthy | | Husband's Name: | H K Hari | | Father's Name: | H.B.NARASIMHAIAH | |
| House No.: | 1183 | | House No.: | 1183 | | House No.: | 1190 | |
| Age: | 48 | Sex: Male | Age: | 39 | Sex: Female | Age: | 63 | Sex: Male |
| 370 | REJ5518089 | | 371 | REJ5518022 | | 372 | REJ5518170 | |
| Name : | B.J.Sandeep | | Name : | Shobha B C | | Name : | Sudharani C | |
| Father's Name: | N.JAYARAM | | Husband's Name: | P C Maruthi | | Husband's Name: | Yogesh P | |
| House No.: | 1190 | | House No.: | 1324 | | House No.: | 1336 | |
| Age: | 29 | Sex: Male | Age: | 31 | Sex: Female | Age: | 21 | Sex: Female |
| 373 | REJ5517776 | | 374 | REJ5518204 | | 375 | REJ5518238 | |
| Name : | Divya M | | Name : | Yogesh P | | Name : | Puttaswamy | |
| Husband's Name: | Jagadisha P | | Father's Name: | PUttaswamy J | | Father's Name: | Javaregowda | |
| House No.: | 1336 | | House No.: | 1336 | | House No.: | 1336 | |
| Age: | 20 | Sex: Female | Age: | 26 | Sex: Male | Age: | 61 | Sex: Male |
| 376 | REJ5518253 | | 377 | REJ5518113 | | 378 | REJ5518048 | |
| Name : | Shailaja | | Name : | Jagadisha P | | Name : | Sumithra | |
| Father's Name: | Puttaswamy | | Father's Name: | Puttaswamy J | | Husband's Name: | Puttaswamy J | |
| House No.: | 1336 | | House No.: | 1336 | | House No.: | 1336 | |
| Age: | 26 | Sex: Female | Age: | 24 | Sex: Male | Age: | 46 | Sex: Female |
| 379 | REJ5945472 | | 380 | REJ6134860 | | | | |
| Name : | Pragash Kumar | | Name : | Kamakshamma | | | | |
| Father's Name: | Adinarayanan | | Husband's Name: | Devendra | | | | |
| House No.: | 1634 | | House No.: | 36,37 | | | | |
| Age: | 32 | Sex: Male | Age: | 51 | Sex: Female | | | |

Section No.:002)Gattigere Gram tana Gattigere Revenu, , Ward No: 160 -560098 Continued

| | | | | | | | | |
|-----|------------|---|-----|------------|--|-----|------------|---|
| 381 | REJ5633961 | Name : Manjula.K Father's Name: K.R.KRISHNAPPA House No.:01 Age: 36 Sex: Female | 382 | REJ0584367 | Name : Bhanumathi.B.S Husband's Name: RAMAMURTHY.R House No.:2/A Age: 37 Sex: Female | 383 | REJ0584995 | Name : Sumanlatha.L Father's Name: Lokeshappa House No.:12 Age: 26 Sex: Female |
| 384 | REJ5634100 | Name : Ravi Kumar.B.S Father's Name: BORAIHAH.C House No.:12 Age: 47 Sex: Male | 385 | REJ5787387 | Name : Yoganarasimha Murthy.E.R RAJANNA House No.:12/7 Age: 29 Sex: Male | 386 | REJ5633979 | Name : Thejas Kumar.S Father's Name: SOMASHEKARAPPA.P House No.:13 Age: 19 Sex: Male |
| 387 | REJ5634001 | Name : Kavitha.S Father's Name: M.V.SUDARSHAN House No.:13/1 Age: 20 Sex: Female | 388 | REJ5633862 | Name : Rama Bai Father's Name: LATE. MUKUNDA RAO POLE House No.:15 Age: 62 Sex: Female | 389 | REJ6034532 | Name : Shyam A Nair Father's Name: Ashok Kumar V House No.:#17, Kamadhenu, Age: 21 Sex: Male |
| 390 | REJ5633482 | Name : Meghana.V.R Father's Name: RAMESH.V.S House No.:23 Age: 21 Sex: Female | 391 | REJ3642055 | Name : Rajendra.M.Pundi Father's Name: P.MALLAPPA House No.:23/72 Age: 49 Sex: Male | 392 | REJ3642063 | Name : Kotramma.H Kavya.H Husband's Name: Rajendra Vundi House No.:23/72 Age: 43 Sex: Female |
| 393 | REJ6079248 | Name : Chaitra Husband's Name: Basavaraju SP House No.:32 Age: 28 Sex: Female | 394 | REJ6081756 | Name : Basavaraju Sp Father's Name: PArameswarappa B House No.:32 Age: 33 Sex: Male | 395 | REJ5633813 | Name : Radha.V Husband's Name: CHANDRASHEKAR.N House No.:35 Age: 23 Sex: Female |
| 396 | REJ5633524 | Name : B.G.Ravichandra Father's Name: B.H.GOPALAKRISHNA HEBBER House No.:41 Age: 29 Sex: Male | 397 | REJ6054464 | Name : Prajna Hegde Father's Name: Venkatagiri Hegde House No.:#42 Age: 25 Sex: Female | 398 | REJ6078620 | Name : Anasuya Hegde Husband's Name: Venkatagiri Hegde House No.:#42 Age: 57 Sex: Female |
| 399 | REJ6092696 | Name : Naveen Dixit Father's Name: Damodhar Dixit House No.:#42 Age: 27 Sex: Male | 400 | REJ6093272 | Name : Lavanya Hegde Father's Name: Venkatagiri Hegde House No.:#42 Age: 19 Sex: Female | 401 | REJ6062517 | Name : R Venkatagiri Hegde Father's Name: Ramachandra House No.:#42 Age: 60 Sex: Male |
| 402 | REJ5633615 | Name : Bhatta.S.N Suryanarayana Bhatta SHANKARA NARAYANA BHATTA House No.:47/3 Age: 45 Sex: Male | 403 | REJ3643897 | Name : Girijamma Husband's Name: Chidanandaswamy House No.:54 Age: 81 Sex: Female | 404 | REJ1201060 | Name : Basamma Husband's Name: Basavaraju House No.:E-54/1/7 Age: 62 Sex: Female |
| 405 | REJ0590299 | Name : Shivakumar D. B. Father's Name: Basavaraju House No.:E-54/1/7 Age: 38 Sex: Male | 406 | MBQ7033988 | Name : Prabhakara S Father's Name: Shivanna House No.:E-56 Age: 41 Sex: Male | 407 | REJ0756403 | Name : Shivakumar Father's Name: GURUSWAMY House No.:E-56 Age: 37 Sex: Male |
| 408 | REJ0588772 | Name : Vishwanatha G Hirimuth Guruswamy House No.:E-56 Age: 34 Sex: Male | 409 | REJ0756395 | Name : Jyothi S Hiremutt Husband's Name: Shivakumar House No.:E-56 Age: 32 Sex: Female | 410 | REJ1051275 | Name : Kumara B. Father's Name: Basavaraju D House No.:E-56/12 Age: 28 Sex: Male |

Section No.:002)Gattigere Gram tana Gattigere Revenu, , Ward No: 160 -560098 Continued

| | | | | | | | | |
|-----------------|-----------------|-------------|-----------------|-----------------|-------------|-----------------|----------------|-------------|
| 411 | REJ4992186 | | 412 | REJ1200633 | | 413 | REJ1251073 | |
| Name : | Chinnappa | | Name : | Santhosh H T | | Name : | Ashok | |
| Father's Name: | Madappa | | Mother's Name: | Vijayamma | | Mother's Name: | Kalamamma | |
| House No.: | 57/10 | | House No.: | 58 | | House No.: | 58 | |
| Age: | 48 | Sex: Male | Age: | 31 | Sex: Male | Age: | 31 | Sex: Male |
| 414 | REJ0753624 | | 415 | REJ3640372 | | 416 | REJ3640380 | |
| Name : | Naveen Kumar | | Name : | Kalyani | | Name : | Prashanth | |
| Father's Name: | Manjunath | | Husband's Name: | Jagannatha | | Father's Name: | Jagannatha | |
| House No.: | 58 | | House No.: | E-58/1 | | House No.: | E-58/1 | |
| Age: | 26 | Sex: Male | Age: | 59 | Sex: Female | Age: | 33 | Sex: Male |
| 417 | REJ3640398 | | 418 | REJ0590141 | | 419 | MCL4461919 | |
| Name : | Anitha | | Name : | Kamala | | Name : | Rama | |
| Husband's Name: | Prashanth | | Husband's Name: | Ramesh | | Father's Name: | Chikkegowda | |
| House No.: | E-58/1 | | House No.: | E-58/2 | | House No.: | 59/10 | |
| Age: | 27 | Sex: Female | Age: | 41 | Sex: Female | Age: | 53 | Sex: Male |
| 420 | MCL4461901 | | 421 | REJ3640430 | | 422 | REJ3640448 | |
| Name : | Umadevi M | | Name : | Hiriyanna | | Name : | Suvarna | |
| Husband's Name: | Rama | | Father's Name: | Y . C. Rudrappa | | Husband's Name: | Hiriyanna | |
| House No.: | 59/10 | | House No.: | 59/26 | | House No.: | 59/26 | |
| Age: | 38 | Sex: Female | Age: | 50 | Sex: Male | Age: | 40 | Sex: Female |
| 423 | REJ4374633 | | 424 | REJ4374641 | | 425 | REJ3640463 | |
| Name : | S R Raghavendra | | Name : | Deepa S R | | Name : | Govindaraju | |
| Father's Name: | S K Ramanna | | Husband's Name: | S R Raghavendra | | Father's Name: | Shankar | |
| House No.: | 60/A | | House No.: | 60/A | | House No.: | 60/28 | |
| Age: | 42 | Sex: Male | Age: | 36 | Sex: Female | Age: | 52 | Sex: Male |
| 426 | REJ0590083 | | 427 | REJ0590091 | | 428 | REJ1201482 | |
| Name : | Selvi | | Name : | Kiran | | Name : | Raghunatha | |
| Husband's Name: | Govindaraju | | Father's Name: | Govindaraju | | Father's Name: | Nayak V S | |
| House No.: | 60/28 | | House No.: | 60/28 | | House No.: | E-60/13 | |
| Age: | 45 | Sex: Female | Age: | 27 | Sex: Male | Age: | 47 | Sex: Male |
| 429 | REJ1201490 | | 430 | REJ4409686 | | 431 | REJ5633664 | |
| Name : | Preethi | | Name : | John P Mathai | | Name : | Mini John | |
| Husband's Name: | Raghunatha | | Father's Name: | P M Mathai | | Husband's Name: | JOHN .P.MATHAI | |
| House No.: | E-60/13 | | House No.: | 62 | | House No.: | 62 | |
| Age: | 39 | Sex: Female | Age: | 47 | Sex: Male | Age: | 44 | Sex: Female |
| 432 | REJ1200245 | | 433 | MBQ7037153 | | 434 | REJ1200443 | |
| Name : | Ningamma | | Name : | Javaregowda G K | | Name : | Arjuna | |
| Husband's Name: | Kalegowda | | Father's Name: | Late.Kalegowda | | Father's Name: | Gopala | |
| House No.: | E-62/1/15 | | House No.: | E-62/1/15 | | House No.: | E-62/2/15 | |
| Age: | 70 | Sex: Female | Age: | 35 | Sex: Male | Age: | 41 | Sex: Male |
| 435 | REJ1200435 | | 436 | REJ0587535 | | 437 | REJ5633441 | |
| Name : | Rita | | Name : | Ananda. J | | Name : | Ravi Kumar.J.S | |
| Husband's Name: | Arjuna | | Father's Name: | Jayakumar | | Father's Name: | SANJEEVAYYA | |
| House No.: | E-62/2/15 | | House No.: | E-62/15 | | House No.: | 64 | |
| Age: | 33 | Sex: Female | Age: | 27 | Sex: Male | Age: | 29 | Sex: Male |
| 438 | REJ1200799 | | 439 | REJ1200591 | | 440 | REJ1200583 | |
| Name : | Basavaraja S. H | | Name : | Jayashri B. . H | | Name : | Chandir D | |
| Father's Name: | Shivappa | | Husband's Name: | Basavaraja S. H | | Father's Name: | Digambar Shet | |
| House No.: | E-64/1/16 | | House No.: | E-64/1/16 | | House No.: | E-64/16 | |
| Age: | 43 | Sex: Male | Age: | 34 | Sex: Female | Age: | 49 | Sex: Male |

Section No.:002)Gattigere Gram tana Gattigere Revenu, , Ward No: 160 -560098 Continued

| | | | | | | | | |
|-----------------|--|-------------|-----------------|-----------------------------|-------------|-----------------|---|-------------|
| 441 | REJ5018270 | | 442 | REJ5017744 | | 443 | REJ5517891 | |
| Name : | Ramanna Gowda Shyamalapura SHIVANANDAPPA | | Name : | Veena.R | | Name : | Shivanna.H.C | |
| Father's Name: | | | Husband's Name: | RAMAN GOWDA .S. MALLAPUR | | Father's Name: | CHOWDAIAH | |
| House No.: | 65 | Sex: Male | House No.: | 65 | Sex: Female | House No.: | 65 | Sex: Male |
| Age: | 34 | | Age: | 30 | | Age: | 37 | |
| 444 | REJ0583443 | | 445 | REJ0583435 | | 446 | REJ0590364 | |
| Name : | Basavaraju M P | | Name : | Shanthikumari G | | Name : | Parvathi K | |
| Father's Name: | Puttabasavegaud | | Husband's Name: | Basavaraju M P | | Husband's Name: | Chandruppa C | |
| House No.: | 66/2 | Sex: Male | House No.: | 66/2 | Sex: Female | House No.: | E-67/20 | Sex: Female |
| Age: | 40 | | Age: | 27 | | Age: | 59 | |
| 447 | REJ3640612 | | 448 | REJ0590372 | | 449 | REJ0751404 | |
| Name : | Shylaja A | | Name : | Vivekaraju C | | Name : | Bharath Raj C | |
| Husband's Name: | Palanethra | | Father's Name: | Chandruppa C | | Father's Name: | Chandruppa C | |
| House No.: | E-67/20 | Sex: Female | House No.: | E-67/20 | Sex: Male | House No.: | E-67/20 | Sex: Male |
| Age: | 37 | | Age: | 36 | | Age: | 34 | |
| 450 | REJ3640620 | | 451 | REJ0583096 | | 452 | REJ0583112 | |
| Name : | Palanethra | | Name : | Neetha N | | Name : | Nagaraju K S | |
| Father's Name: | Paramashivaiah S. M | | Father's Name: | Nagarajaiah K S | | Father's Name: | Sathanarayan Rao | |
| House No.: | E-68/21 | Sex: Male | House No.: | 70 | Sex: Female | House No.: | 70 | Sex: Male |
| Age: | 47 | | Age: | 28 | | Age: | 62 | |
| 453 | REJ0583104 | | 454 | REJ3640638 | | 455 | REJ3640646 | |
| Name : | K.L.Padma | | Name : | Shankar V H | | Name : | Kempamma | |
| Husband's Name: | NAGARAJA.K.S | | Father's Name: | Hanumanthaiah | | Husband's Name: | Shankar H V | |
| House No.: | 70 | Sex: Female | House No.: | E-71/31 | Sex: Male | House No.: | E-71/31 | Sex: Female |
| Age: | 55 | | Age: | 53 | | Age: | 47 | |
| 456 | REJ0756056 | | 457 | REJ4992210 | | 458 | REJ1201664 | |
| Name : | Asha S | | Name : | Pradeep.S | | Name : | Manjula N | |
| Father's Name: | Shankar H V | | Father's Name: | V.H.Shankar | | Husband's Name: | Hari N | |
| House No.: | E-71/31 | Sex: Female | House No.: | E 71/31 | Sex: Male | House No.: | 72 | Sex: Female |
| Age: | 27 | | Age: | 23 | | Age: | 29 | |
| 459 | REJ3640653 | | 460 | REJ3640661 | | 461 | REJ5017652 | |
| Name : | Siddaraju | | Name : | Rajamma K | | Name : | Nethravathi | |
| Father's Name: | Madesha Shetty | | Husband's Name: | Siddaraju | | Husband's Name: | M.Shrikantha | |
| House No.: | E-72/1 | Sex: Male | House No.: | E-72/1 | Sex: Female | House No.: | 74 | Sex: Female |
| Age: | 34 | | Age: | 29 | | Age: | 29 | |
| 462 | REJ5017587 | | 463 | REJ5017439 | | 464 | REJ0761114 | |
| Name : | Rajeshwari | | Name : | M.Shrikantha | | Name : | Yashodamma.P.H | |
| Husband's Name: | C.Mahadeva | | Father's Name: | C.Mahadeva | | Husband's Name: | Gangadhar | |
| House No.: | 74 | Sex: Female | House No.: | 74 | Sex: Male | House No.: | 75/2 | Sex: Female |
| Age: | 55 | | Age: | 32 | | Age: | 45 | |
| 465 | REJ3640695 | | 466 | REJ3640703 | | 467 | REJ3640711 | |
| Name : | Padmanabha Vinayaka Gokhale Vinayaka Gokhale | | Name : | Lakshmi Gokhale | | Name : | Sachidananda Gokhale N Padmanabha Gokhale | |
| Father's Name: | | | Husband's Name: | Padmanabha Gokhale | | Father's Name: | | |
| House No.: | E-75/27 | Sex: Male | House No.: | E-75/27 | Sex: Female | House No.: | E-75/27 | Sex: Male |
| Age: | 57 | | Age: | 80 | | Age: | 57 | |
| 468 | REJ3640729 | | 469 | REJ5633508 | | 470 | REJ5633383 | |
| Name : | Mina | | Name : | B.M.Murthy Manjunatha | | Name : | Deepa.P.S | |
| Husband's Name: | Sachidananda Gokhale | | Father's Name: | E.S.MALLAPPA | | Husband's Name: | B.M.MURTHY | |
| House No.: | E-75/27 | Sex: Female | House No.: | 76/2 | Sex: Male | House No.: | 76/2 | Sex: Female |
| Age: | 51 | | Age: | 43 | | Age: | 33 | |

Section No.:002)Gattigere Gram tana Gattigere Revenu, , Ward No: 160 -560098 Continued

| | | | | | | | | |
|-----------------|------------------------|-------------|-----------------|--------------------|-------------|-----------------|------------------|-------------|
| 471 | REJ0761486 | | 472 | MBQ7061757 | | 473 | REJ1251156 | |
| Name : | Padma | | Name : | Padmaja .K | | Name : | Srinivas Murthy | |
| Husband's Name: | Krishna N | | Husband's Name: | R . Sathyanarayana | | Father's Name: | Krishnappa | |
| House No.: | E-78/35 | | House No.: | 79 | | House No.: | 79/43 | |
| Age: | 36 | Sex: Female | Age: | 45 | Sex: Female | Age: | 85 | Sex: Male |
| 474 | REJ5017173 | | 475 | REJ1201359 | | 476 | REJ1053149 | |
| Name : | Ramesha.J.T | | Name : | Thejashwini B T | | Name : | Savitha K S | |
| Father's Name: | Thimmappa | | Husband's Name: | Srinivas Murthy | | Husband's Name: | Ramesh | |
| House No.: | 79/43 | | House No.: | 79/45 | | House No.: | 81 | |
| Age: | 30 | Sex: Male | Age: | 49 | Sex: Female | Age: | 28 | Sex: Female |
| 477 | REJ0585059 | | 478 | REJ0584961 | | 479 | REJ4992434 | |
| Name : | Narasimhamurthy | | Name : | Kalyani | | Name : | M.Prashanth | |
| Father's Name: | Dodda Ramanna | | Husband's Name: | Narasimha Murthy | | Father's Name: | Mahalinga | |
| House No.: | E-81/14 | | House No.: | E-81/14 | | House No.: | 82/18 | |
| Age: | 34 | Sex: Male | Age: | 26 | Sex: Female | Age: | 22 | Sex: Male |
| 480 | REJ3640828 | | 481 | REJ3640844 | | 482 | REJ3640851 | |
| Name : | Parvathamma | | Name : | Prasad | | Name : | Uma | |
| Husband's Name: | Siddamallappa Bagevadi | | Father's Name: | Rudraiah | | Husband's Name: | Prasad | |
| House No.: | E-82/1/15 | | House No.: | E-82/15 | | House No.: | E-82/15 | |
| Age: | 67 | Sex: Female | Age: | 42 | Sex: Male | Age: | 37 | Sex: Female |
| 483 | REJ0590281 | | 484 | REJ0585000 | | 485 | REJ5349055 | |
| Name : | Roopa D. S | | Name : | Rekha | | Name : | Raghavendra H | |
| Husband's Name: | Shivakumar D. B. | | Father's Name: | Lokeshappa | | Father's Name: | Hanumanthappa | |
| House No.: | 84/7 | | House No.: | E-85/12 | | House No.: | E-85/12 | |
| Age: | 29 | Sex: Female | Age: | 28 | Sex: Female | Age: | 31 | Sex: Male |
| 486 | REJ5349030 | | 487 | REJ5342415 | | 488 | REJ5342431 | |
| Name : | Dakshayini H | | Name : | Nagarajappa H | | Name : | H. S Rajeshwari | |
| Husband's Name: | Nagarajappa | | Father's Name: | Hanumanthappa | | Husband's Name: | H. V Ram Kumar | |
| House No.: | E-85/12 | | House No.: | E-85/12 | | House No.: | 87 | |
| Age: | 33 | Sex: Female | Age: | 77 | Sex: Male | Age: | 51 | Sex: Female |
| 489 | REJ3641073 | | 490 | REJ3641081 | | 491 | REJ3641107 | |
| Name : | Ramalingaiah | | Name : | Vishalakshi | | Name : | Vishwanatha C R | |
| Father's Name: | Shambegaud | | Husband's Name: | Ramalingaiah | | Father's Name: | Ramalingaiah C S | |
| House No.: | E-88/10 | | House No.: | E-88/10 | | House No.: | E-88/10 | |
| Age: | 67 | Sex: Male | Age: | 59 | Sex: Female | Age: | 34 | Sex: Male |
| 492 | REJ3640299 | | 493 | REJ5349071 | | 494 | REJ5342423 | |
| Name : | Anil Kumar Jindal | | Name : | Kale Gowda | | Name : | Purnima B.. R | |
| Father's Name: | LATE.ATMA RAM JINDAL | | Father's Name: | NARAYANAPPA | | Husband's Name: | Kalegowda | |
| House No.: | 89-B-1 | | House No.: | E-89 | | House No.: | E-89 | |
| Age: | 45 | Sex: Male | Age: | 47 | Sex: Male | Age: | 38 | Sex: Female |
| 495 | REJ0582080 | | 496 | REJ0589200 | | 497 | REJ0753715 | |
| Name : | Raghavendra Aras N | | Name : | Dileep Kumar K | | Name : | Deepesh Kumar | |
| Father's Name: | Nandish Raja Aras | | Father's Name: | Gopalan | | Mother's Name: | Leela C | |
| House No.: | E-90/181/1 | | House No.: | 91 | | House No.: | 91 | |
| Age: | 26 | Sex: Male | Age: | 45 | Sex: Male | Age: | 37 | Sex: Male |
| 498 | REJ0753616 | | 499 | REJ1201854 | | 500 | REJ1201128 | |
| Name : | Reeja M C | | Name : | Mahesh M. C | | Name : | Lakshmi | |
| Husband's Name: | Dileep Kumar K | | Father's Name: | Chikkaiah | | Husband's Name: | Mahesh M. C | |
| House No.: | 91 | | House No.: | E-91/2/6 | | House No.: | E-91/2/6 | |
| Age: | 41 | Sex: Female | Age: | 38 | Sex: Male | Age: | 33 | Sex: Female |

Section No.:002)Gattigere Gram tana Gattigere Revenu, , Ward No: 160 -560098 Continued

| | | | | | | | | |
|-----------------|------------------|-------------|-----------------|----------------------|-------------|-----------------|---------------------------|-------------|
| 501 | MCL1978311 | | 502 | MCL4461687 | | 503 | MCL4461695 | |
| Name : | Nandini | | Name : | Chandrashekhar.N | | Name : | Chandrakala.N | |
| Husband's Name: | Manjunath | | Father's Name: | Nanjundappa | | Husband's Name: | Chandrashekhar.N | |
| House No.: | 92 | | House No.: | 92 | | House No.: | 92 | |
| Age: | 46 | Sex: Female | Age: | 44 | Sex: Male | Age: | 43 | Sex: Female |
| 504 | REJ0750083 | | 505 | REJ0750091 | | 506 | REJ3638517 | |
| Name : | Prema Kumar | | Name : | Maheshappa | | Name : | Manjunath N | |
| Husband's Name: | Maheshappa | | Father's Name: | Basavegowda | | Father's Name: | Nanjundappa | |
| House No.: | 92 | | House No.: | 92 | | House No.: | 92 | |
| Age: | 46 | Sex: Female | Age: | 45 | Sex: Male | Age: | 48 | Sex: Male |
| 507 | REJ5018296 | | 508 | REJ4992905 | | 509 | REJ6089924 | |
| Name : | Naveen.D.H | | Name : | Anjali | | Name : | Amarnath Chigurupati | |
| Father's Name: | HONNE GOWDA | | Father's Name: | Kalliyam | | Father's Name: | Nageshwar Rao Chigurupati | |
| House No.: | 92 | | House No.: | 92 | | House No.: | 92 | |
| Age: | 34 | Sex: Male | Age: | 25 | Sex: Female | Age: | 25 | Sex: Male |
| 510 | REJ0758177 | | 511 | REJ1205475 | | 512 | REJ0586438 | |
| Name : | Shiva Lingegowda | | Name : | Savithri C | | Name : | Radha M. C | |
| Father's Name: | Nanjundegowda | | Husband's Name: | Channaiah T | | Father's Name: | Patte Gowda | |
| House No.: | 93 | | House No.: | E-93/13 | | House No.: | E-93/13 | |
| Age: | 56 | Sex: Male | Age: | 52 | Sex: Female | Age: | 41 | Sex: Female |
| 513 | REJ0750570 | | 514 | REJ0757799 | | 515 | REJ5342381 | |
| Name : | Rajesh C | | Name : | Krishna Murthy P | | Name : | Channaiah T | |
| Father's Name: | Channaiah T | | Father's Name: | Channaiah T | | Father's Name: | Thibbaiah | |
| House No.: | E-93/13 | | House No.: | E-93/13 | | House No.: | E-93/13 | |
| Age: | 32 | Sex: Male | Age: | 31 | Sex: Male | Age: | 66 | Sex: Male |
| 516 | REJ0755454 | | 517 | REJ0753103 | | 518 | REJ3641222 | |
| Name : | Virendra | | Name : | Leelavathi M G | | Name : | Chandrashekhar K.T | |
| Mother's Name: | Leelavathi M G | | Father's Name: | Sathyanarayana | | Father's Name: | Thimmegowda | |
| House No.: | 94 | | House No.: | 94 | | House No.: | E-94/1/37 | |
| Age: | 38 | Sex: Male | Age: | 61 | Sex: Female | Age: | 45 | Sex: Male |
| 519 | REJ3641230 | | 520 | REJ0587527 | | 521 | MCL4500658 | |
| Name : | Sudha Chandru | | Name : | Mohanakumar | | Name : | Padmavathi | |
| Husband's Name: | Chandrashekhar | | Father's Name: | Veera Bhadracharya | | Husband's Name: | Shivalingaiah | |
| House No.: | E-94/1/37 | | House No.: | E-94/37 | | House No.: | E-96/38 | |
| Age: | 35 | Sex: Female | Age: | 28 | Sex: Male | Age: | 49 | Sex: Female |
| 522 | REJ3641305 | | 523 | REJ0751420 | | 524 | REJ0751412 | |
| Name : | Raghavendra S | | Name : | Ramaji Pandith | | Name : | Suma | |
| Father's Name: | Shivalingaiah | | Father's Name: | Ramachandrar Pandith | | Husband's Name: | Ramaji Pandith | |
| House No.: | E-96/38 | | House No.: | E-97 | | House No.: | E-97 | |
| Age: | 26 | Sex: Male | Age: | 28 | Sex: Male | Age: | 29 | Sex: Female |
| 525 | REJ3641388 | | 526 | REJ3641396 | | 527 | REJ3641404 | |
| Name : | Anthappa | | Name : | Rayappa | | Name : | Martharayappa | |
| Father's Name: | Shanthappa | | Father's Name: | Anthappa | | Husband's Name: | Rayappa | |
| House No.: | E-98/50 | | House No.: | E-98/50 | | House No.: | E-98/50 | |
| Age: | 85 | Sex: Male | Age: | 56 | Sex: Male | Age: | 50 | Sex: Female |
| 528 | REJ3641412 | | 529 | REJ3641420 | | 530 | REJ0759886 | |
| Name : | Jhon Basco | | Name : | George David | | Name : | Sunitha T | |
| Father's Name: | Rayappa | | Father's Name: | Rayappa | | Husband's Name: | Bhaskar B. R | |
| House No.: | E-98/50 | | House No.: | E-98/50 | | House No.: | 99 | |
| Age: | 32 | Sex: Male | Age: | 29 | Sex: Male | Age: | 30 | Sex: Female |

Section No.:002)Gattigere Gram tana Gattigere Revenu, , Ward No: 160 -560098 Continued

| | | | | | | | | |
|-----|------------|---|-----|------------|---|-----|------------|--|
| 531 | REJ3641438 | Name : Narayana K Father's Name: kempanna House No.:E-99/1/39 Age: 57 Sex: Male | 532 | REJ3641446 | Name : Manjunath N Father's Name: Narayan K House No.:E-99/1/39 Age: 32 Sex: Male | 533 | REJ3641453 | Name : Mamatha N Father's Name: Narayana K House No.:E-99/1/39 Age: 30 Sex: Female |
| 534 | REJ1200930 | Name : Manjula Husband's Name: Rajesh H. B. House No.:E-99/39 Age: 26 Sex: Female | 535 | REJ4413852 | Name : Dr. Balaji Rao Father's Name: Late. Bhujanga Rao House No.:101 Age: 74 Sex: Male | 536 | REJ4413860 | Name : Madhava Rao Father's Name: Late. Bhujanga Rao House No.:101 Age: 78 Sex: Male |
| 537 | REJ1201219 | Name : Basavarajaiah B.. H Father's Name: Virup B.. H House No.:E-101/1/41 Age: 63 Sex: Male | 538 | REJ1201227 | Name : Sumangalamma Husband's Name: Basavarajaiah House No.:E-101/1/41 Age: 55 Sex: Female | 539 | REJ1201029 | Name : Shankaraiah B.. H Father's Name: Basavarajaiah House No.:E-101/1/41 Age: 32 Sex: Male |
| 540 | REJ1201888 | Name : Manjunath B.. H Father's Name: Basavaraju House No.:E-101/1/41 Age: 29 Sex: Male | 541 | REJ0755561 | Name : Ranganatha Father's Name: Ramaiah House No.:E-101/41 Age: 36 Sex: Male | 542 | REJ1200971 | Name : Manjula Husband's Name: Chamaraj House No.:102/2/47 Age: 32 Sex: Female |
| 543 | REJ0584946 | Name : Manjunath V Father's Name: Venkataswamy House No.:102/3/47 Age: 31 Sex: Male | 544 | REJ0584953 | Name : Rathna R Husband's Name: Manjunatha V House No.:102/3/47 Age: 29 Sex: Female | 545 | REJ0587030 | Name : Nagarathna A Husband's Name: Ramamurthy House No.:E-102/1 Age: 69 Sex: Female |
| 546 | REJ3641511 | Name : Honnamma Husband's Name: Kariyappa House No.:E-102/1 Age: 67 Sex: Female | 547 | REJ3641529 | Name : Chameraj Father's Name: Kariyappa House No.:E-102/1 Age: 37 Sex: Male | 548 | REJ3641537 | Name : Shivaraj Father's Name: Kariyappa House No.:E-102/1 Age: 32 Sex: Male |
| 549 | REJ0586834 | Name : Jayanth T R Father's Name: Ramamurthy House No.:E-102/1 Age: 32 Sex: Male | 550 | REJ0593475 | Name : Leelavathi Father's Name: Kariyappa House No.:E-102/1 Age: 28 Sex: Female | 551 | REJ3641602 | Name : Babu M A Father's Name: Elleyanna M K House No.:E-103/42 Age: 62 Sex: Male |
| 552 | REJ3641610 | Name : Pushpa Husband's Name: Elliyan House No.:E-103/42 Age: 52 Sex: Female | 553 | REJ3641636 | Name : Shridhara Ganesh Hegde Father's Name: Ganesh Hegde House No.:104/2/46 Age: 48 Sex: Male | 554 | REJ3641644 | Name : Nayana Shridhara Husband's Name: Shridhara Ganesh Hegde House No.:104/2/46 Age: 39 Sex: Female |
| 555 | REJ3641651 | Name : Rajamma Husband's Name: Chinnappa Hegde House No.:104/46 Age: 83 Sex: Female | 556 | REJ3641669 | Name : Prathap Father's Name: Chinnappa Hegde House No.:104/46 Age: 46 Sex: Male | 557 | REJ0591909 | Name : Ashwini Husband's Name: Prathap House No.:104/46 Age: 45 Sex: Female |
| 558 | REJ3641677 | Name : Kamal Singh R Father's Name: Radhe Sam Singh House No.:E-105/43 Age: 50 Sex: Male | 559 | REJ3641685 | Name : Anitha K. Singh Husband's Name: Kamal Singh R House No.:E-105/43 Age: 40 Sex: Female | 560 | REJ0755801 | Name : Basavaraju Father's Name: SIDDARAMASHETTY House No.:108/1/45 Age: 31 Sex: Male |

Section No.:002)Gattigere Gram tana Gattigere Revenu, , Ward No: 160 -560098 Continued

| | | | | | | | | |
|-----------------|-----------------------|-------------|-----------------|-----------------------|-------------|-----------------|--------------------------------------|-------------|
| 561 | REJ0592923 | | 562 | REJ0588426 | | 563 | REJ0588418 | |
| Name : | Kantharaju | | Name : | Gayathri M D | | Name : | Dayashankar M. B. | |
| Father's Name: | Kala Shetty | | Husband's Name: | Dayashankar M. D | | Father's Name: | Balaji Rao | |
| House No.: | 108/1/45 | | House No.: | 108/2/45 | | House No.: | 108/2/45 | |
| Age: | 25 | Sex: Male | Age: | 40 | Sex: Female | Age: | 37 | Sex: Male |
| 564 | REJ1202175 | | 565 | REJ1202183 | | 566 | MCL2011369 | |
| Name : | Ningegowda | | Name : | Vijayalakshmi | | Name : | Kumaraswamy | |
| Father's Name: | Bore Gowda | | Husband's Name: | Ningegowda | | Father's Name: | Rudrayyanavaru | |
| House No.: | E-108/45 | | House No.: | E-108/45 | | House No.: | E-111/16 | |
| Age: | 43 | Sex: Male | Age: | 39 | Sex: Female | Age: | 49 | Sex: Male |
| 567 | REJ3644507 | | 568 | REJ3644515 | | 569 | REJ3644523 | |
| Name : | Nagaveena Hebbar | | Name : | Chandrashekhar Hebbar | | Name : | Sulochana Hebbar | |
| Father's Name: | Chandrashekhar Hebbar | | Father's Name: | Venkataramana Hebbar | | Husband's Name: | Chandrashekhar Hebbar | |
| House No.: | 112 | | House No.: | 112 | | House No.: | 112 | |
| Age: | 40 | Sex: Female | Age: | 41 | Sex: Male | Age: | 66 | Sex: Female |
| 570 | REJ3644531 | | 571 | REJ3641784 | | 572 | REJ3641792 | |
| Name : | Guruprasad Hebbar | | Name : | Lokesh G C | | Name : | Vishala B. | |
| Father's Name: | Chandrashekhar Hebbar | | Father's Name: | Chikkanna G S | | Husband's Name: | Lokesh | |
| House No.: | 112 | | House No.: | E-114/14/A | | House No.: | E-114/14/A | |
| Age: | 37 | Sex: Male | Age: | 51 | Sex: Male | Age: | 42 | Sex: Female |
| 573 | REJ6041511 | | 574 | REJ3641818 | | 575 | REJ1201383 | |
| Name : | Nagaraju.K | | Name : | Ramkumar H. N | | Name : | Ramya H. R | |
| Father's Name: | KENCHAPPA | | Father's Name: | Venkataram H | | Father's Name: | Ram Kumar | |
| House No.: | 115, SMC NILAYA | | House No.: | E-117/87 | | House No.: | E-117/87 | |
| Age: | 34 | Sex: Male | Age: | 57 | Sex: Male | Age: | 26 | Sex: Female |
| 576 | REJ1204692 | | 577 | REJ0590919 | | 578 | REJ1205251 | |
| Name : | Subbareddy | | Name : | Shyamala | | Name : | Shalini Shivakumar Sarika Shivakumar | |
| Father's Name: | Anjanappa | | Husband's Name: | Subba Reddy | | Husband's Name: | Shivakumar | |
| House No.: | E-119/1 | | House No.: | E-119/1 | | House No.: | 120/106 | |
| Age: | 44 | Sex: Male | Age: | 32 | Sex: Female | Age: | 35 | Sex: Female |
| 579 | REJ0590604 | | 580 | REJ0592568 | | 581 | MCL4463410 | |
| Name : | Sharadamma | | Name : | Shivakumar | | Name : | Anjali | |
| Husband's Name: | Nandishappa | | Father's Name: | Nandishappa | | Husband's Name: | Raghunath | |
| House No.: | E-120/106 | | House No.: | E-120/106 | | House No.: | E-122/39 | |
| Age: | 77 | Sex: Female | Age: | 41 | Sex: Male | Age: | 58 | Sex: Female |
| 582 | REJ0585224 | | 583 | REJ0585232 | | 584 | REJ3641933 | |
| Name : | Raja Shekhar | | Name : | Veena | | Name : | Shrivathsa S | |
| Father's Name: | Shivanna | | Husband's Name: | Raja Shekhar | | Father's Name: | Srinivas Iyengar | |
| House No.: | 123 | | House No.: | 123 | | House No.: | E-123/1/19 | |
| Age: | 43 | Sex: Male | Age: | 32 | Sex: Female | Age: | 47 | Sex: Male |
| 585 | REJ3641941 | | 586 | REJ3641966 | | 587 | REJ3641974 | |
| Name : | Suman S | | Name : | Anantha Shayana | | Name : | Vaidehi S | |
| Husband's Name: | Shrivathsa | | Father's Name: | Rajiva Lochanam | | Father's Name: | Anantha Shayana | |
| House No.: | E-123/1/19 | | House No.: | E-123/2/19 | | House No.: | E-123/2/19 | |
| Age: | 40 | Sex: Female | Age: | 62 | Sex: Male | Age: | 53 | Sex: Female |
| 588 | REJ3641982 | | 589 | REJ0589820 | | 590 | REJ0593319 | |
| Name : | Sureshachara | | Name : | Gopal | | Name : | Hema | |
| Father's Name: | Avwaja Char | | Father's Name: | Krishnappa | | Husband's Name: | Gopal | |
| House No.: | E-123/2/19 | | House No.: | E-125/25 | | House No.: | E-125/25 | |
| Age: | 45 | Sex: Male | Age: | 42 | Sex: Male | Age: | 44 | Sex: Female |

Section No.:002)Gattigere Gram tana Gattigere Revenu, , Ward No: 160 -560098 Continued

| | | | | | | | | |
|-----|------------|---|-----|------------|---|-----|------------|---|
| 591 | MCL4502308 | Name : Kempanna Patil Father's Name: Malagaud House No.:E-129/24 Age: 48 Sex: Male | 592 | MCL4502316 | Name : Kasthuri Patil Husband's Name: Kempanna Patil House No.:E-129/24 Age: 40 Sex: Female | 593 | MBQ7064157 | Name : Ambajammani Father's Name: Basavaraj Aras House No.:E-130/1/30 Age: 80 Sex: Female |
| 594 | MCL4500294 | Name : Balakrishnaraje Aras N. B. Father's Name: Basavaraj Aras House No.:E-130/1/30 Age: 50 Sex: Male | 595 | MCL4462131 | Name : Veena Aras .A.N Husband's Name: Balakrishnaraja Aras House No.:E-130/1/30 Age: 41 Sex: Female | 596 | MCL2012904 | Name : T S Suryanarayanarao Father's Name: T Subbarao House No.:E-130/1/32 Age: 56 Sex: Male |
| 597 | MCL2012896 | Name : Arathi Husband's Name: T S Suryanarayanarao House No.:E-130/1/32 Age: 50 Sex: Female | 598 | REJ0752287 | Name : Siddaling Swamy P B. Father's Name: Basavaraju House No.:131 Age: 42 Sex: Male | 599 | REJ0587519 | Name : Manjula T Husband's Name: Chavhan S.T.R House No.:E-132/2/9 Age: 52 Sex: Female |
| 600 | REJ0758367 | Name : Ashwini T Father's Name: Chavhan S.T.R. House No.:E-132/2/9 Age: 31 Sex: Female | 601 | REJ3642121 | Name : Sidda Rama Gowda Father's Name: Siddappa V House No.:E-132/26 Age: 50 Sex: Male | 602 | REJ3642139 | Name : Shobha Y Husband's Name: Siddaraman Gowda House No.:E-132/26 Age: 42 Sex: Female |
| 603 | REJ0756031 | Name : Murulidhar N Father's Name: Nanjaiah M. N House No.:E-133/73 Age: 52 Sex: Male | 604 | REJ0756049 | Name : Nagamani M. C Husband's Name: Muralidhar N House No.:E-133/73 Age: 41 Sex: Female | 605 | REJ0582106 | Name : Ranjithamanni Husband's Name: Prasanna Raja Aras House No.:E-134/30 Age: 35 Sex: Female |
| 606 | REJ0756882 | Name : Vijaya Shekar.S Father's Name: Late.A.Srinivas House No.:135/136 Age: 36 Sex: Male | 607 | REJ0756718 | Name : E.Sumithra Husband's Name: LEONARD PHILLIPS House No.:135/136 Age: 66 Sex: Female | 608 | REJ0756106 | Name : Leonard Phillips Father's Name: LATE.PHILLIPS House No.:135/136 Age: 72 Sex: Male |
| 609 | REJ0756098 | Name : Reena Philips Husband's Name: VIJAYA SHEKAR.S House No.:135/136 Age: 35 Sex: Female | 610 | REJ0756890 | Name : Richard Phillips Father's Name: LEONARD PHILLIPS House No.:135/136 Age: 34 Sex: Male | 611 | REJ5799911 | Name : Ananda Babu.G.A Father's Name: ANANTHA.G.V House No.:135/136/A Age: 50 Sex: Male |
| 612 | REJ5787106 | Name : Neha.G.A Father's Name: ANANDA BABU.G House No.:135/136-A Age: 19 Sex: Female | 613 | MCL4461604 | Name : R Girish Father's Name: Rudrappa House No.:E-135/3/27 Age: 47 Sex: Male | 614 | MCL1978154 | Name : V Shobha Husband's Name: R Girish House No.:E-135/3/27 Age: 38 Sex: Female |
| 615 | REJ0750752 | Name : Lokesh Kunder Father's Name: Shivaram Kanchana House No.:E-135/3/27 Age: 35 Sex: Male | 616 | REJ0750760 | Name : Lathersh Kunder Father's Name: Shivaramkanchana House No.:E-135/3/27 Age: 32 Sex: Male | 617 | REJ0750745 | Name : Jayanthi K. C Father's Name: Thimmegowda House No.:E-135/3/27 Age: 29 Sex: Female |
| 618 | REJ5799903 | Name : R.Murgan Father's Name: G.R.RAMALINGAM House No.:136/137 Age: 37 Sex: Male | 619 | REJ5799929 | Name : R.Armugam Father's Name: G.R.RAMALINGAM House No.:136/137 Age: 40 Sex: Male | 620 | REJ0582528 | Name : Subramanya Father's Name: Ramamurthy House No.:E-136/29 Age: 46 Sex: Male |

Section No.:002)Gattigere Gram tana Gattigere Revenu, , Ward No: 160 -560098 Continued

| | | | | | | | | |
|-----------------|-------------------|-------------|-----------------|-----------------------|-------------|-----------------|----------------------------|-------------|
| 621 | REJ0582510 | | 622 | REJ0593145 | | 623 | REJ0760827 | |
| Name : | Shila | | Name : | Anjali | | Name : | Raju A | |
| Husband's Name: | Subramanya | | Husband's Name: | Raju | | Father's Name: | Annamalai | |
| House No.: | E-136/29 | | House No.: | E-137/9 | | House No.: | E-138/11 | |
| Age: | 43 | Sex: Female | Age: | 47 | Sex: Female | Age: | 58 | Sex: Male |
| 624 | REJ1056423 | | 625 | REJ0761023 | | 626 | MCL2014710 | |
| Name : | Arun A.S | | Name : | Shwetha D.S | | Name : | Shivalingaiah N H | |
| Father's Name: | Natarajan | | Husband's Name: | Arun A.S | | Father's Name: | Late. Yalavappa | |
| House No.: | 139 | | House No.: | 139 | | House No.: | E-139/1/13 | |
| Age: | 41 | Sex: Male | Age: | 41 | Sex: Female | Age: | 58 | Sex: Male |
| 627 | MCL2014728 | | 628 | REJ0585109 | | 629 | REJ0585125 | |
| Name : | Vasundaradevi | | Name : | Chandrashekhar Murthy | | Name : | Chandrapraba | |
| Husband's Name: | Shivalingaiah N H | | Father's Name: | Mallaiah | | Husband's Name: | Chandrashekhar Murthy P. M | |
| House No.: | E-139/1/13 | | House No.: | E-139/2/13 | | House No.: | E-139/2/13 | |
| Age: | 40 | Sex: Female | Age: | 46 | Sex: Male | Age: | 45 | Sex: Female |
| 630 | REJ0585331 | | 631 | REJ0585349 | | 632 | REJ3642386 | |
| Name : | Govindaraj | | Name : | Selvi | | Name : | Sathyavelu | |
| Father's Name: | Kaliyappa | | Husband's Name: | Govindaraj | | Father's Name: | Govindharaja | |
| House No.: | E-140/14 | | House No.: | E-140/14 | | House No.: | E-140/14 | |
| Age: | 47 | Sex: Male | Age: | 42 | Sex: Female | Age: | 26 | Sex: Male |
| 633 | REJ0587766 | | 634 | REJ0587774 | | 635 | REJ0587782 | |
| Name : | Channaiah M. G | | Name : | Jayamma K | | Name : | Vanitha C | |
| Father's Name: | Late. Guddegauad | | Husband's Name: | Channaiah M. G | | Father's Name: | Channaiah M. G | |
| House No.: | E-141/15 | | House No.: | E-141/15 | | House No.: | E-141/15 | |
| Age: | 54 | Sex: Male | Age: | 49 | Sex: Female | Age: | 26 | Sex: Female |
| 636 | MCL2016293 | | 637 | MCL4504486 | | 638 | REJ0591081 | |
| Name : | Thopegouda G C | | Name : | Yashodha | | Name : | Javaregowda | |
| Father's Name: | Chikkegowda | | Husband's Name: | Thopegouda | | Father's Name: | Poojari Javaregowda | |
| House No.: | E-143/17 | | House No.: | E-143/17 | | House No.: | E-144/18 | |
| Age: | 60 | Sex: Male | Age: | 50 | Sex: Female | Age: | 55 | Sex: Male |
| 639 | REJ0591099 | | 640 | REJ0750299 | | 641 | REJ0750281 | |
| Name : | Shantha M.S | | Name : | Prashanth | | Name : | Sharadamma | |
| Husband's Name: | Javaregowda | | Father's Name: | Gopal C. P | | Husband's Name: | Gopal C. P | |
| House No.: | E-144/18 | | House No.: | E-146/9 | | House No.: | E-146/9 | |
| Age: | 39 | Sex: Female | Age: | 25 | Sex: Male | Age: | 62 | Sex: Female |
| 642 | REJ1201292 | | 643 | REJ1201144 | | 644 | MCL2016020 | |
| Name : | Vamma | | Name : | Seethamma | | Name : | Halamma | |
| Husband's Name: | Kondaiah | | Husband's Name: | Kondaiah V | | Husband's Name: | Veerabhadrappa | |
| House No.: | 147/2/7 | | House No.: | 147/2/7 | | House No.: | E-147/7 | |
| Age: | 62 | Sex: Female | Age: | 34 | Sex: Female | Age: | 48 | Sex: Female |
| 645 | MCL4501508 | | 646 | REJ1201052 | | 647 | REJ3642709 | |
| Name : | Divakar B V | | Name : | Sathish J. N | | Name : | Srinivas | |
| Father's Name: | Veerabhadrappa | | Father's Name: | Nanjundappa | | Father's Name: | Chikka Puttegowda | |
| House No.: | E-147/7 | | House No.: | E-147/7 | | House No.: | 148/6 | |
| Age: | 31 | Sex: Male | Age: | 32 | Sex: Male | Age: | 44 | Sex: Male |
| 648 | REJ3642725 | | 649 | REJ0587980 | | 650 | REJ0755637 | |
| Name : | Shakunthala | | Name : | Dodda Lingaiah | | Name : | Siddamma | |
| Husband's Name: | Srinivas | | Father's Name: | Lingaiah | | Husband's Name: | Doddalingaiah | |
| House No.: | 148/6 | | House No.: | 149/20 | | House No.: | 149/20 | |
| Age: | 33 | Sex: Female | Age: | 62 | Sex: Male | Age: | 52 | Sex: Female |

Section No.:002)Gattigere Gram tana Gattigere Revenu, , Ward No: 160 -560098 Continued

| | | | | | | | | |
|-----|------------|---|-----|------------|---|-----|------------|---|
| 651 | REJ0592857 | Name : Shivashankar Father's Name: Doddalingaiah House No.:149/20 Age: 39 Sex: Male | 652 | REJ0753509 | Name : Dorekalappa K Father's Name: Kalappa House No.:150 Age: 34 Sex: Male | 653 | REJ1255074 | Name : Jyothi Husband's Name: Dorai Kalappa House No.:150 Age: 27 Sex: Female |
| 654 | REJ0754978 | Name : Ramabai Husband's Name: Dwarakanath House No.:151/2/2 Age: 44 Sex: Female | 655 | REJ0585455 | Name : Padmavathi K T Husband's Name: Shivanna House No.:E-151/2 Age: 58 Sex: Female | 656 | REJ0585463 | Name : Arjuna B. A Father's Name: Shivanna House No.:E-151/2 Age: 27 Sex: Male |
| 657 | REJ1052778 | Name : Vishalakshi Husband's Name: Basavaraju House No.:153/2/23 Age: 35 Sex: Female | 658 | REJ0586891 | Name : Shivalingaiah P Father's Name: Puttalingowda L House No.:E-154/24 Age: 44 Sex: Male | 659 | REJ3642915 | Name : Rathna K Husband's Name: Shivalingaiah P House No.:E-154/24 Age: 38 Sex: Female |
| 660 | REJ3642998 | Name : Kasthuri Bai Husband's Name: Ramal Rao House No.:E-157 Age: 45 Sex: Female | 661 | REJ0761478 | Name : Venkob Rao Father's Name: Ramal Rao House No.:E-157 Age: 29 Sex: Male | 662 | REJ0752840 | Name : Chandra Bai Husband's Name: Ravi House No.:E-157 Age: 32 Sex: Female |
| 663 | REJ0752865 | Name : Krishnarao Father's Name: Srinivasa Rao House No.:E-157 Age: 35 Sex: Male | 664 | REJ0752857 | Name : Rani Bai Husband's Name: Venkob Rao House No.:E-157 Age: 31 Sex: Female | 665 | REJ0585661 | Name : Mahesh Father's Name: Thirumalaiah House No.:E-163/39 Age: 51 Sex: Male |
| 666 | REJ0592618 | Name : Daya Father's Name: Mahesh House No.:E-163/39 Age: 26 Sex: Male | 667 | REJ5342399 | Name : Manjamma Husband's Name: Mahesh House No.:E-163/39 Age: 42 Sex: Female | 668 | REJ0761643 | Name : Sowmya Father's Name: Yadushailan House No.:164/3/36/2 Age: 30 Sex: Female |
| 669 | REJ0587022 | Name : Muttamma Husband's Name: Muniyappa House No.:164/36/2 Age: 52 Sex: Female | 670 | REJ0589309 | Name : Galappa Father's Name: Muniyappa House No.:164/36/2 Age: 47 Sex: Male | 671 | REJ0587014 | Name : Gangamma Husband's Name: Galappa House No.:164/36/2 Age: 36 Sex: Female |
| 672 | REJ0752873 | Name : Ramu Father's Name: Kullegowda House No.:E-167/45 Age: 57 Sex: Male | 673 | REJ0752881 | Name : Madevamma Husband's Name: Ramu House No.:E-167/45 Age: 36 Sex: Female | 674 | REJ0754465 | Name : Kumara Father's Name: Ramu House No.:E-167/45 Age: 26 Sex: Male |
| 675 | REJ0752329 | Name : Murugesh Father's Name: Kallanna House No.:E-168 Age: 62 Sex: Male | 676 | REJ0752337 | Name : Kaniyamma Husband's Name: Murugesh House No.:E-168 Age: 47 Sex: Female | 677 | REJ0754283 | Name : Venkatesha Father's Name: Murugesh House No.:E-168 Age: 34 Sex: Male |
| 678 | REJ0752345 | Name : Selvi Husband's Name: Venkatesh House No.:E-168 Age: 26 Sex: Female | 679 | REJ0754275 | Name : Vinay Father's Name: Murugesh House No.:E-168 Age: 26 Sex: Male | 680 | REJ3643277 | Name : Gangadharaiah B.. G Father's Name: Gangaiah House No.:169 Age: 38 Sex: Male |

Section No.:002)Gattigere Gram tana Gattigere Revenu, , Ward No: 160 -560098 Continued

| | | | | | | | | |
|-----|------------|---|-----|------------|---|-----|------------|--|
| 681 | REJ4785663 | Name : Shivakumar N Father's Name: Ningaiah House No.:169 Age: 35 Sex: Male | 682 | REJ1253251 | Name : Krishna Murthy S Father's Name: Srinivas Shasthri House No.:E-171/14 Age: 61 Sex: Male | 683 | REJ1203439 | Name : Vasantha Husband's Name: Krishna Murthy S House No.:E-171/14 Age: 54 Sex: Female |
| 684 | REJ1203447 | Name : Samatha Deepthi Father's Name: Krishna Murthy S House No.:E-171/14 Age: 30 Sex: Female | 685 | REJ4374724 | Name : Shanthavva Phakirappa Husband's Name: Phakirappa Shirahatti House No.:176 Age: 55 Sex: Female | 686 | MCL2462372 | Name : Lokesh C Father's Name: Late. Chikkigowda House No.:179 Age: 35 Sex: Male |
| 687 | REJ1250760 | Name : Savitha K Husband's Name: Lokesh C House No.:179 Age: 29 Sex: Female | 688 | REJ5017033 | Name : Jyothi.L Husband's Name: Lokesh House No.:181 Age: 25 Sex: Female | 689 | REJ4993374 | Name : Mahalakshamma Husband's Name: NagaRaju House No.:181 Age: 48 Sex: Female |
| 690 | REJ4993085 | Name : Nagaraju.B.J Father's Name: Joogappa House No.:181 Age: 62 Sex: Male | 691 | REJ0582072 | Name : Deepak Aras Father's Name: Srikantha Rajee Aras House No.:181/2 Age: 31 Sex: Male | 692 | REJ4992061 | Name : N.B.Srikanta Rajee Urs Father's Name: M.BASAVARAJE URS House No.:182/2 Age: 63 Sex: Male |
| 693 | REJ0582098 | Name : Prathibha Aras S Father's Name: Srikantha Rajee Aras N B. House No.:182/8 Age: 29 Sex: Female | 694 | REJ4992889 | Name : B.Nandeesh Rajee Urs Father's Name: M.Basava Rajee Urs House No.:182/57 Age: 58 Sex: Male | 695 | REJ4992541 | Name : N.Ragavendra Urs Father's Name: B.Nandi Rajee Urs House No.:182/57 Age: 25 Sex: Male |
| 696 | REJ5016662 | Name : N.Dananjaya Urs Father's Name: B.Nandish Rajee Urs House No.:182/57 Age: 28 Sex: Male | 697 | REJ5633896 | Name : Radha Husband's Name: VENKATESH.V House No.:186/11 Age: 30 Sex: Female | 698 | REJ5599709 | Name : K.Sarala Husband's Name: A.V.KRISHNA PRASAD House No.:B.205 Age: 64 Sex: Female |
| 699 | REJ5518576 | Name : A.K.Bharath Kumar Father's Name: LATE.A.V.KRISHNA PRASAD House No.:B.205 Age: 33 Sex: Male | 700 | REJ3643400 | Name : Usha Husband's Name: Shankar Prasad B House No.:225/F Age: 52 Sex: Female | 701 | REJ3643418 | Name : Bindya B S Father's Name: Shankar Prasad B House No.:225/F Age: 32 Sex: Female |
| 702 | REJ3643426 | Name : Shankar Prasad B Father's Name: Bhavani Prasad House No.:225/F Age: 58 Sex: Male | 703 | REJ3643434 | Name : Ashok Kumar B S Father's Name: Shankar Prasad G House No.:225/F Age: 34 Sex: Male | 704 | MCL4465993 | Name : Mallareddy S Father's Name: Late. Siddareddy House No.:280/6 Age: 61 Sex: Female |
| 705 | REJ3643475 | Name : Manjunatha M Father's Name: Mallareddy S House No.:280/6 Age: 40 Sex: Male | 706 | REJ0757336 | Name : Sunitha V Husband's Name: Suresh M House No.:280/6 Age: 36 Sex: Female | 707 | REJ0589481 | Name : Kalavathi S Husband's Name: Manjunatha M House No.:280/6 Age: 37 Sex: Female |
| 708 | REJ3643483 | Name : Manjunatha Reddy B V Father's Name: Venkataswamy Reddy House No.:280/6 Age: 45 Sex: Male | 709 | REJ3643491 | Name : Lalitha S M Husband's Name: Manjunatha Reddy B V House No.:280/6 Age: 38 Sex: Female | 710 | REJ3643509 | Name : Srinivasa Reddy Father's Name: Siddareddy House No.:281 Age: 49 Sex: Male |

Section No.:002)Gattigere Gram tana Gattigere Revenu, , Ward No: 160 -560098 Continued

| | | | | | | | | |
|-----------------|---------------------|-------------|-----------------|--------------------------|-------------|-----------------|-------------------------|-------------|
| 711 | REJ0586842 | | 712 | REJ3643517 | | 713 | REJ0586859 | |
| Name : | Venkatappa | | Name : | Varalakshmi | | Name : | Rathnamma | |
| Father's Name: | Chennagirappa | | Husband's Name: | Srinivasa Reddy | | Husband's Name: | Venkatappa | |
| House No.: | 281 | | House No.: | 281 | | House No.: | 281 | |
| Age: | 47 | Sex: Male | Age: | 42 | Sex: Female | Age: | 36 | Sex: Female |
| 714 | REJ6033468 | | 715 | REJ6071674 | | 716 | REJ5634068 | |
| Name : | Gayathri | | Name : | Govindarajan Subramanian | | Name : | S.K.Veena | |
| Husband's Name: | GOVINDARAJAN | | Father's Name: | SUBRAMANIAN | | Husband's Name: | NANJUNDA SWAMY.B.H | |
| House No.: | 281,B-305, BROCADE | | House No.: | 281,B-305 | | House No.: | 287/2 | |
| Age: | 29 | Sex: Female | Age: | 29 | Sex: Male | Age: | 40 | Sex: Female |
| 717 | REJ5633904 | | 718 | REJ5813175 | | 719 | REJ3643566 | |
| Name : | Nanjunda Swamy. B.H | | Name : | Mahuva Adaka Mandal | | Name : | Vidyanand Nayar M. S | |
| Father's Name: | LATE.NANJIAH.S | | Husband's Name: | SUBHASHIS MANDAL | | Father's Name: | Somaiah | |
| House No.: | 287/2 | | House No.: | 301 | | House No.: | E-328/10/1 | |
| Age: | 46 | Sex: Male | Age: | 34 | Sex: Female | Age: | 47 | Sex: Male |
| 720 | REJ3643574 | | 721 | REJ3643582 | | 722 | REJ0589721 | |
| Name : | Sumitha B. | | Name : | Bhagya | | Name : | Ashok Kumar G | |
| Husband's Name: | Vidyanand Nayar | | Husband's Name: | Gurulingaiah B M | | Father's Name: | Gurulingaiah B.. M. | |
| House No.: | E-328/10/1 | | House No.: | E-330/116/ | | House No.: | E-330/116/ | |
| Age: | 42 | Sex: Female | Age: | 47 | Sex: Female | Age: | 34 | Sex: Male |
| 723 | REJ0757914 | | 724 | REJ0590836 | | 725 | REJ0758425 | |
| Name : | Apparao V. R | | Name : | Annamma R | | Name : | Ramesh N | |
| Father's Name: | Late. Rajappa | | Husband's Name: | Apparao | | Father's Name: | Nagaraj N | |
| House No.: | E-331/48 | | House No.: | E-331/48 | | House No.: | E-331/48 | |
| Age: | 63 | Sex: Male | Age: | 55 | Sex: Female | Age: | 44 | Sex: Male |
| 726 | REJ0590901 | | 727 | REJ3643616 | | 728 | REJ0758417 | |
| Name : | Nagendra A | | Name : | Adi Shesha | | Name : | Nagaveena A | |
| Father's Name: | Apparao | | Father's Name: | Apparao | | Husband's Name: | Ramesha N | |
| House No.: | E-331/48 | | House No.: | E-331/48 | | House No.: | E-331/48 | |
| Age: | 40 | Sex: Male | Age: | 37 | Sex: Male | Age: | 35 | Sex: Female |
| 729 | REJ0590844 | | 730 | REJ0586602 | | 731 | REJ0593178 | |
| Name : | Anuradha | | Name : | Iraday Raj Y | | Name : | Francis Antony Y | |
| Husband's Name: | Nagendra A | | Father's Name: | Yagappa J | | Father's Name: | Yagappa J | |
| House No.: | E-331/48 | | House No.: | E-332/54 | | House No.: | E-332/54 | |
| Age: | 32 | Sex: Female | Age: | 47 | Sex: Male | Age: | 44 | Sex: Male |
| 732 | REJ0587154 | | 733 | REJ0593186 | | 734 | REJ0584300 | |
| Name : | Kavitha Raj | | Name : | Janeta Mary | | Name : | Vijayakumar C | |
| Husband's Name: | Iraday Raj Y | | Husband's Name: | Fransas Antony | | Father's Name: | Late. Chandrashekhara R | |
| House No.: | E-332/54 | | House No.: | E-332/54 | | House No.: | E-333/555 | |
| Age: | 40 | Sex: Female | Age: | 38 | Sex: Female | Age: | 45 | Sex: Female |
| 735 | REJ0584292 | | 736 | REJ0584250 | | 737 | REJ0584268 | |
| Name : | Bruntha B. V | | Name : | Suresh R | | Name : | Shantha | |
| Husband's Name: | Vijayakumar C | | Father's Name: | Revanna | | Husband's Name: | Suresh | |
| House No.: | E-333/555 | | House No.: | 334/1/106/ | | House No.: | 334/1/106/ | |
| Age: | 39 | Sex: Female | Age: | 40 | Sex: Male | Age: | 31 | Sex: Female |
| 738 | REJ0585729 | | 739 | REJ0585737 | | 740 | REJ0756726 | |
| Name : | Sadananda | | Name : | Vijaya. | | Name : | Parvathi | |
| Father's Name: | Chaudaiah | | Husband's Name: | Sadananda | | Husband's Name: | Umashankar | |
| House No.: | E-335/64 | | House No.: | E-335/64 | | House No.: | E-335/64 | |
| Age: | 67 | Sex: Male | Age: | 58 | Sex: Female | Age: | 50 | Sex: Female |

Section No.:002)Gattigere Gram tana Gattigere Revenu, , Ward No: 160 -560098 Continued

| | | | | | | | | |
|-----------------|---|-------------|-----------------|-----------------------|-------------|-----------------|-----------------------|-------------|
| 741 | REJ0585711 | | 742 | REJ0756742 | | 743 | REJ0756734 | |
| Name : | Smitha | | Name : | Sowmya | | Name : | Shruthi | |
| Father's Name: | Sadananda | | Father's Name: | Umashankar | | Father's Name: | Umashankar | |
| House No.: | E-335/64 | | House No.: | E-335/64 | | House No.: | E-335/64 | |
| Age: | 36 | Sex: Female | Age: | 28 | Sex: Female | Age: | 26 | Sex: Female |
| 744 | REJ5342332 | | 745 | REJ3643657 | | 746 | REJ3643665 | |
| Name : | Umashankar | | Name : | Basavanthappa L. J | | Name : | Devamma | |
| Father's Name: | Rajashekharaiyah N | | Father's Name: | Kariyappa | | Husband's Name: | Basavanthappa | |
| House No.: | E-335/64 | | House No.: | E-337/62 | | House No.: | E-337/62 | |
| Age: | 53 | Sex: Male | Age: | 76 | Sex: Male | Age: | 66 | Sex: Female |
| 747 | REJ1201458 | | 748 | REJ1201441 | | 749 | REJ0592766 | |
| Name : | Dinesha G. B. | | Name : | Hemamalini R. S | | Name : | Venkatesha | |
| Father's Name: | Basavaraj T. H | | Father's Name: | Srinivas | | Father's Name: | Thimmaiah | |
| House No.: | E-337/62 | | House No.: | E-337/62 | | House No.: | E-339/13 | |
| Age: | 32 | Sex: Male | Age: | 29 | Sex: Female | Age: | 40 | Sex: Male |
| 750 | REJ0760066 | | 751 | REJ1204387 | | 752 | REJ1250828 | |
| Name : | Lalitha | | Name : | Manjula H. M | | Name : | Jyoshi K. R | |
| Husband's Name: | Venkatesh | | Husband's Name: | Ramesh B.. S | | Father's Name: | Jyoshi K. V | |
| House No.: | E-339/13 | | House No.: | E-340/13 | | House No.: | E-341/4 | |
| Age: | 30 | Sex: Female | Age: | 47 | Sex: Female | Age: | 64 | Sex: Male |
| 753 | REJ1250810 | | 754 | REJ1251818 | | 755 | REJ1250836 | |
| Name : | Mamatha R Jyoshi | | Name : | Sathish N Hebbar | | Name : | Sudhasatish | |
| Husband's Name: | Jyoshi K. R | | Father's Name: | Vasudev Hebbar | | Husband's Name: | Sathish | |
| House No.: | E-341/4 | | House No.: | E-342/3 | | House No.: | E-342/3 | |
| Age: | 60 | Sex: Female | Age: | 40 | Sex: Male | Age: | 35 | Sex: Female |
| 756 | REJ1253905 | | 757 | REJ1253921 | | 758 | REJ1253913 | |
| Name : | Aanand Thirth Huyitharol Hanumantha Rao | | Name : | Anjana | | Name : | Anantha A. H | |
| Father's Name: | | | Husband's Name: | Ananda. Thirthahuyila | | Father's Name: | Ananda. Thirtha | |
| House No.: | E-342/33 | Sex: Male | House No.: | E-342/33 | Sex: Female | House No.: | E-342/33 | Sex: Male |
| Age: | 60 | | Age: | 55 | | Age: | 26 | |
| 759 | REJ3643731 | | 760 | MBQ7062961 | | 761 | MBQ7062953 | |
| Name : | Shrinivasarao K | | Name : | Harsha D .Kalamadini | | Name : | Priya .S. Kalamadini | |
| Father's Name: | Krishnaji Rao | | Father's Name: | K V Dhruva | | Husband's Name: | Sunil . D. Kalamadini | |
| House No.: | E-343/20 | | House No.: | E344/45 | | House No.: | E344/45 | |
| Age: | 48 | Sex: Male | Age: | 30 | Sex: Male | Age: | 29 | Sex: Female |
| 762 | MBQ7062946 | | 763 | MBQ7062185 | | 764 | REJ3643756 | |
| Name : | Sunil .D . Kalamadini | | Name : | Meera D . Kalamadini | | Name : | Srinivasa A | |
| Father's Name: | K . V . Dhruva | | Husband's Name: | K . V . Dhruva | | Father's Name: | Adavi Rao | |
| House No.: | E 344/456/ | | House No.: | E 344/45 | | House No.: | E-345/38 | |
| Age: | 41 | Sex: Male | Age: | 29 | Sex: Female | Age: | 72 | Sex: Male |
| 765 | MBQ6553051 | | 766 | REJ3643764 | | 767 | REJ3643772 | |
| Name : | Geetha | | Name : | Gururaj H. M | | Name : | Varsha Gururaj | |
| Husband's Name: | Srinivasa A | | Father's Name: | Madavarao H. L | | Husband's Name: | Gururaj H. M | |
| House No.: | E-345/38 | | House No.: | E-345/38 | | House No.: | E-345/38 | |
| Age: | 64 | Sex: Female | Age: | 42 | Sex: Male | Age: | 41 | Sex: Female |
| 768 | REJ0754226 | | 769 | REJ3643780 | | 770 | REJ3643798 | |
| Name : | Gopal | | Name : | Ramachandra N | | Name : | Latha Ramachandra N. | |
| Father's Name: | Panduranga Rao | | Father's Name: | Direndra Char | | Husband's Name: | Ramachandra N | |
| House No.: | E-345/38 | | House No.: | E-346/34 | | House No.: | E-346/34 | |
| Age: | 27 | Sex: Male | Age: | 59 | Sex: Male | Age: | 56 | Sex: Female |

Section No.:002)Gattigere Gram tana Gattigere Revenu, , Ward No: 160 -560098 Continued

| | | | | | |
|-----------------|--------------------|-----------------|----------------------|-----------------|---------------------|
| 771 | REJ3643806 | 772 | REJ1252592 | 773 | REJ1252584 |
| Name : | Vyasaraja R N | Name : | Parashu Ramabetageri | Name : | Parimala Betageri |
| Father's Name: | Ramachandra | Father's Name: | Raghavendra Rao | Husband's Name: | Parashuram Betageri |
| House No.: | E-346/34 | House No.: | E-348/32 | House No.: | E-348/32 |
| Age: | 27 | Age: | 55 | Age: | 54 |
| Sex: | Male | Sex: | Male | Sex: | Female |
| 774 | REJ0760991 | 775 | REJ5342464 | 776 | REJ5349063 |
| Name : | Shashikumar | Name : | Rekha | Name : | Ramesh Arun |
| Father's Name: | Nagaraju S. L | Husband's Name: | Ramesh Arun | Father's Name: | Arunachalam |
| House No.: | E-350 | House No.: | E-350 | House No.: | E-350 |
| Age: | 45 | Age: | 37 | Age: | 40 |
| Sex: | Male | Sex: | Female | Sex: | Male |
| 777 | REJ3643921 | 778 | REJ5342449 | 779 | REJ0759191 |
| Name : | Rajakumarswamy | Name : | Rajeshwari | Name : | Chandrashekhar G |
| Father's Name: | Chidanandaswamy | Husband's Name: | Rajakumarswami | Father's Name: | Gurusiddichara |
| House No.: | E-350/54 | House No.: | E-350/54 | House No.: | E-353/39 |
| Age: | 48 | Age: | 43 | Age: | 76 |
| Sex: | Male | Sex: | Female | Sex: | Male |
| 780 | REJ0593053 | 781 | REJ0593061 | 782 | REJ0759183 |
| Name : | Chandramma | Name : | Mohan Kumar S. C | Name : | Vinoda Kumar S. C |
| Husband's Name: | Chandrashekhar G | Father's Name: | Chandrashekhar G | Father's Name: | Chandrashekhar |
| House No.: | E-353/39 | House No.: | E-353/39 | House No.: | E-353/39 |
| Age: | 66 | Age: | 39 | Age: | 32 |
| Sex: | Female | Sex: | Male | Sex: | Male |
| 783 | REJ0584581 | 784 | REJ0584573 | 785 | REJ1250265 |
| Name : | Sathish G. R | Name : | Vijayalakshmi S. B. | Name : | Shrinathareddi |
| Father's Name: | Ramabhadraiah T | Husband's Name: | Sathish G. R | Father's Name: | Ramachandrareddy |
| House No.: | E-355/25 | House No.: | E-355/25 | House No.: | E-358/819 |
| Age: | 55 | Age: | 47 | Age: | 49 |
| Sex: | Male | Sex: | Female | Sex: | Male |
| 786 | REJ1250273 | 787 | REJ1200880 | 788 | REJ1051697 |
| Name : | Ushareddi | Name : | T.G.Ramanath | Name : | Ganapathi Hegade |
| Husband's Name: | Shrinathareddi | Father's Name: | Gopalakrishna | Father's Name: | Manjunatha Hegade |
| House No.: | E-358/819 | House No.: | E-359/9/18 | House No.: | E-360/17 |
| Age: | 44 | Age: | 71 | Age: | 45 |
| Sex: | Female | Sex: | Male | Sex: | Male |
| 789 | REJ1051705 | 790 | REJ1051713 | 791 | REJ1202720 |
| Name : | Prathibha Hegade | Name : | Lakshmeesha Hegade | Name : | Prakash Prabhu |
| Husband's Name: | Ganapathi Hegade | Father's Name: | Manjunatha Hegade | Father's Name: | Balakrishnaprabhu.V |
| House No.: | E-360/17 | House No.: | E-360/17 | House No.: | E-361/15 |
| Age: | 38 | Age: | 38 | Age: | 52 |
| Sex: | Female | Sex: | Male | Sex: | Male |
| 792 | REJ1202738 | 793 | REJ3644051 | 794 | REJ3644069 |
| Name : | Radikaprabhu | Name : | Basavaraju D.B.. | Name : | Drakshayini |
| Husband's Name: | Prakash Prabhu | Father's Name: | Bummanna | Husband's Name: | Basavaraju D.B.. |
| House No.: | E-361/15 | House No.: | E-361/15 | House No.: | E-361/15 |
| Age: | 47 | Age: | 41 | Age: | 35 |
| Sex: | Female | Sex: | Male | Sex: | Female |
| 795 | REJ1250489 | 796 | REJ3644135 | 797 | REJ3644143 |
| Name : | Vidya Amarnath B N | Name : | Venkatesh | Name : | Alamelu N |
| Husband's Name: | Amarnath B..N | Father's Name: | Kannan | Husband's Name: | Venkatesh K |
| House No.: | E-362/14 | House No.: | E-363 | House No.: | E-363 |
| Age: | 34 | Age: | 45 | Age: | 37 |
| Sex: | Female | Sex: | Male | Sex: | Female |
| 798 | REJ3644168 | 799 | REJ3644283 | 800 | REJ3644291 |
| Name : | Bhagyaraj K | Name : | Virupakshaiah | Name : | G.Gayathri |
| Father's Name: | Kannan B | Father's Name: | Lingaiiah | Husband's Name: | Virupakshaiah |
| House No.: | E-363 | House No.: | E-365/2/82 | House No.: | E-365/2/82 |
| Age: | 29 | Age: | 54 | Age: | 53 |
| Sex: | Male | Sex: | Male | Sex: | Female |

Section No.:002)Gattigere Gram tana Gattigere Revenu, , Ward No: 160 -560098 Continued

| | | | | | | | | |
|-----|------------|---|-----|------------|---|-----|------------|--|
| 801 | REJ3644325 | Name : Lakshmidevi Husband's Name: Giriyappa House No.:E-366/81 Age: 62 Sex: Female | 802 | REJ0752568 | Name : G.Ramachandrappa Father's Name: Giriyappa House No.:E-366/81 Age: 48 Sex: Male | 803 | REJ0752576 | Name : Nagaveni Husband's Name: Ramachandrappa House No.:E-366/81 Age: 34 Sex: Female |
| 804 | REJ1201631 | Name : Mahalakshmi Husband's Name: Kumar House No.:E-367/72 Age: 40 Sex: Female | 805 | REJ0583559 | Name : Harini Husband's Name: Muralimohan House No.:E-370/5 G Age: 50 Sex: Female | 806 | REJ5342340 | Name : Muralimohan Father's Name: Ramaswamy Iyengar House No.:E-370/103 Age: 60 Sex: Male |
| 807 | REJ1204965 | Name : Babu Father's Name: Kurubada B.. M House No.:E-377/3/I Age: 69 Sex: Male | 808 | REJ1205111 | Name : Lakshmi Husband's Name: Babu House No.:E-377/3/I Age: 68 Sex: Female | 809 | REJ1205129 | Name : Ram K. S. V Father's Name: Babu House No.:E-377/3/I Age: 42 Sex: Male |
| 810 | REJ1204700 | Name : Sheela M. S Husband's Name: Ramu K. S. N House No.:E-377/3/I Age: 37 Sex: Female | 811 | REJ0754085 | Name : Venkatesha Father's Name: Sidda Bovi House No.:E-378/1/73 Age: 34 Sex: Male | 812 | REJ0754077 | Name : Gayathri Husband's Name: Venkatesh House No.:E-378/1/73 Age: 38 Sex: Female |
| 813 | REJ0754432 | Name : Shivanna Father's Name: Sidda Bovi House No.:E-378/1/73 Age: 26 Sex: Male | 814 | REJ0754069 | Name : Jayamma Husband's Name: Venkataramu House No.:E-378/1/93 Age: 67 Sex: Female | 815 | REJ0754028 | Name : Kumar A Father's Name: Anna Bovi House No.:E-378/73 Age: 45 Sex: Male |
| 816 | REJ0754036 | Name : Bhagya V Husband's Name: Kumar A House No.:E-378/73 Age: 42 Sex: Female | 817 | REJ3644705 | Name : Girish Father's Name: Venkataramu House No.:E-378/73 Age: 31 Sex: Male | 818 | REJ0584359 | Name : Ramurthy R. Father's Name: Ramanna House No.:E-379/2/A Age: 45 Sex: Male |
| 819 | REJ0584375 | Name : Ramesh Father's Name: Narayanappa House No.:E-379/2/A Age: 32 Sex: Male | 820 | REJ0584383 | Name : Shruthi.B.J Husband's Name: RAMESH.N House No.:E-379/2/A Age: 23 Sex: Female | 821 | REJ1200997 | Name : Jeeth Ban Father's Name: Motho House No.:E-380/57 Age: 77 Sex: Male |
| 822 | REJ1254556 | Name : Sonam Nidevi Husband's Name: Jeeth Khan House No.:E-380/57 Age: 72 Sex: Female | 823 | REJ1200989 | Name : Jagannatha J. M. Father's Name: Jeeth Khan House No.:E-380/57 Age: 47 Sex: Male | 824 | REJ1201078 | Name : Vimala Husband's Name: Jagannatha House No.:E-380/57 Age: 45 Sex: Female |
| 825 | REJ1056829 | Name : Mohan Kumar Father's Name: Mayanna Shetty House No.:E-382/2/22 Age: 39 Sex: Male | 826 | REJ1056837 | Name : Veena Husband's Name: Mohan Kumar House No.:E-382/2/22 Age: 34 Sex: Female | 827 | REJ0584391 | Name : Savitha Husband's Name: Shekhara House No.:E-382/225/ Age: 38 Sex: Female |
| 828 | REJ1251297 | Name : Prabhakar M.V Father's Name: Venkata Subbarao House No.:E-384/7/A Age: 50 Sex: Male | 829 | REJ1200682 | Name : Nirmala K. Husband's Name: Prabakar House No.:E-384/7/A Age: 43 Sex: Female | 830 | REJ3644747 | Name : Jagadeesh Purohit Father's Name: Sri Kethaji Raj Purohit House No.:E-384/7/A Age: 30 Sex: Male |

Section No.:002)Gattigere Gram tana Gattigere Revenu, , Ward No: 160 -560098 Continued

| | | | | | | | | |
|-----|------------|--|-----|------------|--|-----|------------|--|
| 831 | REJ3644754 | Name : Kamala Raj Purohit Husband's Name: Jagdeesha House No.:E-384/7/A Age: 27 Sex: Female | 832 | REJ1201276 | Name : Jayashri Prabhakara M P Father's Name: Prabhakar House No.:E-384/7/A Age: 26 Sex: Female | 833 | REJ4785226 | Name : K Shivaram Father's Name: K B Kundar House No.:469 Age: 30 Sex: Male |
| 834 | REJ3644895 | Name : Usha Ravishankar S Husband's Name: Ravishankar S House No.:558 Age: 51 Sex: Female | 835 | REJ3644903 | Name : Alok Nand.R Father's Name: Ravishankar S House No.:558 Age: 24 Sex: Male | 836 | REJ3644911 | Name : Ravishankar S Father's Name: Srinivasa Murthy P House No.:558 Age: 58 Sex: Male |
| 837 | REJ3644929 | Name : Abhilash R Father's Name: Ravishankar S House No.:558 Age: 27 Sex: Male | 838 | REJ4400404 | Name : Vasudha S Patil Father's Name: Suresh Patil B House No.:561 Age: 27 Sex: Female | 839 | REJ3644937 | Name : Santhosh V Father's Name: Venkatachalam House No.:568 Age: 40 Sex: Male |
| 840 | MCL2014306 | Name : Chokkalingam B. S Father's Name: Sundarachar House No.:575 Age: 67 Sex: Male | 841 | MCL2014314 | Name : Sowbhagya Vali Husband's Name: Chokkalingam B. S House No.:575 Age: 67 Sex: Female | 842 | REJ3644945 | Name : Kalidas C Father's Name: Chokkalingam B. S House No.:575 Age: 42 Sex: Male |
| 843 | MCL4463600 | Name : Anitha K Husband's Name: Kalidas C House No.:575 Age: 38 Sex: Female | 844 | REJ3644952 | Name : Shylesh Lingayath Father's Name: Rudraiah Lingayath House No.:575 Age: 55 Sex: Male | 845 | REJ3644960 | Name : Renuka Husband's Name: Shylesh Lingayath House No.:575 Age: 49 Sex: Female |
| 846 | REJ3644978 | Name : Hemalatha Husband's Name: Vinod House No.:603 Age: 34 Sex: Female | 847 | REJ3644986 | Name : Rita Husband's Name: Bipin House No.:603 Age: 28 Sex: Female | 848 | REJ3644994 | Name : Ashwin Patel Father's Name: Shivadas House No.:603 Age: 27 Sex: Male |
| 849 | REJ3645009 | Name : Mahadev D Father's Name: Devaraj House No.:627 Age: 60 Sex: Male | 850 | REJ3645017 | Name : Basanthi D M Father's Name: Mahadev D House No.:627 Age: 26 Sex: Female | 851 | REJ3645025 | Name : Nandish D M Father's Name: Mahadev D House No.:627 Age: 24 Sex: Male |
| 852 | REJ3645033 | Name : Kumar D M Father's Name: Mahadev D House No.:627 Age: 30 Sex: Male | 853 | REJ3645041 | Name : Gopinath R Father's Name: Late. Ramaiah House No.:631 Age: 63 Sex: Male | 854 | MCL4503934 | Name : Sridevi G Husband's Name: Gopinath R House No.:631 Age: 53 Sex: Female |
| 855 | MCL4503926 | Name : Hamsa G Father's Name: Gopinath R House No.:631 Age: 30 Sex: Female | 856 | REJ3645058 | Name : Bangaraswamy N Father's Name: Nagarajaiah M House No.:649 Age: 56 Sex: Male | 857 | REJ3645074 | Name : Jagannath R Father's Name: Parthasarathi C J House No.:687 Age: 68 Sex: Male |
| 858 | REJ3645082 | Name : Gajalakshmi R Husband's Name: Jagannath R House No.:687 Age: 62 Sex: Female | 859 | REJ3645090 | Name : Vijayamma R Husband's Name: Rayan C J House No.:687 Age: 67 Sex: Female | 860 | REJ3645108 | Name : Venkataramana Shetty Father's Name: LATE JAVARAYI SHETTY House No.:690 Age: 63 Sex: Male |

Section No.:002)Gattigere Gram tana Gattigere Revenu, , Ward No: 160 -560098 Continued

| | | | | | | | | |
|-----|------------|--|-----|------------|---|-----|------------|---|
| 861 | REJ3645116 | Name : Venkatalakshamma Husband's Name: Venkataraman Shetty House No.:690 Age: 54 Sex: Female | 862 | REJ3645124 | Name : Manjunatha V Father's Name: Venkataraman Shetty House No.:690 Age: 34 Sex: Male | 863 | REJ3645132 | Name : Raghuvir V Father's Name: Venkataraman Shetty House No.:690 Age: 31 Sex: Male |
| 864 | REJ3645165 | Name : Manjula Nagaraj Husband's Name: Nagaraj Rao M House No.:706 Age: 64 Sex: Female | 865 | REJ3645173 | Name : Rohith M N Father's Name: Nagaraj Rao M House No.:706 Age: 34 Sex: Male | 866 | REJ3645181 | Name : Valsa Kumar K N Father's Name: Panikar K E N House No.:728 Age: 50 Sex: Male |
| 867 | REJ3645199 | Name : Rekha Valsa Kumar Husband's Name: Valsa Kumar K N House No.:728 Age: 45 Sex: Female | 868 | REJ3645207 | Name : Ganashree B B Father's Name: Basavanthappa House No.:730 Age: 32 Sex: Female | 869 | REJ3645215 | Name : Suhas T S Father's Name: Shrinidhi T K House No.:731 Age: 25 Sex: Male |
| 870 | MCL4504262 | Name : Venkatalakshamma Husband's Name: Krishnan D House No.:746 Age: 63 Sex: Female | 871 | MCL2015097 | Name : Sandhya K Husband's Name: Ramesh House No.:746 Age: 40 Sex: Female | 872 | REJ3645264 | Name : Ramesh K H Father's Name: Hanumanthaiah S House No.:756 Age: 43 Sex: Male |
| 873 | REJ3645272 | Name : Manjula P.B Husband's Name: RAMESH K.H House No.:756 Age: 42 Sex: Female | 874 | REJ3645280 | Name : Manjisha R Father's Name: Late. Raveesh House No.:789 Age: 24 Sex: Male | 875 | MBQ7037617 | Name : Sendil Father's Name: Nagarajan House No.:799 Age: 40 Sex: Male |
| 876 | MBQ7037609 | Name : Leelavani Husband's Name: Sendil House No.:799 Age: 38 Sex: Female | 877 | REJ3645298 | Name : Chaitra Husband's Name: Suresh House No.:814 Age: 34 Sex: Female | 878 | REJ3645306 | Name : Divakar V G Father's Name: Late. Govindachar House No.:822 Age: 50 Sex: Male |
| 879 | REJ3645314 | Name : Sunitha V Hegde Husband's Name: Vinay Hegde House No.:838 Age: 39 Sex: Female | 880 | REJ3645322 | Name : Vinay Hegde Father's Name: Raviraj Hegde House No.:838 Age: 44 Sex: Male | 881 | REJ3645330 | Name : Nithin Gupta Father's Name: Chandraprakash House No.:838 Age: 35 Sex: Male |
| 882 | REJ3645348 | Name : Shilpa Gupta Husband's Name: Nithin Gupta House No.:838 Age: 30 Sex: Female | 883 | REJ3645355 | Name : Kaveramma M S Husband's Name: Somaiah M M House No.:838 Age: 30 Sex: Female | 884 | REJ3645363 | Name : Mohanakshi H.N Husband's Name: Venkatesh K N House No.:840 Age: 42 Sex: Female |
| 885 | REJ3645371 | Name : Ramaiah N Father's Name: Late. Narayanappa House No.:840 Age: 40 Sex: Male | 886 | REJ3645389 | Name : Lalitha K R Husband's Name: Ramaiah N House No.:840 Age: 32 Sex: Female | 887 | REJ1253806 | Name : Suman Sharma Husband's Name: Late. Mahendra Kumar Sharma House No.:891/54 Age: 43 Sex: Female |
| 888 | REJ3644499 | Name : Ravish Kumar Father's Name: Rudrananda Singh House No.:1052 Age: 33 Sex: Male | 889 | REJ3644549 | Name : Amar Kantharaj Father's Name: Kantharaj R N House No.:1166 Age: 41 Sex: Male | 890 | REJ3644556 | Name : Chethan Father's Name: Ramesh Chandraparik House No.:1183 Age: 24 Sex: Male |

Section No.:002)Gattigere Gram tana Gattigere Revenu, , Ward No: 160 -560098 Continued

| | | | | | | | | |
|----------------|------------------|-----------|-----------------|----------------|-------------|----------------|----------------|-------------|
| 891 | REJ3644572 | | 892 | REJ5342373 | | 893 | REJ3644614 | |
| Name : | Mariswamy G R | | Name : | Dhanalakshmi K | | Name : | Ashwini Bhat M | |
| Father's Name: | Late. Rangegowda | | Husband's Name: | Mariswamy G R | | Father's Name: | Shyam Bhat | |
| House No.: | 1188 | | House No.: | 1188 | | House No.: | 1240 | |
| Age: | 55 | Sex: Male | Age: | 48 | Sex: Female | Age: | 24 | Sex: Female |
| 894 | REJ5633789 | | 895 | REJ5633599 | | 896 | REJ4993341 | |
| Name : | Vinod.K.V | | Name : | Pramod | | Name : | Trilok.S | |
| Father's Name: | VIJAYA KUMAR | | Father's Name: | CHANNASOMIAH | | Father's Name: | Srinivasiah.P | |
| House No.: | 1429 | | House No.: | 1429 | | House No.: | 1431 | |
| Age: | 22 | Sex: Male | Age: | 20 | Sex: Male | Age: | 22 | Sex: Male |

Supplement No. :1

Mother Roll : Basic (Mother) Roll of 2014
 Supplement Process & Year : Summary Revision - 2014
 Supplement Type : Lists of Additions, Deletions & Corrections

I) Additions List

Section No.:002)Gattigere Gram tana Gattigere
 Revenu, , Ward No: 160 -560098

897

REJ6261705

Name : Sunitha

Husband's Name: shivu

House No.: 04 ngef layout main
 Age: 26 Sex: Female

Male

Female

Others

Total

No. of Additions

0

1

0

1

II) Deletions List

II) Deletions Nil

III) Modifications List

III) Modifications Nil

Supplement No. :2

Mother Roll :

Basic (Mother) Roll of 2014

Supplement Process & Year :

Summary Revision - 2014

Supplement Type :

Lists of Additions, Deletions & Corrections

I) Additions List

I) Additions Nil

II) Deletions List

Section No.:001)B E M L Layout, , Ward No: 160 -560098

| | | | | | |
|------------------------------------|-------------|--------------------------------|-------------|-------------------------------|-------------|
| R 7 | REJ6102313 | R 10 | REJ6154561 | R 12 | REJ6140537 |
| Name : Chandra | | Name : Chandra | | Name : Chandra | |
| Husband's Name: PERUMAL | | Husband's Name: PERUMAL | | Father's Name: PERUMAL | |
| House No.: 01 Age: 25 | Sex: Female | House No.: 01 Age: 28 | Sex: Female | House No.: 1 Age: 25 | Sex: Female |
| R 23 | REJ6083950 | R 45 | REJ6128995 | R 71 | REJ6181119 |
| Name : Shilpi Bandil | | Name : Mani.R | | Name : Satish | |
| Husband's Name: AMIT BANDIL | | Father's Name: R.ANJALI | | Father's Name: Mani | |
| House No.: A3 Age: 31 | Sex: Female | House No.: 09 Age: 19 | Sex: Male | House No.: 17 Age: 24 | Sex: Male |
| R 95 | REJ5975594 | R 141 | REJ6191365 | R 160 | REJ6033070 |
| Name : Kotreshappa.K | | Name : Aruna.S | | Name : Prajna Hegade | |
| Father's Name: KAREGOWDA | | Father's Name: SIDDALINGAPPA.S | | Father's Name: VENKATAGIRI | |
| House No.: 23 Age: 31 | Sex: Male | House No.: 36 Age: 21 | Sex: Male | House No.: 42 Age: 25 | Sex: Female |
| R 166 | REJ6095350 | R 220 | REJ6089833 | R 224 | REJ6074272 |
| Name : Anasuya Hegade | | Name : Shashi Kumar.C | | Name : Chandra Bayi | |
| Husband's Name: VENKATAGIRI HEGADE | | Father's Name: CHOWDAPPA | | Husband's Name: N.MUKUNDA RAO | |
| House No.: 42 Age: 57 | Sex: Female | House No.: 84 Age: 23 | Sex: Male | House No.: 85 Age: 46 | Sex: Female |
| R 257 | REJ6094643 | R 266 | REJ6197149 | R 267 | REJ6161459 |
| Name : Nagaraju.K | | Name : Basavaiah | | Name : Basavaiah | |
| Father's Name: KENCHAPPA | | Father's Name: KUNTAIAH | | Father's Name: KUNTAIAH | |
| House No.: 115 Age: 34 | Sex: Male | House No.: 173/4 Age: 41 | Sex: Male | House No.: 173/4 Age: 41 | Sex: Male |
| R 309 | REJ6071948 | | | | |
| Name : Shailaja Kori | | | | | |
| Husband's Name: RAVINDRANATH KORI | | | | | |
| House No.: 306 Age: 30 | Sex: Female | | | | |

Section No.:002)Gattigere Gram tana Gattigere
Revenu, , Ward No: 160 -560098

R 715 REJ6071674

Name : Govindarajan
Subramanian
SUBRAMANIAN
Father's
Name:
House No.: 281,B-305
Age: 29 Sex: Male



Male

Female

Others

Total

No. of Deletions

9

8

0

17

III) Modifications List

Section No.:001)B E M L Layout, , Ward No: 160 -
560098

22 REJ5945464

Name : Arun Chakravarty Sethu
Father's
Name: Sethu Chakravarty
House No.: 3
Age: 37 Sex: Male



Section No.:002)Gattigere Gram tana Gattigere
Revenu, , Ward No: 160 -560098

362 REJ5633045

Name : D.Chowdaiah
Father's
Name: LATE.DEVARAIAH
House No.: 945
Age: 95 Sex: Male



Male

Female

Others

Total

No. of Modifications

2

0

0

2

Supplement No. :3

Mother Roll :

Basic (Mother) Roll of 2014

Supplement Process & Year :

Continuous Updation 2014
(01-02-2014 to 26-03-2014)

Supplement Type :

Lists of Additions, Deletions &
Corrections

I) Additions List

Section No.:001)B E M L Layout, , Ward No: 160 -560098

| | | | | | | | | |
|-----------------|------------------------|-------------|-----------------|----------------------|-------------|-----------------|---------------------------|-------------|
| 898 | REJ6695332 | | 899 | REJ6695274 | | 900 | REJ6695654 | |
| Name : | Manohar | | Name : | Kundan Kumar | | Name : | Ramesh M | |
| Father's Name: | M UMAPATHY | | Father's Name: | SRI KAPIL DEO PRASAD | | Father's Name: | Mutthu | |
| House No.: | #15,2ND MA | | House No.: | #46 | | House No.: | 01 | |
| Age: | 52 | Sex: Male | Age: | 30 | Sex: Male | Age: | 22 | Sex: Male |
| 901 | REJ6696504 | | 902 | REJ6696801 | | 903 | REJ6694301 | |
| Name : | Nandish | | Name : | Puttaraju | | Name : | Vindhya Sree M P | |
| Father's Name: | siddaramaiah c | | Father's Name: | Basavaraju | | Husband's Name: | nandish | |
| House No.: | 01 | | House No.: | 01 | | House No.: | 01 | |
| Age: | 28 | Sex: Male | Age: | 30 | Sex: Male | Age: | 23 | Sex: Female |
| 904 | REJ6696686 | | 905 | REJ6695761 | | 906 | REJ6694053 | |
| Name : | Ganneshan V | | Name : | R N Karthik | | Name : | Tulasi D | |
| Father's Name: | Vidyanathan | | Father's Name: | Ramesh Natarajan | | Husband's Name: | Ramesh natarajan | |
| House No.: | 03 | | House No.: | 04 | | House No.: | 04 | |
| Age: | 71 | Sex: Male | Age: | 18 | Sex: Male | Age: | 38 | Sex: Female |
| 907 | REJ6694251 | | 908 | REJ6694491 | | 909 | REJ6695530 | |
| Name : | Kavitha P | | Name : | Channaya | | Name : | P C Mahadevappa | |
| Husband's Name: | Pushparaj | | Father's Name: | pakirappa | | Father's Name: | Puttachannappa | |
| House No.: | 04 | | House No.: | 05 | | House No.: | 05 | |
| Age: | 27 | Sex: Female | Age: | 63 | Sex: Male | Age: | 68 | Sex: Male |
| 910 | REJ6694103 | | 911 | REJ6696520 | | 912 | REJ6561310 | |
| Name : | Nasreen Banu | | Name : | Sagar | | Name : | Sweta Bhuwania | |
| Husband's Name: | Sanaula | | Father's Name: | sachindra | | Father's Name: | Shree RajendraPrasad Agar | |
| House No.: | 07 | | House No.: | 08 | | House No.: | 09 | |
| Age: | 48 | Sex: Female | Age: | 22 | Sex: Male | Age: | 29 | Sex: Female |
| 913 | REJ6561807 | | 914 | REJ6696868 | | 915 | REJ6695902 | |
| Name : | Bhuvana V | | Name : | Bhagashree H | | Name : | Deepak N | |
| Father's Name: | Vadivelu | | Husband's Name: | A T Huchegowda | | Father's Name: | Nagaraj V | |
| House No.: | 1 | | House No.: | 1 | | House No.: | 10 | |
| Age: | 19 | Sex: Female | Age: | 24 | Sex: Female | Age: | 30 | Sex: Male |
| 916 | REJ6562599 | | 917 | REJ6694533 | | 918 | REJ6696025 | |
| Name : | Mahadevappa M C | | Name : | Radhambhika.K.P | | Name : | K R Srinath | |
| Father's Name: | late. N Chikkalingaiah | | Husband's Name: | Purushothama.Y.V | | Father's Name: | Ramachandra MURthy | |
| House No.: | 10 | | House No.: | 10 | | House No.: | 10A/57 | |
| Age: | 46 | Sex: Male | Age: | 29 | Sex: Female | Age: | 37 | Sex: Male |

Section No.:001)B E M L Layout, , Ward No: 160 -560098

| | | | | | | | | |
|-----------------|-------------------|-------------|-----------------|-----------------------|-------------|-----------------|-------------------------|-------------|
| 919 | REJ6696058 | | 920 | REJ6694921 | | 921 | REJ6560197 | |
| Name : | B S Ashwini | | Name : | Nadiya | | Name : | Sanju Kanwar | |
| Husband's Name: | K R Srinath | | Husband's Name: | Manigandan | | Husband's Name: | Ranveer Singh | |
| House No.: | 10A/57 | | House No.: | 11 | | House No.: | 11/6B | |
| Age: | 31 | Sex: Female | Age: | 21 | Sex: Female | Age: | 23 | Sex: Female |
| 922 | REJ6693907 | | 923 | REJ6696066 | | 924 | REJ6696488 | |
| Name : | Ishwarya S | | Name : | V Namagiri | | Name : | Shekar H | |
| Father's Name: | Srinivas Prasad | | Husband's Name: | G Venkatadas | | Father's Name: | honnappa | |
| House No.: | 1143 | | House No.: | 1143 | | House No.: | 115 | |
| Age: | 18 | Sex: Female | Age: | 70 | Sex: Female | Age: | 20 | Sex: Male |
| 925 | REJ6696223 | | 926 | REJ6694160 | | 927 | REJ6694087 | |
| Name : | Lakshamma C | | Name : | C Y Lakshminarasimhan | | Name : | C G Champakalakshmi | |
| Husband's Name: | shekar h | | Father's Name: | Yoganasimhaiah | | Husband's Name: | C Y Lakshminarasimhaiah | |
| House No.: | 115 | | House No.: | 12 | | House No.: | 12 | |
| Age: | 22 | Sex: Female | Age: | 44 | Sex: Male | Age: | 37 | Sex: Female |
| 928 | REJ6562102 | | 929 | REJ6561583 | | 930 | REJ6561690 | |
| Name : | Shobha P | | Name : | Suresh B S | | Name : | N Tejalakshmi | |
| Husband's Name: | Suresh B S | | Father's Name: | Somegowda | | Husband's Name: | M Lingappa | |
| House No.: | 12/2 | | House No.: | 12/2 | | House No.: | 12/8 | |
| Age: | 35 | Sex: Female | Age: | 43 | Sex: Male | Age: | 51 | Sex: Female |
| 931 | REJ6561195 | | 932 | REJ6695969 | | 933 | REJ6693931 | |
| Name : | M Lingaraju | | Name : | Raviprakash | | Name : | Vibas Venkataram | |
| Father's Name: | L Mahalingappa | | Father's Name: | Krishna | | Father's Name: | K V Balasubramanya | |
| House No.: | 12/8 | | House No.: | 12-3 | | House No.: | 1255 | |
| Age: | 62 | Sex: Male | Age: | 42 | Sex: Male | Age: | 26 | Sex: Male |
| 934 | REJ6694012 | | 935 | REJ6695886 | | 936 | REJ6695837 | |
| Name : | Raju | | Name : | S Vishwanag | | Name : | S H Shivashankar | |
| Father's Name: | Krishna | | Father's Name: | S H Shivashankar | | Father's Name: | S H darukacharya | |
| House No.: | 12-8 | | House No.: | 1288 | | House No.: | 1288 | |
| Age: | 40 | Sex: Male | Age: | 31 | Sex: Male | Age: | 72 | Sex: Male |
| 937 | REJ6696967 | | 938 | REJ6696900 | | 939 | REJ6696652 | |
| Name : | Sindhuj V | | Name : | Ramalal | | Name : | Chaithra B S | |
| Father's Name: | Vasanth Kumar E | | Father's Name: | Sujaram | | Husband's Name: | krishnamurthy b | |
| House No.: | 129 | | House No.: | 13 | | House No.: | 13 | |
| Age: | 19 | Sex: Female | Age: | 24 | Sex: Male | Age: | 22 | Sex: Female |
| 940 | REJ6694657 | | 941 | REJ6695175 | | 942 | REJ6562169 | |
| Name : | Pooja N S | | Name : | Kapoor | | Name : | Vasundara Devi B V | |
| Father's Name: | Shivalingaiah N H | | Father's Name: | Sujaram | | Husband's Name: | Shivalingaiah N H | |
| House No.: | 13 | | House No.: | 13 | | House No.: | 13 | |
| Age: | 18 | Sex: Female | Age: | 19 | Sex: Male | Age: | 40 | Sex: Female |
| 943 | REJ6562276 | | 944 | REJ6694384 | | 945 | REJ6562912 | |
| Name : | Lehari | | Name : | Sarita | | Name : | Yashaswini | |
| Husband's Name: | Makararam | | Father's Name: | shambhunath patel | | Husband's Name: | Anand Muralidhar | |
| House No.: | 13 | | House No.: | 13/4a | | House No.: | 131/73 | |
| Age: | 20 | Sex: Female | Age: | 33 | Sex: Female | Age: | 28 | Sex: Female |
| 946 | REJ6562615 | | 947 | REJ6695720 | | 948 | REJ6696165 | |
| Name : | Anand Muralidhar | | Name : | Basavaraju | | Name : | Kaveesh Kumar A K | |
| Father's Name: | Muralidhar A N | | Father's Name: | Nagarajaiah K M | | Father's Name: | krishnappa a p | |
| House No.: | 131/73 | | House No.: | 134 | | House No.: | 14 | |
| Age: | 35 | Sex: Male | Age: | 50 | Sex: Male | Age: | 42 | Sex: Male |

Section No.:001)B E M L Layout, , Ward No: 160 -560098

| | | | | | | | | |
|-----------------|---------------------|-------------|-----------------|-------------------|-------------|-----------------|-------------------|-------------|
| 949 | REJ6696389 | | 950 | REJ6559504 | | 951 | REJ6694285 | |
| Name : | Manjula K | | Name : | Laveesh Kumar A K | | Name : | Ramyia K M | |
| Husband's Name: | laveesh kumar a k | | Father's Name: | krishnappa gowda | | Husband's Name: | kaveesh kumar a k | |
| House No.: | 14 | | House No.: | 14 | | House No.: | 14 | |
| Age: | 30 | Sex: Female | Age: | 42 | Sex: Male | Age: | 28 | Sex: Female |
| 952 | REJ6694475 | | 953 | REJ6694343 | | 954 | REJ6694202 | |
| Name : | Pallavi | | Name : | Puja M | | Name : | M Rekha | |
| Husband's Name: | h n sharth kumar | | Father's Name: | u manohar | | Husband's Name: | u umapathy | |
| House No.: | 144 | | House No.: | 15 | | House No.: | 15 | |
| Age: | 25 | Sex: Female | Age: | 20 | Sex: Female | Age: | 43 | Sex: Female |
| 955 | REJ6559306 | | 956 | REJ6694392 | | 957 | REJ6694129 | |
| Name : | Manohar U | | Name : | Sudha M | | Name : | Jayashree | |
| Father's Name: | m umapathy | | Father's Name: | maju c | | Husband's Name: | H C Nagaraj | |
| House No.: | 15 | | House No.: | 155 | | House No.: | 156 | |
| Age: | 52 | Sex: Male | Age: | 33 | Sex: Female | Age: | 39 | Sex: Female |
| 958 | REJ6694442 | | 959 | REJ6560742 | | 960 | REJ6695779 | |
| Name : | Lakshmi R S | | Name : | Akshay Kumar B C | | Name : | Akshata K R | |
| Father's Name: | m s krishna iyangar | | Father's Name: | Chandira D | | Husband's Name: | Umesha V G | |
| House No.: | 16 | | House No.: | 16 | | House No.: | 16 | |
| Age: | 60 | Sex: Female | Age: | 18 | Sex: Male | Age: | 26 | Sex: Female |
| 961 | REJ6695571 | | 962 | REJ6696611 | | 963 | REJ6694079 | |
| Name : | Umesh G | | Name : | Lakshmi.R.S | | Name : | Danyashree B K | |
| Father's Name: | Giriappa Gowda | | Husband's Name: | Srinivas.R | | Father's Name: | R Kumar | |
| House No.: | 16 | | House No.: | 16/D | | House No.: | 161 | |
| Age: | 29 | Sex: Male | Age: | 60 | Sex: Female | Age: | 22 | Sex: Female |
| 964 | REJ6560064 | | 965 | REJ6695910 | | 966 | REJ6695100 | |
| Name : | Mangalagowramma | | Name : | Mahiboob | | Name : | B K Yogananda | |
| Husband's Name: | Hanumantharaju.K.P | | Father's Name: | Hajisab | | Father's Name: | Kempaiah | |
| House No.: | 17 | | House No.: | 179/B | | House No.: | 18 | |
| Age: | 30 | Sex: Female | Age: | 19 | Sex: Male | Age: | 28 | Sex: Male |
| 967 | REJ6696421 | | 968 | REJ6696884 | | 969 | REJ6560643 | |
| Name : | Manjunatha L | | Name : | B K Yogananda | | Name : | Naveenkumar | |
| Father's Name: | laksmappa k | | Father's Name: | Kempaiah | | Father's Name: | Kempaiah | |
| House No.: | 18 | | House No.: | 18 | | House No.: | 18 | |
| Age: | 45 | Sex: Male | Age: | 28 | Sex: Male | Age: | 26 | Sex: Male |
| 970 | REJ6560668 | | 971 | REJ6559355 | | 972 | REJ6562151 | |
| Name : | Kavitha T | | Name : | Ammaji R | | Name : | Vidya L J | |
| Husband's Name: | BK Yoganand | | Husband's Name: | I manjunatha | | Husband's Name: | Naveenkumar B K | |
| House No.: | 18 | | House No.: | 18 | | House No.: | 18 | |
| Age: | 24 | Sex: Female | Age: | 36 | Sex: Female | Age: | 27 | Sex: Female |
| 973 | REJ6561468 | | 974 | REJ6694624 | | 975 | REJ6695597 | |
| Name : | Kempaiah | | Name : | B N Nagarathna | | Name : | Kirankumar D | |
| Father's Name: | Kempanna | | Father's Name: | Kempaiah | | Father's Name: | Doddaiah | |
| House No.: | 18 | | House No.: | 18 | | House No.: | 181 | |
| Age: | 56 | Sex: Male | Age: | 53 | Sex: Male | Age: | 25 | Sex: Male |
| 976 | REJ6694350 | | 977 | REJ6695019 | | 978 | REJ6696835 | |
| Name : | Siddhartha | | Name : | Sowmyasreenath | | Name : | H Krishna | |
| Father's Name: | susanta | | Husband's Name: | P Sreenath | | Father's Name: | Hanumegowda | |
| House No.: | 187 | | House No.: | 187/202 | | House No.: | 19 | |
| Age: | 26 | Sex: Male | Age: | 20 | Sex: Female | Age: | 44 | Sex: Male |

Section No.:001)B E M L Layout, , Ward No: 160 -560098

| | | | | | |
|-------------------------------|-------------|---|-------------|------------------------------------|-------------|
| 979 | REJ6696348 | 980 | REJ6694269 | 981 | REJ6562060 |
| Name : Vinutha | | Name : Aravind | | Name : Jaisheela | |
| Father's Name: vishwanath r v | | Father's Name: bhaskar b k | | Husband's Name: H Krishna | |
| House No.: 19 Age: 27 | Sex: Female | House No.: 19 Age: 36 | Sex: Male | House No.: 19 Age: 33 | Sex: Female |
| 982 | REJ6694145 | 983 | REJ6693998 | 984 | REJ6695928 |
| Name : Raju | | Name : Geetha Mani | | Name : Padma | |
| Father's Name: Govindarajulu | | Husband's Name: Raju | | Father's Name: Raju | |
| House No.: 201 Age: 49 | Sex: Male | House No.: 201 Age: 48 | Sex: Female | House No.: 201 Age: 18 | Sex: Female |
| 985 | REJ6695795 | 986 | REJ6562300 | 987 | REJ6559256 |
| Name : Swathi | | Name : Pundarekaksha A | | Name : K R Arunkumar | |
| Husband's Name: Pundarikaksha | | Father's Name: Sadhashiva K | | Father's Name: k ramaroa | |
| House No.: 207 Age: 21 | Sex: Female | House No.: 207 Age: 36 | Sex: Male | House No.: 21 Age: 44 | Sex: Male |
| 988 | REJ6562573 | 989 | REJ6694368 | 990 | REJ6696199 |
| Name : Prathima N | | Name : B N Sudha | | Name : Roop N T | |
| Husband's Name: Raghavendra L | | Husband's Name: k r arun kumar | | Husband's Name: sridhar r sharma | |
| House No.: 21 Age: 32 | Sex: Female | House No.: 21 Age: 36 | Sex: Female | House No.: 23 Age: 37 | Sex: Female |
| 991 | REJ6696447 | 992 | REJ6559538 | 993 | REJ6559488 |
| Name : Sridhar R Sharma | | Name : Yashoda | | Name : B S Nethravathi | |
| Father's Name: ramachadra k | | Husband's Name: s chandrappa | | Husband's Name: girish r | |
| House No.: 23 Age: 42 | Sex: Male | House No.: 25 Age: 32 | Sex: Female | House No.: 26 Age: 31 | Sex: Female |
| 994 | REJ6696173 | 995 | REJ6696827 | 996 | REJ6562482 |
| Name : Girish R | | Name : Sneha V S | | Name : Raghunath V | |
| Father's Name: rangappa | | Husband's Name: Siddaramanagowda V | | Father's Name: Shailashree V Rao | |
| House No.: 26 Age: 36 | Sex: Male | House No.: 26 Age: 18 | Sex: Female | House No.: 27 Age: 20 | Sex: Male |
| 997 | REJ6695944 | 998 | REJ6695993 | 999 | REJ6695142 |
| Name : Manjula S | | Name : Geetha | | Name : Nirmala M L | |
| Father's Name: Sampath | | Father's Name: Ganesha | | Husband's Name: Nagaraj C | |
| House No.: 281 Age: 32 | Sex: Female | House No.: 281 Age: 27 | Sex: Female | House No.: 281/4 Age: 41 | Sex: Female |
| 1000 | REJ6562391 | 1001 | REJ6695407 | 1002 | REJ6559694 |
| Name : Nagaraj C | | Name : Rajagopala Raman | | Name : Santhosh | |
| Father's Name: Channappa | | Father's Name: SRINIVASA RAJAGOPALAN | | Husband's Name: Hema Ram Chowdhary | |
| House No.: 281/4 Age: 43 | Sex: Male | House No.: 281/7 Age: 60 | Sex: Male | House No.: 284 Age: 29 | Sex: Female |
| 1003 | REJ6694889 | 1004 | REJ6694798 | 1005 | REJ6695811 |
| Name : Milan | | Name : J Swamy Reddy | | Name : P Kasturamma | |
| Father's Name: subramani | | Father's Name: J Narayan Reddy | | Husband's Name: P V Sriramulu | |
| House No.: 287 Age: 21 | Sex: Male | House No.: 30 Age: 54 | Sex: Male | House No.: 303 Age: 65 | Sex: Female |
| 1006 | REJ6559397 | 1007 | REJ6560262 | 1008 | REJ6562987 |
| Name : Raghavendra | | Name : Sureshkumar K | | Name : Nanjesh C | |
| Father's Name: shamanna | | Father's Name: krishnan n | | Father's Name: Chikkaputtaiah | |
| House No.: 307 Age: 26 | Sex: Male | House No.: 316 Age: 37 | Sex: Male | House No.: 32 Age: 31 | Sex: Male |

Section No.:001)B E M L Layout, , Ward No: 160 -560098

| | | | | | |
|--|------------|--|------------|--|------------|
| 1009 | REJ6563035 | 1010 | REJ6693881 | 1011 | REJ6694335 |
| Name : Sowmya C | | Name : Arunkumar B V | | Name : Imroj Alam | |
| Husband's Name: Madeva M | | Father's Name: Venkatappa S M | | Father's Name: feroz alam | |
| House No.: 32 Age: 28 Sex: Female | | House No.: 32 Age: 44 Sex: Male | | House No.: 32 Age: 28 Sex: Male | |
| 1012 | REJ6694772 | 1013 | REJ6696926 | 1014 | REJ6696249 |
| Name : Gururaj B V | | Name : Mariya Arokyadas | | Name : Rathamma | |
| Father's Name: Venkatesh B T | | Father's Name: Varaprasadam | | Husband's Name: venkatappa | |
| House No.: 32 Age: 19 Sex: Male | | House No.: 32 Age: 38 Sex: Male | | House No.: 33 Age: 22 Sex: Female | |
| 1015 | REJ6695001 | 1016 | REJ6695126 | 1017 | REJ6560726 |
| Name : Vinod H | | Name : Vinod H | | Name : Vinod H | |
| Father's Name: Hanumanthegowda | | Father's Name: Hanumanthegowda | | Father's Name: Hanumanthegowda | |
| House No.: 35 Age: 29 Sex: Male | | House No.: 35 Age: 29 Sex: Male | | House No.: 35 Age: 24 Sex: Male | |
| 1018 | REJ6561526 | 1019 | REJ6561625 | 1020 | REJ6693824 |
| Name : Pruthvi Raj H | | Name : Gayathri S C | | Name : Nethravathi D | |
| Father's Name: Hanumanthegowda | | Husband's Name: Hanumanthegowda | | Husband's Name: Mallikarjuna C | |
| House No.: 35 Age: 32 Sex: Male | | House No.: 35 Age: 66 Sex: Female | | House No.: 36 Age: 23 Sex: Female | |
| 1021 | REJ6693832 | 1022 | REJ6561757 | 1023 | REJ6561963 |
| Name : Mallikarjuna C | | Name : Poornaiah C P | | Name : Pavan | |
| Father's Name: Chandrashekarappa | | Father's Name: Purohit M K | | Father's Name: Popornaiah C P | |
| House No.: 36 Age: 31 Sex: Male | | House No.: 38/1 Age: 61 Sex: Male | | House No.: 38/1 Age: 29 Sex: Male | |
| 1024 | REJ6696777 | 1025 | REJ6562722 | 1026 | REJ6694517 |
| Name : Sudha | | Name : Chailaram Choyal | | Name : Rathna.K.R | |
| Husband's Name: C P Poornaiah | | Father's Name: DAburam Choyal | | Husband's Name: Nagendra.S.C | |
| House No.: 38/1 Age: 51 Sex: Female | | House No.: 389/7 Age: 26 Sex: Male | | House No.: 39/187 Age: 25 Sex: Female | |
| 1027 | REJ6694327 | 1028 | REJ6696330 | 1029 | REJ6694582 |
| Name : Prithi Am | | Name : Bindhu Sree C N | | Name : P R Sudha | |
| Husband's Name: rajesh cm | | Father's Name: late nanjegowda c r | | Husband's Name: P s Manjunatha | |
| House No.: 400/29 Age: 23 Sex: Female | | House No.: 400/29 Age: 19 Sex: Female | | House No.: 402 Age: 19 Sex: Female | |
| 1030 | REJ6694608 | 1031 | REJ6695639 | 1032 | REJ6695670 |
| Name : P S Manjunatha | | Name : Roopa H L | | Name : Srinivasa P S | |
| Father's Name: P V Shamanna | | Husband's Name: Srinivasa P S | | Father's Name: Shamanna P V | |
| House No.: 402 Age: 43 Sex: Male | | House No.: 403 Age: 32 Sex: Female | | House No.: 403 Age: 41 Sex: Male | |
| 1033 | REJ6695878 | 1034 | REJ6696314 | 1035 | REJ6559876 |
| Name : Leelavathamma H S | | Name : Panner Selvam | | Name : Leelasri | |
| Husband's Name: Shamanna P V | | Father's Name: ethirajulu t k | | Husband's Name: Veerendra Kumar.K.B | |
| House No.: 403 Age: 72 Sex: Female | | House No.: 404 Age: 60 Sex: Male | | House No.: 405 Age: 30 Sex: Female | |
| 1036 | REJ6559835 | 1037 | REJ6562649 | 1038 | REJ6694194 |
| Name : Veena.K.S | | Name : Thilak Kumar B J | | Name : Manjunatha D | |
| Husband's Name: Chandan.A.S | | Father's Name: Jayaramegowda B N | | Father's Name: Chikkanna | |
| House No.: 412 Age: 32 Sex: Female | | House No.: 44 Age: 20 Sex: Male | | House No.: 44 Age: 51 Sex: Male | |

Section No.:001)B E M L Layout, , Ward No: 160 -560098

| | | | | | | | | |
|-----------------|-----------------------------|-------------|-----------------|------------------------------|-------------|-----------------|---|-------------|
| 1039 | REJ6562938 | | 1040 | REJ6696082 | | 1041 | REJ6695464 | |
| Name : | Thilak Kumar B J | | Name : | Shivakumara B N | | Name : | Ashok | |
| Father's Name: | jayamegowda B N | | Father's Name: | Nanjunda Shetty | | Father's Name: | Chechappa | |
| House No.: | 44 | | House No.: | 44 | | House No.: | 45 | |
| Age: | 20 | Sex: Male | Age: | 19 | Sex: Male | Age: | 35 | Sex: Male |
| 1042 | REJ6695258 | | 1043 | REJ6693683 | | 1044 | REJ6693733 | |
| Name : | Puttappa | | Name : | Hemavathi N G | | Name : | Lokesh N G | |
| Father's Name: | Channappa | | Husband's Name: | Manjunatha M | | Father's Name: | Late Govindappa N K | |
| House No.: | 45 | | House No.: | 45 | | House No.: | 45 | |
| Age: | 66 | Sex: Male | Age: | 39 | Sex: Female | Age: | 39 | Sex: Male |
| 1045 | REJ6696587 | | 1046 | REJ6696876 | | 1047 | REJ6561914 | |
| Name : | Chaithanya.P.S | | Name : | Prema T | | Name : | Srinivasa V | |
| Husband's Name: | Srinivas.P.R | | Husband's Name: | Thimmappa | | Father's Name: | Venkateshappa | |
| House No.: | 457 | | House No.: | 46 | | House No.: | 46 | |
| Age: | 23 | Sex: Female | Age: | 34 | Sex: Female | Age: | 33 | Sex: Male |
| 1048 | REJ6693915 | | 1049 | REJ6694046 | | 1050 | REJ6696041 | |
| Name : | Jamunashree | | Name : | Ravikumar G | | Name : | Mala | |
| Husband's Name: | Ravikumar G | | Father's Name: | Gundaiah | | Husband's Name: | Ravikumar V | |
| House No.: | 460 | | House No.: | 460 | | House No.: | 460 | |
| Age: | 26 | Sex: Female | Age: | 41 | Sex: Male | Age: | 43 | Sex: Female |
| 1051 | REJ6696017 | | 1052 | REJ6695852 | | 1053 | REJ6559934 | |
| Name : | Shivamma | | Name : | Akshay G Kini | | Name : | Suma.S | |
| Husband's Name: | Govindaiah | | Father's Name: | Ganesh Kini K | | Husband's Name: | Late.Manohar.P | |
| House No.: | 460 | | House No.: | 460 | | House No.: | 48 | |
| Age: | 70 | Sex: Female | Age: | 18 | Sex: Male | Age: | 37 | Sex: Female |
| 1054 | REJ6695977 | | 1055 | REJ6559991 | | 1056 | REJ6562227 | |
| Name : | Nandakumar S | | Name : | Sanjana.T.S | | Name : | Mutturaju H G | |
| Father's Name: | Subbaiah Nath | | Father's Name: | Suresh.T.R | | Father's Name: | Govindaiah | |
| House No.: | 488 | | House No.: | 49 | | House No.: | 49 | |
| Age: | 65 | Sex: Male | Age: | 19 | Sex: Female | Age: | 24 | Sex: Male |
| 1057 | REJ6562870 | | 1058 | REJ6562805 | | 1059 | REJ6562524 | |
| Name : | Girish S | | Name : | N Anuradha | | Name : | V Phanichandranath Chenji C V Venugopal | |
| Father's Name: | Srinivasa | | Husband's Name: | V Phanichandranath Chenji | | Father's Name: | | |
| House No.: | 49 | | House No.: | 5 | | House No.: | 5 | |
| Age: | 22 | Sex: Male | Age: | 37 | Sex: Female | Age: | 45 | Sex: Male |
| 1060 | REJ6696991 | | 1061 | REJ6697007 | | 1062 | REJ6560460 | |
| Name : | K S Varuni | | Name : | C P Puttaraj | | Name : | Sujaram | |
| Husband's Name: | V Panichandranath Chenji | | Father's Name: | V Panichandranath Chenji | | Father's Name: | Rainji | |
| House No.: | 5 | | House No.: | 5 | | House No.: | 5/29 | |
| Age: | 43 | Sex: Female | Age: | 22 | Sex: Male | Age: | 57 | Sex: Male |
| 1063 | REJ6560502 | | 1064 | REJ6560338 | | 1065 | REJ6560387 | |
| Name : | Misiribai | | Name : | S Kailash | | Name : | Sangeethakailash | |
| Husband's Name: | Sujaram | | Father's Name: | Sujaram | | Husband's Name: | S Kailas | |
| House No.: | 5/29 | | House No.: | 5/29 | | House No.: | 5/29 | |
| Age: | 51 | Sex: Female | Age: | 32 | Sex: Male | Age: | 29 | Sex: Female |
| 1066 | REJ6560593 | | 1067 | REJ6695555 | | 1068 | REJ6560528 | |
| Name : | Bishappa B Sunkad | | Name : | Prabhashankara | | Name : | Logambal | |
| Father's Name: | Maruthi Bishappa Sunkada | | Father's Name: | Mohan | | Husband's Name: | Ganeshan | |
| House No.: | 50 | | House No.: | 50/1 | | House No.: | 519 | |
| Age: | 63 | Sex: Male | Age: | 42 | Sex: Male | Age: | 63 | Sex: Female |

Section No.:001)B E M L Layout, , Ward No: 160 -560098

| | | | | | | | | |
|-----------------|------------------------|-------------|-----------------|---------------------------|-------------|-----------------|----------------------------|-------------|
| 1069 | REJ6694152 | | 1070 | REJ6695613 | | 1071 | REJ6697023 | |
| Name : | Byju J Raj | | Name : | Sreesha | | Name : | Sujana R Bhat | |
| Father's Name: | Jayaraj | | Husband's Name: | Byjuraj | | Husband's Name: | M K Ramachandra Bhat | |
| House No.: | 52 | | House No.: | 52 | | House No.: | 54 | |
| Age: | 35 | Sex: Male | Age: | 31 | Sex: Female | Age: | 36 | Sex: Female |
| 1072 | REJ6696413 | | 1073 | REJ6694020 | | 1074 | REJ6693980 | |
| Name : | Sujana Keerthi P | | Name : | Roopakala K S | | Name : | Dananjaya M | |
| Father's Name: | prabhu b m | | Husband's Name: | Dananjaya M | | Father's Name: | Muddegowda B | |
| House No.: | 54 | | House No.: | 54 | | House No.: | 54 | |
| Age: | 20 | Sex: Male | Age: | 35 | Sex: Female | Age: | 44 | Sex: Male |
| 1075 | REJ6561088 | | 1076 | REJ6696215 | | 1077 | REJ6696116 | |
| Name : | K Srinivas Achar | | Name : | K Padma | | Name : | V Kumar | |
| Father's Name: | Late T K Kalingachar | | Husband's Name: | v kumar | | Father's Name: | vaidyanathan k j | |
| House No.: | 54 | | House No.: | 56 | | House No.: | 56 | |
| Age: | 60 | Sex: Male | Age: | 58 | Sex: Female | Age: | 60 | Sex: Male |
| 1078 | REJ6693949 | | 1079 | REJ6562342 | | 1080 | REJ6696918 | |
| Name : | Paramesh R | | Name : | Chinnappa Madappa | | Name : | Harini Chinnappa | |
| Father's Name: | A P Rajappa nair | | Father's Name: | Madappa K | | Husband's Name: | Chinnappa Madappa | |
| House No.: | 57/1 | | House No.: | 57/10 | | House No.: | 57/10 | |
| Age: | 33 | Sex: Male | Age: | 47 | Sex: Male | Age: | 37 | Sex: Female |
| 1081 | REJ6696132 | | 1082 | REJ6696140 | | 1083 | REJ6562474 | |
| Name : | Basavaraj D. Sinnur | | Name : | Neeta Pattan | | Name : | Mahesh M | |
| Father's Name: | Dasharathagowda Sinnur | | Husband's Name: | Basavaraj Sinnur | | Father's Name: | mahadevappa D | |
| House No.: | 6 | | House No.: | 6 | | House No.: | 6 | |
| Age: | 44 | Sex: Male | Age: | 38 | Sex: Female | Age: | 41 | Sex: Male |
| 1084 | REJ6560221 | | 1085 | REJ6562755 | | 1086 | REJ6562839 | |
| Name : | Kamala Devi | | Name : | Dr. Mahalakshmi M | | Name : | Sheela Pal | |
| Husband's Name: | Pakaram | | Husband's Name: | Dr. Mahesh M | | Husband's Name: | Late Sudhakar | |
| House No.: | 6 | | House No.: | 6 | | House No.: | 6/3 | |
| Age: | 27 | Sex: Female | Age: | 38 | Sex: Female | Age: | 47 | Sex: Female |
| 1087 | REJ6562417 | | 1088 | REJ6696975 | | 1089 | REJ6696595 | |
| Name : | Rakshak Pal | | Name : | Pooja Pal | | Name : | Ramabai | |
| Mother's Name: | Sheela | | Mother's Name: | Sheela Pal | | Husband's Name: | Heeroji Rao | |
| House No.: | 6/3 | | House No.: | 6/3 | | House No.: | 61 | |
| Age: | 27 | Sex: Male | Age: | 18 | Sex: Female | Age: | 65 | Sex: Female |
| 1090 | REJ6696298 | | 1091 | REJ6694236 | | 1092 | REJ6695688 | |
| Name : | Jayateertha | | Name : | Vijayalakshmi | | Name : | N S Narasimha Shetty | |
| Father's Name: | purohitha m k | | Husband's Name: | jayateertha | | Father's Name: | M K Subbaiah | |
| House No.: | 63 | | House No.: | 63 | | House No.: | 665 | |
| Age: | 51 | Sex: Male | Age: | 43 | Sex: Female | Age: | 48 | Sex: Male |
| 1093 | REJ6696108 | | 1094 | REJ6696033 | | 1095 | REJ6695324 | |
| Name : | N Padma | | Name : | Vinutha S | | Name : | Smitha B J | |
| Husband's Name: | N S Narasimha Shetty | | Husband's Name: | Swamy M | | Husband's Name: | SOMASHEKAR B R | |
| House No.: | 665 | | House No.: | 687 | | House No.: | 69 | |
| Age: | 55 | Sex: Female | Age: | 31 | Sex: Female | Age: | 30 | Sex: Female |
| 1096 | REJ6696454 | | 1097 | REJ6694848 | | 1098 | REJ6694699 | |
| Name : | Somashekar B R | | Name : | Ramabai Deshapande | | Name : | Raghavendra Rao Deshapande | |
| Father's Name: | revanna | | Husband's Name: | Ragjavendra Rao Deshapand | | Father's Name: | Jeevan Rao Deshapande | |
| House No.: | 69 | | House No.: | 7/57 | | House No.: | 7/57 | |
| Age: | 22 | Sex: Male | Age: | 64 | Sex: Female | Age: | 75 | Sex: Male |

Section No.:001)B E M L Layout, , Ward No: 160 -560098

| | | | | | |
|--|------------|--|------------|---|------------|
| 1099 | REJ6695746 | 1100 | REJ6693964 | 1101 | REJ6695050 |
| Name : Shankara | | Name : Shivarathni | | Name : Ashwini | |
| Father's Name: Nanjegowda | | Husband's Name: Shankara | | Father's Name: Sohanlal | |
| House No.: 71 Age: 46 Sex: Male | | House No.: 71 Age: 38 Sex: Female | | House No.: 72 Age: 31 Sex: Male | |
| 1102 | REJ6696850 | 1103 | REJ6561401 | 1104 | REJ6560148 |
| Name : Prakash | | Name : Indira | | Name : Suma.V.M | |
| Father's Name: Panduranga | | Husband's Name: Prakash | | Husband's Name: Ravikumar.B.P | |
| House No.: 72/8 Age: 24 Sex: Male | | House No.: 72/8 Age: 27 Sex: Female | | House No.: 73 Age: 26 Sex: Female | |
| 1105 | REJ6561393 | 1106 | REJ6561252 | 1107 | REJ6560833 |
| Name : Shiva Mizar | | Name : S R Prabhakar | | Name : P Vikram | |
| Father's Name: Durgadas | | Father's Name: Late S G Ramachandrarao | | Father's Name: S R Prabhakar | |
| House No.: 73 Age: 28 Sex: Male | | House No.: 73 Age: 65 Sex: Male | | House No.: 73 Age: 30 Sex: Male | |
| 1108 | REJ6696728 | 1109 | REJ6695035 | 1110 | REJ6560619 |
| Name : Shantha Prabhakar | | Name : Sanja Mizar | | Name : P N Jayashree | |
| Husband's Name: S R Prabhakar | | Husband's Name: Shiva Mizar | | Father's Name: Gangavathi D B | |
| House No.: 73 Age: 59 Sex: Female | | House No.: 73 Age: 28 Sex: Female | | House No.: 73/53 Age: 33 Sex: Female | |
| 1111 | REJ6559215 | 1112 | REJ6560122 | 1113 | REJ6696645 |
| Name : N. Ramprasad | | Name : Rathamma.N | | Name : Basavaraju.B | |
| Father's Name: R. Narasimhan | | Father's Name: Ninganna | | Father's Name: Basavaiah | |
| House No.: 74 Age: 38 Sex: Male | | House No.: 75/1 Age: 43 Sex: Female | | House No.: 75/1 Age: 49 Sex: Male | |
| 1114 | REJ6696744 | 1115 | REJ6696306 | 1116 | REJ6694228 |
| Name : Hema L | | Name : Madhusudhan N V | | Name : Chakravarthy D N V | |
| Husband's Name: Manjunath | | Father's Name: venkatesh n | | Father's Name: venkataraman n | |
| House No.: 75/2 Age: 31 Sex: Female | | House No.: 77 Age: 27 Sex: Male | | House No.: 77 Age: 32 Sex: Male | |
| 1117 | REJ6561138 | 1118 | REJ6694566 | 1119 | REJ6693873 |
| Name : Vanishree V S Sonnad | | Name : Aparna Venkatraman | | Name : H Nagarathamma | |
| Father's Name: Veeresh E S Sonnad | | Husband's Name: Jambhe Raghavendra Hiregange | | Husband's Name: K N Sriguru Rao | |
| House No.: 78 Age: 18 Sex: Female | | House No.: 79 Age: 23 Sex: Female | | House No.: 796 Age: 65 Sex: Female | |
| 1120 | REJ6695506 | 1121 | REJ6696959 | 1122 | REJ6696264 |
| Name : K N Sriguru Rao | | Name : Anilkumar S | | Name : Annaya | |
| Father's Name: K Narayana Rao | | Father's Name: Siddappa | | Father's Name: hari | |
| House No.: 796 Age: 67 Sex: Male | | House No.: 81 Age: 19 Sex: Male | | House No.: 82 Age: 64 Sex: Male | |
| 1123 | REJ6559421 | 1124 | REJ6562714 | 1125 | REJ6696942 |
| Name : Susheela | | Name : Rajiv Gandhi | | Name : Sangeetha | |
| Husband's Name: annaya prabhu | | Father's Name: Sundar Raj | | Husband's Name: Rajiv Gandhi | |
| House No.: 82 Age: 58 Sex: Female | | House No.: 82/18 Age: 27 Sex: Male | | House No.: 82/18 Age: 30 Sex: Female | |
| 1126 | REJ6695217 | 1127 | REJ6695704 | 1128 | REJ6696363 |
| Name : Siddalingeshwar S A | | Name : Gangadhar M | | Name : Shibban | |
| Father's Name: SUNIL KUMAR V AYYANAGOUDAR | | Father's Name: Motigowda | | Father's Name: ranchandar | |
| House No.: 82/18 Age: 32 Sex: Male | | House No.: 85 Age: 40 Sex: Male | | House No.: 85 Age: 25 Sex: Male | |

Section No.:001)B E M L Layout, , Ward No: 160 -560098

| | | | | | | | | |
|-----------------|--------------------------------|-------------|-----------------|----------------------------|-------------|-----------------|------------------------|-------------|
| 1129 | REJ6694178 | | 1130 | REJ6696769 | | 1131 | REJ6695191 | |
| Name : | Manjamma G | | Name : | Madhavi Dasari | | Name : | Gopinath Desai | |
| Husband's Name: | Gangadhar | | Husband's Name: | Kadarappa Dasari | | Father's Name: | Kadirappa Desai | |
| House No.: | 85 | | House No.: | 92 | | House No.: | 92 | |
| Age: | 38 | Sex: Female | Age: | 22 | Sex: Female | Age: | 27 | Sex: Male |
| 1132 | REJ6696843 | | 1133 | REJ6696074 | | 1134 | REJ6696702 | |
| Name : | Naveen Kumar | | Name : | Pallavi | | Name : | Jayalakshmi S K | |
| Father's Name: | B N Ravindrachar | | Father's Name: | B S Sriram | | Father's Name: | krishnamurthy | |
| House No.: | 92/A | | House No.: | 920 | | House No.: | 929 | |
| Age: | 23 | Sex: Male | Age: | 36 | Sex: Female | Age: | 73 | Sex: Female |
| 1135 | REJ6695522 | | 1136 | REJ6693857 | | 1137 | REJ6697031 | |
| Name : | Chinnaswamy H K | | Name : | Vignesh C | | Name : | Ashalatha Ravindra | |
| Father's Name: | Kannaiah | | Father's Name: | Channaswamy H K | | Husband's Name: | Ravindra S | |
| House No.: | 93 | | House No.: | 93 | | House No.: | 94 | |
| Age: | 57 | Sex: Male | Age: | 25 | Sex: Male | Age: | 34 | Sex: Female |
| 1138 | REJ6560411 | | 1139 | REJ6559629 | | 1140 | REJ6560023 | |
| Name : | Avinash | | Name : | Bhavani.B.R | | Name : | Vallish Kumaraswami | |
| Father's Name: | Ashok | | Husband's Name: | Vallish Kumaraswami | | Father's Name: | Kumaraswamy.K.S | |
| House No.: | 98 | | House No.: | A-4 | | House No.: | A-4 | |
| Age: | 25 | Sex: Male | Age: | 31 | Sex: Female | Age: | 30 | Sex: Male |
| 1141 | REJ6559744 | | 1142 | REJ6696546 | | 1143 | REJ6562011 | |
| Name : | Kumaraswamy.K.S | | Name : | Gayithri.B.A | | Name : | Nagarathna Shetty | |
| Father's Name: | Subbarao.K.R | | Husband's Name: | Kumaraswamy.K.S | | Husband's Name: | Sudhakar Shety | |
| House No.: | A-4 | | House No.: | A-4 | | House No.: | B 105 | |
| Age: | 65 | Sex: Male | Age: | 58 | Sex: Female | Age: | 38 | Sex: Female |
| 1144 | REJ6694319 | | 1145 | REJ6695241 | | 1146 | REJ6693774 | |
| Name : | P.A. Ashwin | | Name : | Ravalanath Hiriadka | | Name : | Shailaja Kadleppanavar | |
| Father's Name: | E. Panner Selvam | | Mother's Name: | SUNANDA NAYAK | | Husband's Name: | VINAY KADLEPPANAVAR | |
| House No.: | B-404 | | House No.: | FLAT NO G1 | | House No.: | FLAT S2 | |
| Age: | 29 | Sex: Male | Age: | 30 | Sex: Male | Age: | 30 | Sex: Female |
| 1147 | REJ6696272 | | 1148 | REJ6693717 | | 1149 | REJ6695431 | |
| Name : | Ravalanath Hiriadka | | Name : | Ghanshyam B Gaud | | Name : | Sudhindra Kumar T N | |
| Father's Name: | Sunanda Nayak | | Father's Name: | BIRBAL RAJDHARI GAUD | | Father's Name: | NARASINGARAO T N | |
| House No.: | G1 | | House No.: | NO B-1 | | House No.: | NO TF 6 SAI DURGA APTS | |
| Age: | 31 | Sex: Male | Age: | 36 | Sex: Male | Age: | 52 | Sex: Male |
| 1150 | REJ6695381 | | 1151 | REJ6693790 | | 1152 | REJ6695480 | |
| Name : | Veda Sudhindra Kumar | | Name : | Sowmya Hr | | Name : | Nayana Wadavi | |
| Husband's Name: | SUDHINDRA KUMAR TEKALLI | | Husband's Name: | Ravishankar HS | | Husband's Name: | BINDUMADHAV WADAVI | |
| House No.: | NARSHINGA DURGA APTS PM KALYAN | | House No.: | No.871, 6th main 9th cross | | House No.: | SF305 | |
| Age: | 55 | Sex: Female | Age: | 27 | Sex: Female | Age: | 49 | Sex: Female |

Section No.:002)Gattigere Gram tana Gattigere Revenu, , Ward No: 160 -560098

| | | | | | | | | | |
|------------------|-------------------------|-------------|-----------------|-----------------------|-------------|----------------|----------------------|-------------|-------|
| 1153 | REJ6693816 | | 1154 | REJ6693741 | | 1155 | REJ6693691 | | |
| Name : | Neeti Raman | | Name : | Chitra Raman | | Name : | Swati Raman | | |
| Father's Name: | RAJAGOPALA RAMAN | | Husband's Name: | RAJAGOPALA RAMAN | | Father's Name: | RAJAGOPALA RAMAN | | |
| House No.: | 281/7 | | House No.: | 281/7 | | House No.: | 281/7 | | |
| Age: | 29 | Sex: Female | Age: | 52 | Sex: Female | Age: | 26 | Sex: Female | |
| 1156 | REJ6695373 | | 1157 | REJ6695308 | | 1158 | REJ6695449 | | |
| Name : | Ramya Krishna Kalidindi | | Name : | Krishna Prasad A | | Name : | Mukund Anand | | |
| Husband's Name: | VENKATA RAMESH RAJU | | Father's Name: | ANAND SUBBARAO | | Father's Name: | ANAND S SUBBARAO | | |
| House No.: | 6/H | | House No.: | 64 | | House No.: | 64 | | |
| Age: | 21 | Sex: Female | Age: | 21 | Sex: Male | Age: | 26 | Sex: Male | |
| 1159 | REJ6695209 | | 1160 | REJ6693766 | | 1161 | REJ6693667 | | |
| Name : | Bhagyalakshmi M S | | Name : | Savith Ghanshyam Gaud | | Name : | Brijesh B Gaud | | |
| Husband's Name: | SIDDALINGESHWAR S A | | Husband's Name: | GANSYAM B GAUD | | Father's Name: | BIRBAL RAJDHARI GAUD | | |
| House No.: | 82/18 | | House No.: | NO B-1 | | House No.: | NO B-1 | | |
| Age: | 30 | Sex: Female | Age: | 32 | Sex: Female | Age: | 32 | Sex: Male | |
| | | Male | | | Female | | | Others | Total |
| No. of Additions | | 135 | | | 129 | | | 0 | 264 |

II) Deletions List

II) Deletions Nil

III) Modifications List

III) Modifications Nil

| | | | | | | |
|---|--|------------------------------------|------------|--------------|---------------------|--------------|
| State Code & Name : S10 - KARNATAKA | | | | | | |
| No., Name and reservation Status of Assembly Constituency : | 154 - Rajarajeshwarinagar (Gen) | | | | Part No.:326 | |
| A) NUMBER OF ELECTORS | | | | | | |
| | Roll Identification | Roll Type | Men | Women | Others | Total |
| I) Original | Mother Roll | Basic (Mother) Roll of 2014 | 457 | 439 | 0 | 896 |
| II) Additions List | | | | | | |
| | Supplement - 1 | Summary Revision - 2014 | 0 | 1 | 0 | 1 |
| | Supplement - 2 | Summary Revision - 2014 | 0 | 0 | 0 | 0 |
| | Supplement - 3 | Continuous Updation 2014 | 135 | 129 | 0 | 264 |
| III) Deletions List | | | | | | |
| | Supplement - 1 | Summary Revision - 2014 | 0 | 0 | 0 | 0 |
| | Supplement - 2 | Summary Revision - 2014 | 9 | 8 | 0 | 17 |
| | Supplement - 3 | Continuous Updation 2014 | 0 | 0 | 0 | 0 |
| Net Electors in the Roll after Continuous Updation 2014 (I+II-III) | | | 583 | 561 | 0 | 1144 |

| | | |
|---------------------------------|----------------------------|---------------------------|
| B) NUMBER OF CORRECTIONS | | |
| Roll Type | Roll Identification | No. of Corrections |
| | | |
| Supplement - 1 | Summary Revision - 2014 | 0 |
| Supplement - 2 | Summary Revision - 2014 | 2 |
| Supplement - 3 | Continuous Updation 2014 | 0 |

Place **Rajarajeshwarinagar.**
Date **26-03-2014**

Electoral Registration Officer
154-Rajarajeshwarinagar Assembly Constituency
And
Revenue Officer, Bruhat Bangalore Mahanagar
Palike, Rajarajeshwarinagar
Zone,, Rajarajeshwarinagar.