

Electoral Roll - 2014

State - (S10) -Karnataka

| | | |
|--|-------------------------------|--------------|
| No.,Name and Reservation Status of Assembly Constituency | 154-Rajarajeshwarinagar (Gen) | Part No. 322 |
|--|-------------------------------|--------------|

| | |
|--|----------------------------|
| No.,Name and Reservation Status of Parliamentary Constituency(ies) in which the Assembly Constituency is located | 23 - Bangalore Rural (Gen) |
|--|----------------------------|

1. DETAILS OF REVISION

| | | |
|---------------------|------------------|-----------------------------|
| Year of Revision | 2014 | Roll Identification |
| Qualifying Date | 01-01-2014 | Basic (Mother) Roll of 2014 |
| Type of Revision | Summary Revision | |
| Date of Publication | 31-01-2014 | |

2. DETAILS OF PART & POLLING AREA

| | | | |
|--|--|----------------|----------------------------|
| No. & Name of the Sections in the Part | | | |
| 01 | Shani mahatma Road Bangarappanagar Hosakerehalli,Pincode - 560085 | Main Metro | Bangalore |
| 02 | Chandranna House Road Bangarappa nagar Hosakere Halli,Pincode - 560085 | Ward No. | 160 - Rajarajeshwari Nagar |
| 03 | th Shop House Road Hosakere Halli,Pincode - 560085 | Police Station | Rajarajeshwari Nagar |
| 04 | 5th Cross Hosakerehalli,Pincode - 560085 | | |
| 05 | 7th Cross Hosakere Halli,Pincode - 560085 | Taluka | |
| 06 | bamgarappa nagara,Pincode - 560085 | District | B.B.M.P (CENTRAL) |
| 07 | 6th Cross Hosakere Halli,. Pincode - 560085 | Pin Code | 560098 |

3. POLLING STATION DETAILS

| | | |
|---|---|---------|
| No. And Name of Polling Station | Type of Polling Station (Male/Female/General) | General |
| 322-Govt. Higher Primary School, Room No-4, Bangarappanagar Hosakerehalli Bangalore | | |
| Address of Polling Station | Number of Auxiliary Polling Stations in this Part | 0 |
| Govt. Higher Primary School Bangarappa Nagar , Hosakerehalli Room No 4 | | |

4. NUMBER OF ELECTORS

| Starting Sl. No. | Ending Sl.No. | Male | Female | Others | Total |
|------------------|---------------|------|--------|--------|-------|
| 1 | 839 | 412 | 427 | 0 | 839 |

No.,Name and Reservation Status of Assembly Constituency

154 - Rajarajeshwarinagar(GEN) Part No. 322

PART NO 322

ಬತ್ತಂತ್ರಿ ಕಾಲೇಜು ಭೂಮಿ



(ಬತ್ತಂತ್ರಿ ಕಾಲೇಜು ಭೂಮಿ)

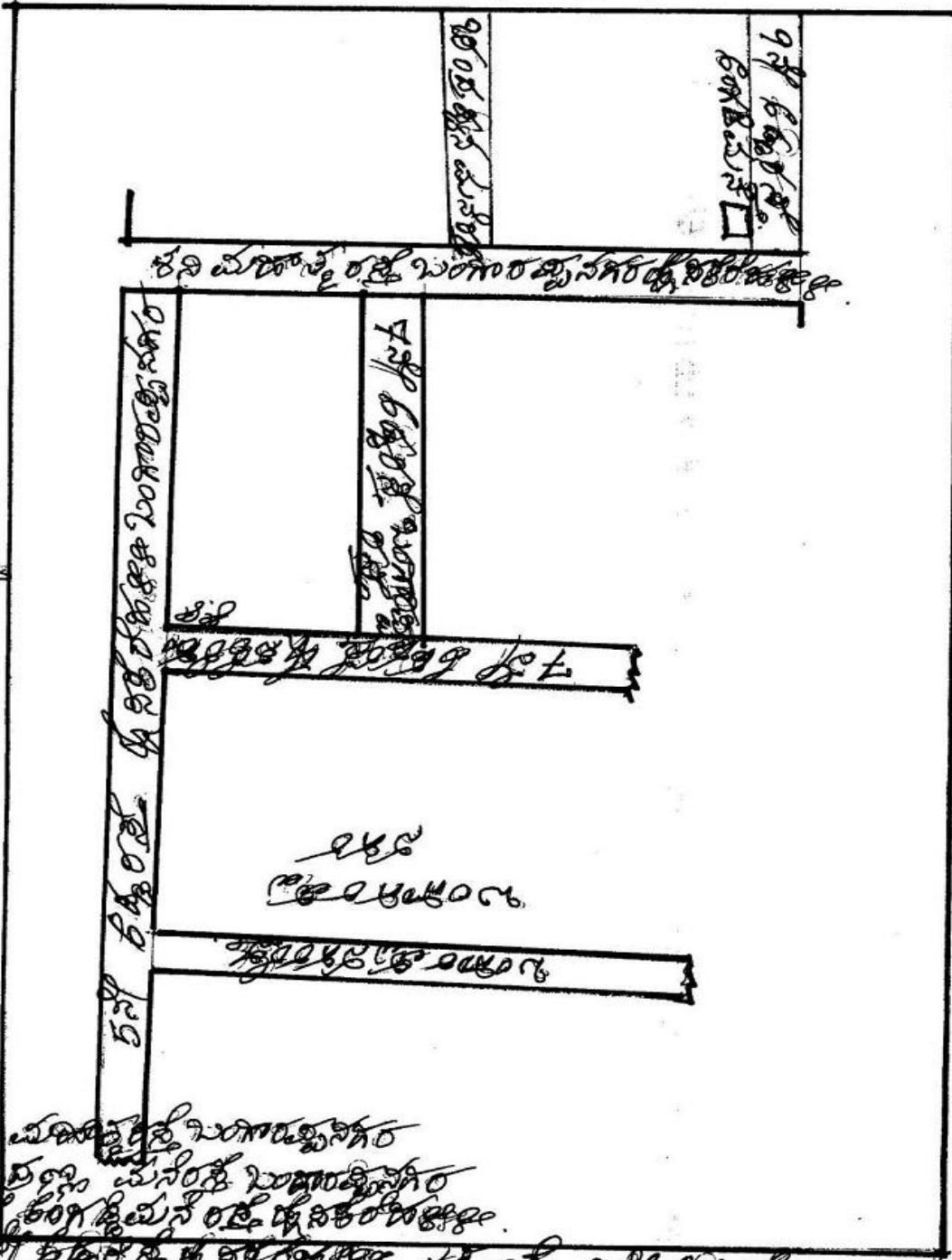

ಬತ್ತಂತ್ರಿ ಕಾಲೇಜು ಭೂಮಿ

- ① ಕನಿಷ್ಠಾತ್ಮಕ ರಸ್ತೆ ಬಂಗಾರಾಜ್ಞಾನಿಕರ
- ② 5ನೇ ಕಡಲೆಡ್ಡೆ ಭೂಮಿ ಬಂಗಾರಾಜ್ಞಾನಿಕರ
- ③ 7ನೇ ಕಡಲೆಡ್ಡೆ ಭೂಮಿ ಬಂಗಾರಾಜ್ಞಾನಿಕರ
- ④ 5ನೇ ಕಡಲೆಡ್ಡೆ ಭೂಮಿ ಬತ್ತಂತ್ರಿ ಕಾಲೇಜು ಭೂಮಿ
- ⑤ 7ನೇ ಕಡಲೆಡ್ಡೆ ಭೂಮಿ ಬತ್ತಂತ್ರಿ ಕಾಲೇಜು ಭೂಮಿ
- ⑥ ಬಂಗಾರಾಜ್ಞಾನಿಕರ ರಸ್ತೆ

[Handwritten signature]
Raj

Section No.:001)Shani mahatma Road Bangarappanagar Hosakerehalli, , Ward No: 160 -560085 Continued

| | | | | | | | | |
|----|------------|---|----|------------|--|----|------------|--|
| 1 | REJ5500459 | Name : Krishna Father's Name: CHALUVARAJU House No.:0 Age: 24 Sex: Male | 2 | REJ5391594 | Name : Pallavi J Father's Name: Javanaiah House No.:04 Age: 28 Sex: Female | 3 | REJ5391586 | Name : Mahesh N J Father's Name: Javanaiah House No.:04 Age: 36 Sex: Male |
| 4 | REJ3624525 | Name : Ashok Kumar Father's Name: Shivanna M. House No.:13 Age: 40 Sex: Male | 5 | REJ3624533 | Name : Shobha M. S. Husband's Name: Ashok Kumar House No.:13 Age: 36 Sex: Female | 6 | REJ4925335 | Name : S Annapoorna Husband's Name: K Y Raju House No.:14 (1078) Age: 33 Sex: Female |
| 7 | REJ4917738 | Name : K Y Raju Father's Name: Vairumudi Gowda House No.:14 (1078) Age: 37 Sex: Male | 8 | REJ5391677 | Name : Sannathayamma Husband's Name: Basavegowda House No.:30 Age: 30 Sex: Female | 9 | REJ5391669 | Name : Naga C Father's Name: Chikkanaiah House No.:30 Age: 42 Sex: Male |
| 10 | REJ5238100 | Name : Lakshamma Husband's Name: Boraiah House No.:51 Age: 47 Sex: Female | 11 | REJ6189658 | Name : Jyothish.B.N Father's Name: Narayan.m House No.:57 Age: 42 Sex: Male | 12 | REJ5992813 | Name : Jyothish B N Father's Name: Narayan M House No.:57 Age: 45 Sex: Male |
| 13 | REJ3624749 | Name : Shivakumara G. Father's Name: Ganeshappa House No.:75 Age: 33 Sex: Male | 14 | REJ5068994 | Name : Kamalamma Husband's Name: Kaveri gowda House No.:88 Age: 61 Sex: Female | 15 | REJ5067608 | Name : Nagaraj Father's Name: Ningaiah House No.:120 Age: 43 Sex: Male |
| 16 | REJ0389007 | Name : Murahari L. Father's Name: Lakshminarasinhana House No.:132 Age: 48 Sex: Male | 17 | REJ0388991 | Name : Pushpalatha S. Husband's Name: Murahari L. House No.:132 Age: 37 Sex: Female | 18 | REJ5067509 | Name : Roopa H S Father's Name: Jayanna House No.:151 Age: 21 Sex: Female |
| 19 | REJ5257258 | Name : Sathish J Father's Name: Javanaiah House No.:192/241 Age: 31 Sex: Male | 20 | REJ5257175 | Name : Divyashree S Father's Name: Srinivas B House No.:192/241 Age: 21 Sex: Female | 21 | REJ0448571 | Name : Nandini M. S. Husband's Name: Papanna T. House No.:207 Age: 30 Sex: Female |
| 22 | REJ5068580 | Name : S Shivakumara Father's Name: V Shankar House No.:213 Age: 31 Sex: Male | 23 | REJ0441410 | Name : Hema Husband's Name: Shivananju House No.:E-219/700 Age: 31 Sex: Female | 24 | REJ3626546 | Name : Jagadeesh M Father's Name: Mudali Gowda House No.:227 Age: 36 Sex: Male |
| 25 | REJ3626553 | Name : Anitha C R Husband's Name: Jagadeesh House No.:227 Age: 27 Sex: Female | 26 | REJ1055763 | Name : Chikka Boraiah Father's Name: Rangaiah House No.:E-230/698 Age: 42 Sex: Male | 27 | REJ1055771 | Name : Sarojamma Husband's Name: Chikka Boraiah House No.:E-230/698 Age: 32 Sex: Female |
| 28 | REJ5069091 | Name : Kumar Father's Name: Chandrahash House No.:E231 481 Age: 28 Sex: Male | 29 | REJ5068366 | Name : Kirana Father's Name: Nagaraj House No.:232 Age: 23 Sex: Male | 30 | REJ0449793 | Name : Shashi Husband's Name: Shashidhara House No.:E-232/695 Age: 37 Sex: Female |

Section No.:001)Shani mahatma Road Bangarappanagar Hosakerehalli, , Ward No: 160 -560085 Continued

| | | | | | |
|----------------------------|-------------|-----------------------------------|-------------|---------------------------------|-------------|
| 31 | REJ0442400 | 32 | REJ0576728 | 33 | REJ0576926 |
| Name : Girija | | Name : Kalaiah | | Name : Gowramma | |
| Husband's Name: Chikkank | | Father's Name: Eraiah | | Husband's Name: Kalaiah | |
| House No.:E-233/693 | | House No.:E-234/692 | | House No.:E-234/692 | |
| Age: 34 | Sex: Female | Age: 57 | Sex: Male | Age: 47 | Sex: Female |
| 34 | REJ0608570 | 35 | REJ0449595 | 36 | REJ0442665 |
| Name : Renuka | | Name : Naveena | | Name : Bhagya H | |
| Father's Name: Kalaiah | | Father's Name: Kalaiah | | Husband's Name: Narayana Swamy | |
| House No.:E-234/692 | | House No.:E-234/692 | | House No.:E-237/678 | |
| Age: 30 | Sex: Female | Age: 26 | Sex: Female | Age: 37 | Sex: Female |
| 37 | REJ0578344 | 38 | REJ0445569 | 39 | REJ5257217 |
| Name : Yogish | | Name : Renuka | | Name : Bhagya S | |
| Father's Name: Nagaraju | | Husband's Name: Yogish | | Father's Name: Srinivas K | |
| House No.:E-237/678 | | House No.:E-237/678 | | House No.:239 | |
| Age: 35 | Sex: Male | Age: 32 | Sex: Female | Age: 34 | Sex: Female |
| 40 | REJ5391560 | 41 | REJ5391644 | 42 | REJ5391552 |
| Name : Krishna J | | Name : Shivakumar V | | Name : Nagarathna | |
| Father's Name: Jayanna | | Father's Name: C Veeranna | | Father's Name: Jayanna | |
| House No.:239 | | House No.:239 | | House No.:239 | |
| Age: 25 | Sex: Male | Age: 43 | Sex: Male | Age: 29 | Sex: Female |
| 43 | REJ5257290 | 44 | REJ5257282 | 45 | REJ5257274 |
| Name : S. Krishna | | Name : Divya | | Name : Renuka S | |
| Father's Name: K. Srinivas | | Husband's Name: S. Krishna | | Father's Name: Srinivas K | |
| House No.:239 | | House No.:239 | | House No.:239 | |
| Age: 29 | Sex: Male | Age: 28 | Sex: Female | Age: 31 | Sex: Female |
| 46 | REJ0578419 | 47 | REJ0445619 | 48 | REJ5391651 |
| Name : Andani | | Name : Sudha | | Name : Deena | |
| Father's Name: Byra Shetty | | Husband's Name: Andani | | Husband's Name: Sampathkumar | |
| House No.:240 | | House No.:240 | | House No.:240 | |
| Age: 45 | Sex: Male | Age: 39 | Sex: Female | Age: 36 | Sex: Female |
| 49 | REJ5391628 | 50 | REJ0447300 | 51 | REJ3625126 |
| Name : Sampathkumar | | Name : Bharathi | | Name : Indra | |
| Father's Name: Noel Nelson | | Husband's Name: Rajashekhar | | Father's Name: Soma Shekhar | |
| House No.:240 | | House No.:E-242/834 | | House No.:E-244/834 | |
| Age: 40 | Sex: Male | Age: 39 | Sex: Female | Age: 25 | Sex: Female |
| 52 | REJ3625142 | 53 | REJ3625159 | 54 | REJ0607861 |
| Name : Lakshmamma | | Name : Mallesh | | Name : Venkatesh | |
| Husband's Name: Mariyappa | | Father's Name: Mariyappa | | Father's Name: Thimmaiah Elakki | |
| House No.:245 | | House No.:245 | | House No.:E-246/747/1 | |
| Age: 54 | Sex: Female | Age: 34 | Sex: Male | Age: 46 | Sex: Male |
| 55 | REJ0607879 | 56 | REJ0607663 | 57 | REJ0606772 |
| Name : Rukmini | | Name : Gangadhara. Shetty | | Name : Govindaiah | |
| Husband's Name: Venkatesh | | Father's Name: Gangadhara. Shetty | | Father's Name: Thimmaiah | |
| House No.:E-246/747/1 | | House No.:E-249/855/755 | | House No.:E-251/746 | |
| Age: 36 | Sex: Female | Age: 43 | Sex: Male | Age: 36 | Sex: Male |
| 58 | REJ6176036 | 59 | REJ0579755 | 60 | REJ5476601 |
| Name : Lalitha.S | | Name : Ashok | | Name : Shylaja S E | |
| Husband's Name: Parshuram | | Father's Name: Jayanna Char | | Husband's Name: Ashoka Kumar | |
| House No.:252 | | House No.:E-252/750 | | House No.:E-252/750 | |
| Age: 23 | Sex: Female | Age: 37 | Sex: Male | Age: 24 | Sex: Female |

Section No.:001)Shani mahatma Road Bangarappanagar Hosakerehalli, , Ward No: 160 -560085 Continued

| | | | | | | | | |
|-----------------|-----------------|-------------|-----------------|-----------------|-------------|-----------------|-------------------|-------------|
| 61 | REJ3625266 | | 62 | REJ6148514 | | 63 | REJ5068762 | |
| Name : | Susheela | | Name : | Giriddar.D | | Name : | Gangamma | |
| Husband's Name: | NANJUNDASWAMI | | Father's Name: | Dasappa | | Father's Name: | Venkata ramanna | |
| House No.: | E-252/750 | | House No.: | 253 | | House No.: | 254 | |
| Age: | 32 | Sex: Female | Age: | 27 | Sex: Male | Age: | 64 | Sex: Female |
| 64 | REJ0443986 | | 65 | REJ0575530 | | 66 | REJ0606640 | |
| Name : | Vijay | | Name : | Muneshwar | | Name : | Hombamma | |
| Husband's Name: | Nagaraju | | Father's Name: | Subbaraya | | Husband's Name: | Putta Lingaiah | |
| House No.: | E-254/833 | | House No.: | E-255/384 | | House No.: | E-256/840/ | |
| Age: | 37 | Sex: Female | Age: | 32 | Sex: Male | Age: | 31 | Sex: Female |
| 67 | REJ3625308 | | 68 | REJ3625316 | | 69 | REJ0447540 | |
| Name : | Eraiah | | Name : | Rukkamma | | Name : | Kumari M | |
| Father's Name: | Mayanna | | Husband's Name: | Eraiah | | Husband's Name: | Raja | |
| House No.: | E-257/845830 | | House No.: | E-257/845 | | House No.: | E-258/884 | |
| Age: | 47 | Sex: Male | Age: | 37 | Sex: Female | Age: | 30 | Sex: Female |
| 70 | REJ0442905 | | 71 | REJ0445312 | | 72 | REJ0578070 | |
| Name : | Yogish | | Name : | Lakkamma | | Name : | Sandeep C | |
| Father's Name: | Chikkanna | | Husband's Name: | Kebbale Gowda | | Father's Name: | Chikkanna | |
| House No.: | E-259/806 | | House No.: | E-259/806 | | House No.: | E-259/806 | |
| Age: | 27 | Sex: Male | Age: | 48 | Sex: Female | Age: | 25 | Sex: Male |
| 73 | MBQ0043653 | | 74 | MBQ0043679 | | 75 | MBQ0043729 | |
| Name : | Parvathi Bai V | | Name : | Shobha Bai | | Name : | Prashanth | |
| Husband's Name: | Jayaram Rao K M | | Father's Name: | Jayaram Rao K M | | Father's Name: | Jayaram Rao K M | |
| House No.: | E-262/893 | | House No.: | E-262/893 | | House No.: | E-262/893 | |
| Age: | 52 | Sex: Female | Age: | 30 | Sex: Female | Age: | 27 | Sex: Male |
| 76 | MBQ0043703 | | 77 | REJ3625373 | | 78 | REJ3626405 | |
| Name : | Raghavendra Rao | | Name : | Renuka | | Name : | V Ramesh | |
| Father's Name: | Jayaram Rao K M | | Husband's Name: | Siddaraju | | Father's Name: | M Venkatesh | |
| House No.: | E-263/892 | | House No.: | E-264/738 | | House No.: | 266 | |
| Age: | 29 | Sex: Male | Age: | 37 | Sex: Female | Age: | 35 | Sex: Male |
| 79 | REJ0580340 | | 80 | REJ0443531 | | 81 | REJ3625449 | |
| Name : | Sudha R. | | Name : | Yashodha | | Name : | Chikka Lingaiah | |
| Husband's Name: | Ramesh V. | | Husband's Name: | Narayana | | Father's Name: | Marpaththayya | |
| House No.: | 266 | | House No.: | E-266/837 | | House No.: | E-267/842 | |
| Age: | 31 | Sex: Female | Age: | 37 | Sex: Female | Age: | 57 | Sex: Male |
| 82 | REJ3625456 | | 83 | REJ3625464 | | 84 | REJ0580555 | |
| Name : | Hombamma | | Name : | Shiva Linga | | Name : | Mani K | |
| Husband's Name: | Chikka Lingaiah | | Father's Name: | Chikka Lingaiah | | Father's Name: | Kaliyappa | |
| House No.: | E-267/842 | | House No.: | E-267/842 | | House No.: | E-270/625 | |
| Age: | 42 | Sex: Female | Age: | 27 | Sex: Male | Age: | 43 | Sex: Female |
| 85 | REJ0448480 | | 86 | REJ0578096 | | 87 | REJ0443135 | |
| Name : | Shanthi | | Name : | Sathish | | Name : | Neela | |
| Husband's Name: | Mani K | | Father's Name: | Ganapathi | | Husband's Name: | Sathish | |
| House No.: | E-270/625 | | House No.: | E-271/650 | | House No.: | E-271/650 | |
| Age: | 34 | Sex: Female | Age: | 37 | Sex: Male | Age: | 32 | Sex: Female |
| 88 | REJ6174304 | | 89 | REJ5785761 | | 90 | REJ5068150 | |
| Name : | B.Mahadevayya | | Name : | Mohan Kumar | | Name : | Venkatesh G C | |
| Father's Name: | Basavayya | | Father's Name: | Jayaramagowda | | Father's Name: | Chikkamari shetti | |
| House No.: | 293 | | House No.: | 300 | | House No.: | 308 | |
| Age: | 38 | Sex: Male | Age: | 21 | Sex: Male | Age: | 21 | Sex: Male |

Section No.:001)Shani mahatma Road Bangarappanagar Hosakerehalli, , Ward No: 160 -560085 Continued

| | | | | | | | | |
|-----|------------|---|-----|------------|---|-----|------------|--|
| 91 | REJ5785886 | Name : Vinay.K Father's Name: Kempaiah.V House No.:308 Age: 21 Sex: Male | 92 | REJ5068887 | Name : Bhagya Mother's Name: Basamma House No.:309 Age: 22 Sex: Female | 93 | REJ5785993 | Name : Manja.S Father's Name: Shankregowda House No.:311 Age: 23 Sex: Male |
| 94 | REJ5068135 | Name : Venkatesh N Father's Name: Nagaraj M House No.:313 Age: 21 Sex: Male | 95 | REJ6109847 | Name : Manju Father's Name: Shivalingaiyah House No.:314 Age: 24 Sex: Male | 96 | REJ3625944 | Name : Nagendra C. Father's Name: Chikkaiah House No.:317 Age: 27 Sex: Male |
| 97 | REJ5067889 | Name : Sudesh Father's Name: Hombaiah House No.:319 Age: 37 Sex: Male | 98 | REJ0574277 | Name : Papanna B. Father's Name: Puttashamachar House No.:323 Age: 65 Sex: Male | 99 | REJ0441725 | Name : Thejaswini Husband's Name: Papanna B. House No.:323 Age: 37 Sex: Female |
| 100 | REJ5068408 | Name : R Bharathi Husband's Name: Srinivasa House No.:324 Age: 20 Sex: Female | 101 | REJ5786033 | Name : Rajeshwari Father's Name: Ganeshappa House No.:324 Age: 20 Sex: Female | 102 | REJ5190509 | Name : Leelavathi Husband's Name: Nagaraju House No.:325 Age: 51 Sex: Female |
| 103 | REJ5068291 | Name : Shobha Husband's Name: Ramesha House No.:334 Age: 22 Sex: Female | 104 | REJ5993035 | Name : Ramya Husband's Name: Shiva House No.:337 Age: 20 Sex: Female | 105 | REJ6179378 | Name : Ramya] Husband's Name: Shiva House No.:337 Age: 56 Sex: Female |
| 106 | REJ6175236 | Name : Kumar.L Father's Name: Lajar House No.:350 Age: 41 Sex: Male | 107 | REJ5068515 | Name : Jyothi Husband's Name: Kumar B K House No.:364 Age: 30 Sex: Female | 108 | REJ5068317 | Name : Shekhar Father's Name: Raja House No.:364 Age: 23 Sex: Male |
| 109 | REJ6098818 | Name : Nethravathi .K.S Husband's Name: Sudesh House No.:368 Age: 21 Sex: Female | 110 | REJ3625688 | Name : Kempegowda K. Father's Name: Kempegowda House No.:369 Age: 41 Sex: Male | 111 | REJ3625696 | Name : Sujathamma Husband's Name: Kempegowda House No.:369 Age: 33 Sex: Female |
| 112 | REJ5067707 | Name : S Venkatesha Father's Name: N srinivas House No.:377 Age: 20 Sex: Male | 113 | REJ5067954 | Name : Gali Kumara Mother's Name: venkamma House No.:378 Age: 25 Sex: Male | 114 | REJ5067913 | Name : Anusuya Husband's Name: Venkanna House No.:378 Age: 35 Sex: Female |
| 115 | REJ5391719 | Name : Lokesh.K Mother's Name: Gowramma House No.:386 Age: 24 Sex: Male | 116 | REJ5391693 | Name : Nagendra Kumar .K.S Mother's Name: Gowramma House No.:386 Age: 28 Sex: Male | 117 | REJ3625738 | Name : Raju Father's Name: Mallayya House No.:392 Age: 37 Sex: Male |
| 118 | REJ0580282 | Name : Bhagya Husband's Name: Chikkaboraiah House No.:392 Age: 30 Sex: Female | 119 | REJ5069026 | Name : Thulasamma Husband's Name: Raju House No.:402 Age: 33 Sex: Female | 120 | REJ3625753 | Name : Mayakannana M. Father's Name: Late. Murugesh House No.:410 Age: 30 Sex: Male |

Section No.:001)Shani mahatma Road Bangarappanagar Hosakerehalli, , Ward No: 160 -560085 Continued

| | | | | | | | | |
|-----|------------|--|-----|------------|--|-----|------------|---|
| 121 | REJ5068747 | Name : Rathnamma Husband's Name: Late Gangadharappa House No.:415 Age: 41 Sex: Female | 122 | REJ5068275 | Name : Bhagyamma Husband's Name: venkatesha House No.:421 Age: 24 Sex: Female | 123 | REJ5068903 | Name : Jayamma M Husband's Name: Muniswamy House No.:429 Age: 33 Sex: Female |
| 124 | REJ5068432 | Name : Muniswamy Father's Name: Muniyappa House No.:429 Age: 40 Sex: Male | 125 | REJ5067541 | Name : Nagesh C Mother's Name: Rathnamma House No.:440 Age: 23 Sex: Male | 126 | REJ0442897 | Name : Raju D.P. Father's Name: Peddanna House No.:444 Age: 34 Sex: Male |
| 127 | REJ0573295 | Name : Bommegowda C B Father's Name: Bommegowda House No.:448 Age: 30 Sex: Male | 128 | REJ0445742 | Name : Nagaveni Husband's Name: Vinayaka House No.:449 Age: 35 Sex: Female | 129 | REJ5500574 | Name : Jyothi N Husband's Name: MAHADEVA M House No.:455 Age: 20 Sex: Female |
| 130 | REJ5068705 | Name : Gowramma Husband's Name: Prakash C House No.:456 Age: 35 Sex: Female | 131 | REJ5069216 | Name : Vinoda Father's Name: Ningegowda House No.:461 Age: 22 Sex: Male | 132 | REJ5069190 | Name : S M Krishna Mother's Name: Dodda thayamma House No.:462 Age: 49 Sex: Male |
| 133 | REJ5069117 | Name : S M Veerabdragowda Mother's Name: Dodda thayamma House No.:462 Age: 61 Sex: Male | 134 | REJ5068929 | Name : Govinda C Father's Name: chikka idaiah House No.:467 Age: 32 Sex: Male | 135 | REJ5067756 | Name : Shobha Husband's Name: shivashankara R House No.:475 Age: 29 Sex: Female |
| 136 | REJ5067467 | Name : Shivashankar R Father's Name: Rudrappa House No.:475 Age: 38 Sex: Male | 137 | REJ5069059 | Name : Manu J Father's Name: Jayaramu House No.:476 Age: 21 Sex: Male | 138 | REJ5068721 | Name : Jayaramu Mother's Name: Gopamma House No.:476 Age: 45 Sex: Male |
| 139 | REJ5068226 | Name : Chitra R Husband's Name: Manikanta House No.:476 Age: 22 Sex: Female | 140 | REJ0389023 | Name : Roopa Husband's Name: Ravi House No.:481 Age: 30 Sex: Female | 141 | REJ0446047 | Name : Lakshamma Husband's Name: Rangappa House No.:482 Age: 79 Sex: Female |
| 142 | REJ0578310 | Name : Pushparaj Father's Name: Late. Anthonappa House No.:482 Age: 50 Sex: Male | 143 | REJ0446021 | Name : Geetha R. Husband's Name: Pushparaj House No.:482 Age: 36 Sex: Female | 144 | REJ5067640 | Name : Bharathi C Father's Name: Nagesh House No.:482 Age: 34 Sex: Female |
| 145 | REJ5068085 | Name : Latha R Father's Name: Ramaiah House No.:483 Age: 21 Sex: Female | 146 | REJ3625829 | Name : Vincent Raju Father's Name: Anthony Das House No.:484 Age: 38 Sex: Male | 147 | REJ3625837 | Name : Radha Husband's Name: Vincent Raju House No.:484 Age: 34 Sex: Female |
| 148 | REJ4944385 | Name : Manjunatha V Mother's Name: Latha M B House No.:484 Age: 21 Sex: Male | 149 | REJ5068952 | Name : Maridevamamma Husband's Name: Puttaswamy H M House No.:486 Age: 43 Sex: Female | 150 | REJ5067525 | Name : Krishna Kumar B P Father's Name: Puttaswamy H M House No.:486-510 Age: 26 Sex: Male |

Section No.:001)Shani mahatma Road Bangarappanagar Hosakerehalli, , Ward No: 160 -560085 Continued

| | | | | | | | | |
|-----|------------|---|-----|------------|--|-----|------------|---|
| 151 | REJ5500343 | Name : Shashikumar H M Father's Name: MAHESH House No.:487 Age: 21 Sex: Male | 152 | REJ0989178 | Name : Raniyamma Husband's Name: Siddaraju B. House No.:490 Age: 41 Sex: Female | 153 | REJ0578385 | Name : Prakash S. Father's Name: Siddaraju B. House No.:490 Age: 27 Sex: Male |
| 154 | REJ5068176 | Name : K P Mariyappa Father's Name: Jogaiah House No.:490 Age: 70 Sex: Male | 155 | REJ5069067 | Name : Arun Kumar A K Mother's Name: Pramila S B House No.:491 Age: 27 Sex: Male | 156 | REJ5056247 | Name : Mamatha R Father's Name: Ramanna House No.:495 Age: 24 Sex: Female |
| 157 | REJ5056213 | Name : Venkatalakshmi Husband's Name: Ramanna House No.:495 Age: 47 Sex: Female | 158 | REJ5068101 | Name : Venkatesha R Father's Name: Ramanna House No.:495 Age: 23 Sex: Male | 159 | REJ5068028 | Name : Ramanna Father's Name: Venkataiah House No.:495 Age: 52 Sex: Male |
| 160 | REJ5785803 | Name : Lingamma Husband's Name: HUCHAIAH House No.:496 Age: 65 Sex: Female | 161 | REJ5067863 | Name : Somashekara G Father's Name: Gopala House No.:503 Age: 39 Sex: Male | 162 | REJ0574459 | Name : Manjunatha R. C. Father's Name: Chikkalappa House No.:509 Age: 49 Sex: Male |
| 163 | REJ0442061 | Name : Lakshmidevi Husband's Name: Manjunath R. C. House No.:509 Age: 37 Sex: Female | 164 | REJ5190558 | Name : B.C. Radhamani Husband's Name: B.K. Nanjegowda House No.:524 Age: 44 Sex: Female | 165 | REJ5500475 | Name : Ajay Father's Name: RAMEGOWDA House No.:526 Age: 27 Sex: Male |
| 166 | REJ3626264 | Name : Narayanappa M. Mother's Name: Thimmamma House No.:527 Age: 39 Sex: Male | 167 | REJ3626272 | Name : Rathnamma Husband's Name: Narayanappa M House No.:527 Age: 35 Sex: Female | 168 | REJ0576579 | Name : Somashekhar M. Father's Name: Muniyappa House No.:529 Age: 29 Sex: Male |
| 169 | REJ3625894 | Name : Kumar K Father's Name: Kuppaswamy C House No.:535 Age: 39 Sex: Male | 170 | REJ3625902 | Name : Kalavathi R Husband's Name: Kumar K House No.:535 Age: 35 Sex: Female | 171 | REJ3625910 | Name : Mani H. S Father's Name: Kuppaswamy C House No.:535 Age: 43 Sex: Male |
| 172 | REJ3625928 | Name : Latha R Husband's Name: Mani K House No.:535 Age: 39 Sex: Female | 173 | REJ0606178 | Name : Siddappa Father's Name: Madaiah House No.:536 Age: 51 Sex: Male | 174 | REJ0606186 | Name : Lila Husband's Name: Siddappa House No.:536 Age: 41 Sex: Female |
| 175 | REJ5500616 | Name : Raju Father's Name: SHANKARAPPA House No.:537 Age: 41 Sex: Male | 176 | REJ0447391 | Name : Nagamma Husband's Name: Rajashekhara House No.:538 Age: 31 Sex: Female | 177 | REJ0579870 | Name : Suresh Father's Name: Venkataramaiah House No.:538 Age: 27 Sex: Male |
| 178 | REJ5992854 | Name : Ratnna Husband's Name: Ramu D T House No.:539 Age: 28 Sex: Female | 179 | REJ0389072 | Name : Chikkaiah Father's Name: Mariyappa House No.:540 Age: 27 Sex: Male | 180 | REJ5785779 | Name : Kempaiah Father's Name: Revanna House No.:540 Age: 50 Sex: Male |

Section No.:001)Shani mahatma Road Bangarappanagar Hosakerehalli, , Ward No: 160 -560085 Continued

| | | | | | | | | |
|-----|------------|---|-----|------------|---|-----|------------|---|
| 181 | REJ5785787 | Name : Naveen Kumar.K Father's Name: Kempaiah House No.:540 Age: 19 Sex: Male | 182 | REJ5785852 | Name : Sujatha Husband's Name: Kempaiah House No.:540 Age: 35 Sex: Female | 183 | REJ6109029 | Name : Jayalakshamma Husband's Name: V.Venkateshayya House No.:541 Age: 35 Sex: Female |
| 184 | REJ6159636 | Name : V.Venkateshayya Father's Name: Venkatasetty House No.:541 Age: 41 Sex: Male | 185 | REJ0988857 | Name : Venkataramma Father's Name: Hanumaiah House No.:543 Age: 74 Sex: Male | 186 | REJ0989038 | Name : Gangamma Husband's Name: Venkataramma House No.:543 Age: 55 Sex: Female |
| 187 | REJ0388611 | Name : Srinivas Father's Name: Venkataramma House No.:543 Age: 35 Sex: Male | 188 | REJ5190517 | Name : Hemavathi Husband's Name: Prabhudev House No.:546 Age: 35 Sex: Female | 189 | REJ5190533 | Name : Nagalakshmi Husband's Name: Manjunatha Chari House No.:549 Age: 37 Sex: Female |
| 190 | REJ0389064 | Name : Lakshmbai Husband's Name: Madhura K. House No.:550 Age: 30 Sex: Female | 191 | REJ5992664 | Name : Lokesh Father's Name: Kagegowda House No.:563 Age: 40 Sex: Male | 192 | REJ6162317 | Name : Jayamma Father's Name: Lakshmanappa House No.:568 Age: 50 Sex: Female |
| 193 | REJ5852223 | Name : Gopal Rao Salankey J Father's Name: Jagannath Rao S House No.:571 Age: 22 Sex: Male | 194 | REJ6195879 | Name : Harish.D Father's Name: dhanaraju House No.:572 Age: 19 Sex: Male | 195 | REJ3625977 | Name : Manjunatha E Father's Name: Erappa House No.:577 Age: 24 Sex: Male |
| 196 | REJ3625985 | Name : Suresh E Father's Name: Erappa House No.:577 Age: 26 Sex: Male | 197 | REJ6188494 | Name : Rajesh .C Father's Name: Chandraiahnnaidus House No.:579 Age: 32 Sex: Male | 198 | REJ6132245 | Name : Naveenkumar.N Father's Name: Narayanaswamy House No.:579 Age: 21 Sex: Male |
| 199 | REJ5069240 | Name : S Suresh Father's Name: peddanna House No.:580 Age: 30 Sex: Male | 200 | REJ5068523 | Name : S Narasamma Husband's Name: S Suresh House No.:580 Age: 28 Sex: Female | 201 | REJ5785910 | Name : Chethan M Father's Name: N MARIYAPP House No.:590 Age: 23 Sex: Male |
| 202 | REJ5785951 | Name : Thulasi Husband's Name: G HARIKUMAR House No.:590 Age: 25 Sex: Female | 203 | REJ0443929 | Name : Puttalingamma Husband's Name: Late. Manchegowda House No.:595 Age: 74 Sex: Female | 204 | REJ3626017 | Name : Bharathi M. Husband's Name: Murugadasa P. House No.:600 Age: 44 Sex: Female |
| 205 | REJ6193908 | Name : Mahanthesh .K.R Father's Name: Ranganna House No.:600 Age: 23 Sex: Male | 206 | REJ6124036 | Name : Shailaja Husband's Name: Mahanthesh House No.:600 Age: 26 Sex: Female | 207 | REJ5476338 | Name : Shivaraju Father's Name: Narayanappa House No.:607 Age: 40 Sex: Male |
| 208 | REJ6127161 | Name : Shivaraju.N Father's Name: Narayanappa House No.:607 Age: 41 Sex: Male | 209 | REJ6114557 | Name : Padma Husband's Name: Shivaraju House No.:607 Age: 68 Sex: Female | 210 | REJ5992714 | Name : Shivaraju N Father's Name: Narayanappa House No.:607 Age: 41 Sex: Male |

Section No.:001)Shani mahatma Road Bangarappanagar Hosakerehalli, , Ward No: 160 -560085 Continued

| | | | | | | | | |
|-----|------------|---|-----|------------|---|-----|------------|---|
| 211 | REJ5992896 | Name : Padma Husband's Name: Shivaraju House No.:607 Age: 37 Sex: Female | 212 | REJ6188940 | Name : Shivaraju.N Father's Name: Narayanappa House No.:607 Age: 20 Sex: Male | 213 | REJ6178784 | Name : Padma Husband's Name: Shivaraju House No.:607 Age: 36 Sex: Female |
| 214 | REJ5068242 | Name : Shanthamma Husband's Name: Kantharaju House No.:610 Age: 31 Sex: Female | 215 | REJ5500582 | Name : Manjunath P Father's Name: PRAKASH House No.:611 Age: 21 Sex: Male | 216 | REJ0574509 | Name : Lokesh H. R. Father's Name: Rajegowda House No.:612 Age: 35 Sex: Male |
| 217 | REJ0442392 | Name : Mahalakshmi A. S. Husband's Name: Lokesha H. R. House No.:612 Age: 32 Sex: Female | 218 | REJ5069174 | Name : Muniraju B M Father's Name: Motappa House No.:615-375 Age: 42 Sex: Male | 219 | REJ5068648 | Name : Vijay B M Father's Name: Muniraju B M House No.:615-375 Age: 22 Sex: Male |
| 220 | REJ5068499 | Name : Lokesh B M Father's Name: Muniraju B M House No.:615-375 Age: 41 Sex: Male | 221 | REJ5785985 | Name : Basavaraju Father's Name: Kariyappa House No.:621 Age: 46 Sex: Male | 222 | REJ0443952 | Name : Puttathayamma Husband's Name: Late. Ninge Gowda House No.:624 Age: 46 Sex: Female |
| 223 | REJ0579904 | Name : Papanna Father's Name: Malavaiah House No.:625 Age: 46 Sex: Male | 224 | REJ6188254 | Name : Santhosh.S Father's Name: Sankaran House No.:636 Age: 20 Sex: Male | 225 | REJ5785829 | Name : Venkatesh Father's Name: THIMMAIAH House No.:637 Age: 61 Sex: Male |
| 226 | REJ6110829 | Name : Girish Mother's Name: Venkatalakshamma House No.:638 Age: 27 Sex: Male | 227 | REJ5993019 | Name : Nagamma Husband's Name: Nagesh House No.:639 Age: 21 Sex: Female | 228 | REJ5992623 | Name : Nagamma Husband's Name: Nagesh House No.:639 Age: 21 Sex: Female |
| 229 | REJ0574947 | Name : Suresh Father's Name: Venkategowda House No.:640 Age: 34 Sex: Male | 230 | REJ0574954 | Name : Pavithra Father's Name: Suresh House No.:640 Age: 30 Sex: Female | 231 | REJ5069224 | Name : B R Ravikumar Father's Name: Ramaiah House No.:640 Age: 29 Sex: Male |
| 232 | REJ0444745 | Name : Shyama Mother's Name: Shanthakumari House No.:641 Age: 39 Sex: Male | 233 | REJ0606715 | Name : Raghavendra M. Mother's Name: Shanthakumari House No.:641 Age: 29 Sex: Male | 234 | REJ5068796 | Name : Ashok N Father's Name: Narayan gowda House No.:641 Age: 30 Sex: Male |
| 235 | REJ5068630 | Name : Baby J Husband's Name: Ramesh House No.:641 Age: 24 Sex: Female | 236 | REJ5068549 | Name : Suman C Husband's Name: Ashok N House No.:641 Age: 23 Sex: Female | 237 | REJ5068978 | Name : Mariswamy Father's Name: Puttasingi House No.:644 Age: 37 Sex: Male |
| 238 | REJ3626074 | Name : Mamatha N Husband's Name: Manjunatha T V House No.:648 Age: 34 Sex: Female | 239 | REJ5069000 | Name : Shobha B A Husband's Name: Venkatesh House No.:649 Age: 31 Sex: Female | 240 | REJ5068564 | Name : Venkatesh T Father's Name: Thimmaiah House No.:649 Age: 34 Sex: Male |

Section No.:001)Shani mahatma Road Bangarappanagar Hosakerehalli, , Ward No: 160 -560085 Continued

| | | | | | | | | |
|-----|------------|---|-----|------------|--|-----|------------|---|
| 241 | REJ0606137 | Name : Shankar S. B. Father's Name: Papanna House No.:650 Age: 43 Sex: Male | 242 | REJ0606145 | Name : Manjula S. Husband's Name: Shankar S. B. House No.:650 Age: 36 Sex: Female | 243 | REJ0445767 | Name : Lakshmidevi Husband's Name: Shankar S. B. House No.:650 Age: 37 Sex: Female |
| 244 | REJ5500418 | Name : Shivaprasad Father's Name: SIDDARAJU House No.:650 Age: 30 Sex: Male | 245 | REJ4936621 | Name : A R Manipal Father's Name: S R Arshivadam House No.:652 Age: 39 Sex: Male | 246 | REJ4931044 | Name : Jyothi Husband's Name: A R Manipal House No.:652 Age: 35 Sex: Female |
| 247 | REJ4918660 | Name : Manju K Others Name: Ramegowda House No.:655 Age: 35 Sex: Male | 248 | REJ4919577 | Name : Lakshamma Father's Name: Nill House No.:655 Age: 24 Sex: Female | 249 | REJ4918652 | Name : Leelavathi Father's Name: Nill House No.:655 Age: 23 Sex: Female |
| 250 | REJ5068689 | Name : Manju K Father's Name: Krishne gowda House No.:655 Age: 35 Sex: Male | 251 | REJ5068192 | Name : Leelavathi N Husband's Name: Manju K House No.:655 Age: 25 Sex: Female | 252 | REJ5500517 | Name : Rathamma Husband's Name: KRISHNAPPA House No.:655 Age: 60 Sex: Female |
| 253 | REJ5785845 | Name : Jayalakshmi M Husband's Name: THIMMAPPARAJU House No.:657 Age: 26 Sex: Female | 254 | REJ5068614 | Name : Ramesh Father's Name: Karishetti House No.:658 Age: 30 Sex: Male | 255 | REJ5992789 | Name : Ramesh Father's Name: Karishetty House No.:658 Age: 30 Sex: Male |
| 256 | REJ6184139 | Name : Ramesh Father's Name: Karishetty House No.:658 Age: 30 Sex: Male | 257 | REJ5500608 | Name : Manjunath Father's Name: NARAYANAPPA House No.:661 Age: 31 Sex: Male | 258 | REJ4917951 | Name : Vinay Prasad N Father's Name: Narashima House No.:666 Age: 21 Sex: Male |
| 259 | REJ5500327 | Name : Chennamma Husband's Name: RAJANNA House No.:667/1 Age: 33 Sex: Female | 260 | REJ4920328 | Name : Shankar Mother's Name: Raniyamma House No.:668 Age: 26 Sex: Male | 261 | REJ6121297 | Name : Narasamma B.N Husband's Name: Deepak kumar .p House No.:669 Age: 43 Sex: Female |
| 262 | REJ6176465 | Name : Nandini.P Father's Name: k.s.Padmanab House No.:669 Age: 44 Sex: Female | 263 | REJ6135818 | Name : Deepak Kumar.P Father's Name: Padnmanaba k.s House No.:669 Age: 27 Sex: Male | 264 | REJ5992649 | Name : Nandini P Father's Name: K S padmanabha House No.:669 Age: 40 Sex: Female |
| 265 | REJ5992888 | Name : Narasamma B N Husband's Name: Dipak Kumar P House No.:669 Age: 25 Sex: Female | 266 | REJ5992755 | Name : Deepak Kumar P Father's Name: Padmanabha K S House No.:669 Age: 27 Sex: Male | 267 | REJ5067772 | Name : Chandru K T Father's Name: Thimmaiah House No.:676 Age: 38 Sex: Male |
| 268 | REJ5068390 | Name : Manjula M T Father's Name: Thimmaiah House No.:676 Age: 23 Sex: Female | 269 | REJ5068457 | Name : Radhamma Husband's Name: Bettaraju House No.:682 Age: 34 Sex: Female | 270 | REJ5069232 | Name : Shashi Husband's Name: Sugendra House No.:685 Age: 25 Sex: Female |

Section No.:001)Shani mahatma Road Bangarappanagar Hosakerehalli, , Ward No: 160 -560085 Continued

| | | | | | | | | |
|-----------------|-------------------|-------------|-----------------|------------------|-------------|-----------------|--------------------|-------------|
| 271 | REJ5786108 | | 272 | REJ4917175 | | 273 | REJ5067665 | |
| Name : | Sugendra | | Name : | Mahendra T S | | Name : | Anjan Kumar K H | |
| Father's Name: | kalaiah | | Father's Name: | Shivanna | | Father's Name: | Hanumantharayappa | |
| House No.: | 685 | | House No.: | 687 | | House No.: | 688 | |
| Age: | 35 | Sex: Male | Age: | 22 | Sex: Male | Age: | 20 | Sex: Male |
| 274 | REJ5068861 | | 275 | REJ5068846 | | 276 | REJ5067848 | |
| Name : | Manjunath R | | Name : | Sowmya R | | Name : | Sowmya H R | |
| Father's Name: | Ranganath | | Husband's Name: | Jaya kumar S | | Husband's Name: | Ashok L S | |
| House No.: | 689 | | House No.: | 689 | | House No.: | 689 | |
| Age: | 23 | Sex: Male | Age: | 23 | Sex: Female | Age: | 24 | Sex: Female |
| 277 | REJ5068663 | | 278 | REJ5852231 | | 279 | REJ5067574 | |
| Name : | Jayakumar S | | Name : | Shivaji Rao A | | Name : | R Mahesh | |
| Father's Name: | Sanjeevaiah | | Father's Name: | Late. Ananth Rao | | Father's Name: | Rajendranaydu | |
| House No.: | 689 | | House No.: | 690 | | House No.: | 692 | |
| Age: | 33 | Sex: Male | Age: | 28 | Sex: Male | Age: | 38 | Sex: Male |
| 280 | REJ6106488 | | 281 | REJ6131940 | | 282 | REJ6166029 | |
| Name : | R.Asha | | Name : | Velliyamma | | Name : | Vanitha.R | |
| Husband's Name: | Manjunatha.r | | Husband's Name: | Rajendra naidu | | Husband's Name: | Narayana naidu | |
| House No.: | 692 | | House No.: | 692 | | House No.: | 692 | |
| Age: | 32 | Sex: Female | Age: | 21 | Sex: Female | Age: | 35 | Sex: Female |
| 283 | REJ6186696 | | 284 | REJ6177190 | | 285 | REJ6178875 | |
| Name : | Manjunatha | | Name : | Ravi | | Name : | Puttaswamy.N | |
| Father's Name: | n.Rajendragowda | | Father's Name: | Guruswamy naidu | | Father's Name: | Narasimhaya | |
| House No.: | 692 | | House No.: | 693 | | House No.: | 693 | |
| Age: | 36 | Sex: Male | Age: | 42 | Sex: Male | Age: | 47 | Sex: Male |
| 286 | REJ6165773 | | 287 | REJ5992680 | | 288 | REJ5056221 | |
| Name : | Bhartathi | | Name : | Puttaswamy N | | Name : | Manjula M | |
| Husband's Name: | Ravi | | Father's Name: | NARASIMHAIAH | | Father's Name: | Muniraju T C | |
| House No.: | 693 | | House No.: | 693 | | House No.: | 695 | |
| Age: | 38 | Sex: Female | Age: | 29 | Sex: Male | Age: | 24 | Sex: Female |
| 289 | REJ5068002 | | 290 | REJ5067798 | | 291 | REJ5477120 | |
| Name : | Pavitra M | | Name : | Muniraju T C | | Name : | V Srinivasa Murthy | |
| Father's Name: | Nagaraju V | | Father's Name: | Chikkappaiah | | Father's Name: | Venkataramu | |
| House No.: | 695 | | House No.: | 695 | | House No.: | 700 | |
| Age: | 22 | Sex: Female | Age: | 29 | Sex: Male | Age: | 37 | Sex: Male |
| 292 | REJ5067822 | | 293 | REJ5067624 | | 294 | REJ5067731 | |
| Name : | V Vijay Kumar | | Name : | M Bhagya | | Name : | Girisha G | |
| Father's Name: | Venkataramu | | Husband's Name: | Srinivasa murthy | | Father's Name: | late Girishetti | |
| House No.: | 700 | | House No.: | 700 | | House No.: | 704 | |
| Age: | 34 | Sex: Male | Age: | 26 | Sex: Female | Age: | 23 | Sex: Male |
| 295 | REJ6111603 | | 296 | REJ6120455 | | 297 | REJ5852199 | |
| Name : | Giresh.G | | Name : | Renuka | | Name : | P Mahadeva Nayaka | |
| Father's Name: | late Girishshetty | | Husband's Name: | Siddaraju | | Father's Name: | Puttamada Nayaka | |
| House No.: | 704 | | House No.: | 704 | | House No.: | 706 | |
| Age: | 23 | Sex: Male | Age: | 27 | Sex: Female | Age: | 41 | Sex: Male |
| 298 | REJ5852181 | | 299 | REJ3626140 | | 300 | REJ4954038 | |
| Name : | Jagadish M | | Name : | Sowmya G. | | Name : | Sativel | |
| Father's Name: | Mahadeva Nayaka | | Father's Name: | Gurumurthy G. | | Father's Name: | Mayavan | |
| House No.: | 706 | | House No.: | 707 | | House No.: | 713 | |
| Age: | 19 | Sex: Male | Age: | 27 | Sex: Female | Age: | 23 | Sex: Male |

Section No.:001)Shani mahatma Road Bangarappanagar Hosakerehalli, , Ward No: 160 -560085 Continued

| | | | | | | | | |
|-----|------------|--|-----|------------|--|-----|------------|---|
| 301 | REJ5500376 | Name : Tulasi Father's Name: KRISHNA House No.:716 Age: 19 Sex: Female | 302 | REJ4941761 | Name : Rebika Prithi Husband's Name: Sabastin Vinod House No.:721 Age: 27 Sex: Female | 303 | REJ4935383 | Name : Sabastin M Vinod Father's Name: Maical Raj House No.:721 Age: 29 Sex: Male |
| 304 | REJ4942934 | Name : Saraswathi Husband's Name: Sundaramurthy House No.:723 Age: 22 Sex: Female | 305 | REJ4945739 | Name : Usha Husband's Name: Balachandar House No.:724 Age: 21 Sex: Female | 306 | REJ4951059 | Name : Jyothi B R Husband's Name: M Prakash House No.:726 Age: 22 Sex: Female |
| 307 | REJ4932893 | Name : M Raju Father's Name: C Manchashetti House No.:726 Age: 35 Sex: Male | 308 | REJ4952123 | Name : M Siddaraju Father's Name: C Manchashetti House No.:726 Age: 29 Sex: Male | 309 | REJ4952461 | Name : Geetha N Husband's Name: Raju M House No.:726 Age: 31 Sex: Female |
| 310 | REJ5069141 | Name : Somesh S Father's Name: srinivas House No.:730 Age: 25 Sex: Male | 311 | REJ5069083 | Name : Savitha R Husband's Name: Nagaraja House No.:730 Age: 28 Sex: Female | 312 | REJ5068341 | Name : Nagaraja Father's Name: Maregowda House No.:730 Age: 38 Sex: Male |
| 313 | REJ5068325 | Name : Lakshmi N C Husband's Name: Somesh S House No.:730 Age: 21 Sex: Female | 314 | REJ6152193 | Name : Jaipall.A Father's Name: Andani House No.:732 Age: 22 Sex: Male | 315 | REJ6156541 | Name : Jayashila.A Father's Name: Andani House No.:732 Age: 51 Sex: Female |
| 316 | REJ0578955 | Name : Bailaiah Father's Name: Yallananjayya House No.:733 Age: 41 Sex: Male | 317 | REJ0574400 | Name : Bomme Gowda Father's Name: Bommegowda House No.:741 Age: 31 Sex: Male | 318 | REJ0574392 | Name : Dhanaraju C. Father's Name: Channaiah Va House No.:744 Age: 45 Sex: Male |
| 319 | REJ6172779 | Name : Ashok.L.S Father's Name: Siddaramayya House No.:746 Age: 33 Sex: Male | 320 | REJ3626371 | Name : Jayanna Char Father's Name: Thammayya Char House No.:748 Age: 57 Sex: Male | 321 | REJ5190525 | Name : Radha Bai Husband's Name: Somashekhar Rao House No.:748 Age: 67 Sex: Female |
| 322 | REJ5852249 | Name : Beeramma Husband's Name: S G Lingappa House No.:748 Age: 24 Sex: Female | 323 | REJ5852215 | Name : S G Lingappa Father's Name: S K Gopalappa House No.:748 Age: 44 Sex: Male | 324 | REJ3626223 | Name : Jyothi B. D Husband's Name: Govindaiah House No.:749 Age: 24 Sex: Female |
| 325 | REJ3626231 | Name : Raju Father's Name: Thimmaiah House No.:749 Age: 31 Sex: Male | 326 | REJ3626249 | Name : Navin Kumar B. D Father's Name: Dasappa J House No.:749 Age: 29 Sex: Male | 327 | REJ4952966 | Name : S H Lakshmi Husband's Name: K B Anand Kumar House No.:755 Age: 25 Sex: Female |
| 328 | REJ5785928 | Name : Shanthi.M Husband's Name: Mahendra.R House No.:758 Age: 39 Sex: Female | 329 | REJ5500392 | Name : Pavithra M Husband's Name: PRATHAP House No.:763 Age: 21 Sex: Female | 330 | REJ5500319 | Name : Nagesh V Father's Name: VENKATASWAMIAH House No.:764 Age: 23 Sex: Male |

Section No.:001)Shani mahatma Road Bangarappanagar Hosakerehalli, , Ward No: 160 -560085 Continued

| | | | | | | | | |
|-----|------------|--|-----|------------|--|-----|------------|--|
| 331 | REJ5852207 | Name : Bhuvaneshwari G Father's Name: Gurumurthy G House No.:773 Age: 23 Sex: Female | 332 | REJ0447474 | Name : Leelamma Husband's Name: Legovindappa House No.:774 Age: 71 Sex: Female | 333 | REJ0607077 | Name : Ramu D.T. Father's Name: Thimmashetty House No.:776 Age: 35 Sex: Male |
| 334 | REJ5785860 | Name : Shivaraju K Father's Name: KENCHAMALLAIAH House No.:777 Age: 21 Sex: Male | 335 | REJ5207030 | Name : Jayalakshamma Husband's Name: Rajanna House No.:781 Age: 40 Sex: Female | 336 | REJ5068069 | Name : Manjula M Husband's Name: Sathisha House No.:782 Age: 25 Sex: Female |
| 337 | REJ3626280 | Name : Prashanth Kumar Father's Name: Rajanna House No.:784 Age: 25 Sex: Male | 338 | REJ6125728 | Name : Jyothi.S Father's Name: Shivanna House No.:784 Age: 27 Sex: Female | 339 | REJ0607085 | Name : Chandrakumar G.K. Father's Name: Kalegowda House No.:786 Age: 42 Sex: Male |
| 340 | REJ0441402 | Name : Nagarathna C. Husband's Name: Chandrakumar G.K. House No.:786 Age: 35 Sex: Female | 341 | REJ5069257 | Name : Chaluvamma Husband's Name: pallappa House No.:789 Age: 79 Sex: Female | 342 | REJ5190541 | Name : Satya Narayana Father's Name: Somashekhar Rao House No.:789 Age: 34 Sex: Male |
| 343 | REJ5190491 | Name : Shankamma C R Husband's Name: Late Veerabhadra Char House No.:792 Age: 45 Sex: Female | 344 | REJ5067970 | Name : Rajalakshmi Husband's Name: Mallesha House No.:798 Age: 25 Sex: Female | 345 | REJ5067939 | Name : Mallesha Father's Name: Channaiah House No.:798 Age: 25 Sex: Male |
| 346 | REJ0579094 | Name : Gangadhar Father's Name: Cheluvvaraju House No.:799 Age: 28 Sex: Male | 347 | REJ5056239 | Name : Shruthi N Husband's Name: Nagaraj House No.:799 Age: 22 Sex: Female | 348 | REJ5068044 | Name : Nagaraj Father's Name: Dodda narasappa House No.:799 Age: 42 Sex: Male |
| 349 | REJ5067988 | Name : Chandamma Husband's Name: Nagaraj House No.:799 Age: 40 Sex: Female | 350 | REJ5067962 | Name : Kiran Kumar N Father's Name: Nagaraj House No.:799 Age: 24 Sex: Male | 351 | REJ5786058 | Name : Mamatha Husband's Name: Lingaraju.K House No.:802 Age: 26 Sex: Female |
| 352 | REJ5068473 | Name : Manjunath Father's Name: Gangappa House No.:803 Age: 46 Sex: Male | 353 | REJ5992920 | Name : Manjunatha Father's Name: Gangappa House No.:803 Age: 47 Sex: Male | 354 | REJ6144034 | Name : Renukamma Husband's Name: Manjunatha House No.:803 Age: 29 Sex: Female |
| 355 | REJ6147292 | Name : Manjunatha Father's Name: Gangappa House No.:803 Age: 47 Sex: Male | 356 | REJ5069158 | Name : Chikkamma Husband's Name: Nanjegowda House No.:805 Age: 77 Sex: Female | 357 | REJ5068820 | Name : Veena M Father's Name: mariswamy House No.:805 Age: 21 Sex: Female |
| 358 | REJ5785977 | Name : Paramesh Father's Name: Late.Madegowda House No.:807 Age: 43 Sex: Male | 359 | REJ5785878 | Name : Mahadeva.P Father's Name: Paramesha House No.:807 Age: 20 Sex: Male | 360 | REJ6098040 | Name : Putathayamma Husband's Name: Paramesh House No.:807 Age: 21 Sex: Female |

Section No.:001)Shani mahatma Road Bangarappanagar Hosakerehalli, , Ward No: 160 -560085 Continued

| | | | | | | | | |
|-----|------------|---|-----|------------|---|-----|------------|---|
| 361 | REJ5992953 | Name : Puttathayamma Husband's Name: Paramesh House No.:807 Age: 38 Sex: Female | 362 | REJ5500731 | Name : Bhagya Husband's Name: RAJU House No.:808 Age: 23 Sex: Female | 363 | REJ4931887 | Name : Venkatamma Husband's Name: Venkatabovi House No.:814 Age: 78 Sex: Female |
| 364 | REJ4931317 | Name : Honnamma Husband's Name: Mahadeva House No.:815 Age: 39 Sex: Female | 365 | REJ5500350 | Name : Maniyamma Husband's Name: RAJU House No.:817 Age: 35 Sex: Female | 366 | REJ4932133 | Name : Komala H S Husband's Name: Devaraj S House No.:826 Age: 25 Sex: Female |
| 367 | REJ3626363 | Name : Rukmini K Husband's Name: Raju R House No.:827 Age: 35 Sex: Female | 368 | REJ3625431 | Name : Narayana Father's Name: Thimmaiah House No.:830 Age: 42 Sex: Male | 369 | REJ4916862 | Name : Madhu Father's Name: Byrappa House No.:834 Age: 30 Sex: Male |
| 370 | REJ4917969 | Name : Rajanna Father's Name: Vattappa House No.:836 Age: 25 Sex: Male | 371 | REJ4925145 | Name : Parvathi Husband's Name: Rajanna House No.:836 Age: 35 Sex: Female | 372 | REJ5500665 | Name : Parvathi Father's Name: RAJANNA House No.:836 Age: 49 Sex: Female |
| 373 | REJ0574905 | Name : Channappa Father's Name: Kullaiah House No.:840 Age: 42 Sex: Male | 374 | REJ0442483 | Name : Nagamma Husband's Name: Channappa House No.:840 Age: 32 Sex: Female | 375 | REJ5067681 | Name : Gowramma Husband's Name: Narasimha murthy House No.:840 Age: 24 Sex: Female |
| 376 | REJ0442814 | Name : Sarojamma Husband's Name: Jayanna Char House No.:848 Age: 52 Sex: Female | 377 | REJ0580332 | Name : Lakshmi R. Husband's Name: Mahenadra House No.:866 Age: 30 Sex: Female | 378 | REJ0597179 | Name : Raju T. Father's Name: Thimmaiah House No.:870 Age: 54 Sex: Male |
| 379 | REJ3626587 | Name : Mallika Husband's Name: Murugan House No.:901 Age: 37 Sex: Female | 380 | REJ3626595 | Name : Vijayalakshmi Husband's Name: Nataraju House No.:901 Age: 32 Sex: Female | 381 | REJ5785969 | Name : Shakthivelu Father's Name: Harsha House No.:922 Age: 24 Sex: Male |
| 382 | REJ0448357 | Name : Leelavathi T.R. Husband's Name: Anantharaju Y.N. House No.:926 Age: 28 Sex: Female | 383 | REJ3626611 | Name : Veena C Father's Name: Chennaswamachar House No.:926 Age: 24 Sex: Female | 384 | REJ4931242 | Name : Thayamma Husband's Name: Venkatamma Mariyappa House No.:979/797 Age: 21 Sex: Female |

Section No.:002)Chandranna House Road Bangarappa nagar Hosakere Halli, , Ward No: 160 -560085 Continued

| | | | | | | | | |
|-----|------------|--|-----|------------|--|-----|------------|---|
| 385 | REJ0576256 | Name : Javaraiah Father's Name: Boraiah House No.:E-273/8421 Age: 37 Sex: Male | 386 | REJ0576264 | Name : Vasantha Husband's Name: Javaraiah House No.:E-273/8421 Age: 30 Sex: Female | 387 | REJ3626710 | Name : Putta Nanjamma Husband's Name: Boraiah House No.:E-274/751/ Age: 57 Sex: Female |
| 388 | REJ0607200 | Name : Shivanna N Father's Name: Nanjappa N House No.:E-276/7521 Age: 42 Sex: Male | 389 | REJ3626751 | Name : Pavithra Husband's Name: Shivanna N House No.:E-276/7521 Age: 32 Sex: Female | 390 | REJ3626850 | Name : Siddaraj Shetty Father's Name: Putta Swamy Shetty House No.:E-282/131 Age: 34 Sex: Male |
| 391 | REJ0443499 | Name : Renuka Father's Name: Siddaraj Shetty House No.:E-282/131 Age: 36 Sex: Female | 392 | REJ0448118 | Name : Vasantha Husband's Name: Ramesh House No.:E-285/725/4 Age: 29 Sex: Female | 393 | REJ0578732 | Name : Muniraju Father's Name: Muniyappa House No.:E-286/718 Age: 34 Sex: Male |
| 394 | REJ0446666 | Name : Nagarathna Husband's Name: Venkata Swamy House No.:E-286/718 Age: 26 Sex: Female | 395 | REJ3626967 | Name : Narayana Father's Name: Putta Swamy House No.:E-287/1/71 Age: 33 Sex: Male | 396 | REJ0580753 | Name : Nataraj Father's Name: Madevappa House No.:E-287/1/71 Age: 28 Sex: Male |
| 397 | REJ0446252 | Name : Asha Father's Name: Madevappa House No.:E-287/1/71 Age: 28 Sex: Female | 398 | REJ0606251 | Name : Muruli C Father's Name: Challappa A House No.:E-287/713 Age: 26 Sex: Male | 399 | REJ0576025 | Name : Srinivas Father's Name: Narasimhaiah House No.:E-289/725 Age: 32 Sex: Male |
| 400 | REJ0444547 | Name : Lakshmi Husband's Name: Srinivas House No.:E-289/725 Age: 24 Sex: Female | 401 | REJ0448787 | Name : Lakshmi Husband's Name: Narayana House No.:E-290/726 Age: 37 Sex: Female | 402 | REJ0576272 | Name : Jayamma Husband's Name: Rangaiah B. C House No.:E-291/835 Age: 47 Sex: Female |
| 403 | REJ0580407 | Name : Mari Swamy Father's Name: Deve Gowda House No.:E-292/739 Age: 52 Sex: Male | 404 | REJ3627031 | Name : Gayathri Husband's Name: Mari Swamy House No.:E-292/739 Age: 42 Sex: Female | 405 | REJ0580415 | Name : Vinay Father's Name: Mariswamy House No.:E-292/739 Age: 24 Sex: Male |
| 406 | REJ3626678 | Name : Javarayi Father's Name: Nagegowda House No.:293 Age: 66 Sex: Male | 407 | REJ3626686 | Name : Shivamma Husband's Name: Javaraiah House No.:293 Age: 41 Sex: Female | 408 | REJ0576835 | Name : Arkesh Father's Name: Annaiah Char House No.:E-293/703 Age: 46 Sex: Male |
| 409 | REJ0576843 | Name : Gayathri Husband's Name: Arkesh House No.:E-293/703 Age: 44 Sex: Female | 410 | REJ0606731 | Name : Nagarathamma Husband's Name: Ramaiah House No.:E-295/736 Age: 46 Sex: Female | 411 | REJ0606749 | Name : Mohan Kumar Father's Name: Ramaiah House No.:E-295/736 Age: 28 Sex: Male |
| 412 | REJ0575506 | Name : Ranga Swamy Father's Name: Thimmaiah House No.:E-296/485 Age: 27 Sex: Male | 413 | REJ0575423 | Name : Girish Father's Name: Thimmaiah House No.:E-296/485 Age: 25 Sex: Male | 414 | REJ3627098 | Name : Padma Husband's Name: Anandappa House No.:343 Age: 51 Sex: Female |

Section No.:002)Chandranna House Road Bangarappa nagar Hosakere Halli, , Ward No: 160 -560085 Continued

| | | | | | | | | |
|-----------------|----------------|-------------|-----------------|-------------|-------------|----------------|----------------|-----------|
| 415 | REJ4435533 | | 416 | REJ4435509 | | 417 | REJ4681045 | |
| Name : | Mahesh A M | | Name : | N Anand | | Name : | A Balakrishna | |
| Father's Name: | Madegowda | | Father's Name: | Nanjundaiah | | Father's Name: | Anand | |
| House No.: | 420 | | House No.: | 422 | | House No.: | 422 | |
| Age: | 27 | Sex: Male | Age: | 67 | Sex: Male | Age: | 27 | Sex: Male |
| 418 | REJ4435491 | | 419 | REJ4435517 | | 420 | REJ3627205 | |
| Name : | A Teju | | Name : | R Kalaimani | | Name : | Venkataswamy | |
| Father's Name: | Ananad | | Husband's Name: | Anand | | Mother's Name: | Venkatamma | |
| House No.: | 422 | | House No.: | 422 | | House No.: | 718 | |
| Age: | 29 | Sex: Female | Age: | 60 | Sex: Female | Age: | 51 | Sex: Male |
| 421 | REJ3627213 | | 422 | REJ3627239 | | 423 | REJ3627270 | |
| Name : | Lakshamma | | Name : | Nagarathna | | Name : | Jagannatha Rao | |
| Husband's Name: | Venkataswamy | | Husband's Name: | Muniraju | | Father's Name: | Manubai | |
| House No.: | 718 | | House No.: | 718 | | House No.: | 745 | |
| Age: | 46 | Sex: Female | Age: | 26 | Sex: Female | Age: | 69 | Sex: Male |
| 424 | REJ3627288 | | | | | | | |
| Name : | Vishwanath | | | | | | | |
| Father's Name: | Jagannatha Rao | | | | | | | |
| House No.: | 745 | | | | | | | |
| Age: | 40 | Sex: Male | | | | | | |

Section No.:003)th Shop House Road Hosakere Halli, , Ward No: 160 -560085 Continued

| | | | | | | | | |
|-----------------|--------------------|-------------|-----------------|------------------|-------------|-----------------|---------------|-------------|
| 425 | REJ3627296 | | 426 | REJ3627304 | | 427 | REJ3627312 | |
| Name : | Siddaraju M S | | Name : | Minakshi | | Name : | Jyothi | |
| Father's Name: | Sidde Gowda | | Husband's Name: | Siddaraju M S | | Husband's Name: | Raghavendra | |
| House No.: | E-177/736 | | House No.: | E-177/736 | | House No.: | E-178/740 | |
| Age: | 39 | Sex: Male | Age: | 35 | Sex: Female | Age: | 25 | Sex: Female |
| 428 | REJ0577742 | | 429 | REJ0446302 | | 430 | REJ0580209 | |
| Name : | Raju | | Name : | Shivarathna | | Name : | Lokesh | |
| Father's Name: | Chikka Veere Gowda | | Husband's Name: | Raju | | Father's Name: | Karge Gowda | |
| House No.: | E-179/741 | | House No.: | E-179/741 | | House No.: | E-180/632 | |
| Age: | 45 | Sex: Male | Age: | 38 | Sex: Female | Age: | 42 | Sex: Male |
| 431 | REJ0580183 | | 432 | REJ0449835 | | 433 | REJ0580191 | |
| Name : | Shantha | | Name : | Jayamma | | Name : | Manjula | |
| Husband's Name: | Lokesh | | Husband's Name: | Lakke Gowda | | Husband's Name: | Govindaraju | |
| House No.: | E-180/632 | | House No.: | E-181/630 | | House No.: | E-181/630 | |
| Age: | 32 | Sex: Female | Age: | 47 | Sex: Female | Age: | 27 | Sex: Female |
| 434 | REJ0442913 | | 435 | REJ3627346 | | 436 | REJ3627353 | |
| Name : | Renukamma | | Name : | Mohan | | Name : | Ambika | |
| Husband's Name: | Chikkanna | | Father's Name: | Muniyappa | | Husband's Name: | Mohan | |
| House No.: | E-183/629 | | House No.: | E-183/629 | | House No.: | E-183/629 | |
| Age: | 39 | Sex: Female | Age: | 32 | Sex: Male | Age: | 27 | Sex: Female |
| 437 | REJ0443093 | | 438 | REJ3627387 | | 439 | REJ3627395 | |
| Name : | Lakshmi | | Name : | Shylaja | | Name : | Ramachandra | |
| Father's Name: | Chikkanna | | Husband's Name: | Siddesh | | Father's Name: | Venkatappa | |
| House No.: | E-183/629 | | House No.: | E-186/7481 | | House No.: | E-188/7521 | |
| Age: | 25 | Sex: Female | Age: | 33 | Sex: Female | Age: | 42 | Sex: Male |
| 440 | REJ0448837 | | 441 | REJ0389122 | | 442 | REJ3627403 | |
| Name : | Shobha | | Name : | Kempa Rajamma | | Name : | Prabhu | |
| Husband's Name: | Ramachandra | | Husband's Name: | Shivakumar | | Father's Name: | Ramaiah | |
| House No.: | E-188/7521 | | House No.: | E-189/753 | | House No.: | E-189/753/ | |
| Age: | 36 | Sex: Female | Age: | 29 | Sex: Female | Age: | 45 | Sex: Male |
| 443 | REJ0389114 | | 444 | REJ0446575 | | 445 | REJ0443234 | |
| Name : | Nagamma | | Name : | Sheela | | Name : | Manju | |
| Husband's Name: | Prabhu | | Husband's Name: | Srinivas | | Father's Name: | Chikkanna | |
| House No.: | E-189/753/1 | | House No.: | E-193/671/ | | House No.: | E-194/669 | |
| Age: | 32 | Sex: Female | Age: | 29 | Sex: Female | Age: | 24 | Sex: Male |
| 446 | REJ0580605 | | 447 | REJ3627445 | | 448 | REJ0448399 | |
| Name : | Savithamma | | Name : | Shivalingaiah | | Name : | Shanthamma | |
| Husband's Name: | Arun Kumar | | Father's Name: | Bajappa | | Husband's Name: | Shivalingaiah | |
| House No.: | E-195/666/ | | House No.: | E-196/875 | | House No.: | E-196/875 | |
| Age: | 30 | Sex: Female | Age: | 44 | Sex: Male | Age: | 38 | Sex: Female |
| 449 | REJ3627510 | | 450 | REJ0608018 | | 451 | REJ3627536 | |
| Name : | Sharadamma | | Name : | Kodanda Rama M | | Name : | Hamsa | |
| Husband's Name: | Manikyam | | Father's Name: | Manikyam | | Father's Name: | Sannaiah | |
| House No.: | E-200/600 | | House No.: | E-200/600 | | House No.: | E-201/670 | |
| Age: | 57 | Sex: Female | Age: | 38 | Sex: Male | Age: | 25 | Sex: Female |
| 452 | REJ0578641 | | 453 | REJ0388827 | | 454 | REJ0388868 | |
| Name : | Rama Krishna | | Name : | Kodi Linge Gowda | | Name : | Sathirsh | |
| Father's Name: | Sannaiah | | Father's Name: | Nanjappa | | Father's Name: | Nanjappa | |
| House No.: | E-201/670/ | | House No.: | E-202/840 | | House No.: | E-202/840 | |
| Age: | 35 | Sex: Male | Age: | 35 | Sex: Male | Age: | 29 | Sex: Male |

Section No.:003)th Shop House Road Hosakere Halli, , Ward No: 160 -560085 Continued

| | | | | | | | | |
|-----------------|----------------------|-------------|-----------------|--------------------------|-------------|-----------------|----------------------|-------------|
| 455 | REJ0388850 | | 456 | REJ0606939 | | 457 | REJ3627551 | |
| Name : | Rathna | | Name : | Jayamma | | Name : | Venkatesh | |
| Husband's Name: | Kodi Linge Gowda | | Husband's Name: | Gundaiah | | Father's Name: | Thimmaiah | |
| House No.: | E-202/840 | | House No.: | E-203/2781 | | House No.: | E-205/852 | |
| Age: | 26 | Sex: Female | Age: | 52 | Sex: Female | Age: | 33 | Sex: Male |
| 458 | REJ3627569 | | 459 | REJ1054006 | | 460 | REJ1054014 | |
| Name : | Sunandamma | | Name : | Narasimha Murthy C L | | Name : | Gowramma | |
| Husband's Name: | Venkatesh | | Father's Name: | Chikka Venkata Ramanaiah | | Husband's Name: | Narasimha Murthy C L | |
| House No.: | E-205/852 | | House No.: | E-206/4461 | | House No.: | E-206/4461 | |
| Age: | 26 | Sex: Female | Age: | 62 | Sex: Male | Age: | 55 | Sex: Female |
| 461 | REJ1054030 | | 462 | REJ1054089 | | 463 | REJ1054048 | |
| Name : | Krishna Murthy N | | Name : | Anjana Murthy N | | Name : | Srinivas Murthy | |
| Father's Name: | Narasimha Murthy C L | | Father's Name: | Narasimha Murthy C L | | Father's Name: | Narasimha Murthy C L | |
| House No.: | E-206/446 | | House No.: | E-206/446 | | House No.: | E-206/446 | |
| Age: | 32 | Sex: Male | Age: | 28 | Sex: Male | Age: | 35 | Sex: Male |
| 464 | REJ0581322 | | 465 | REJ0441584 | | 466 | REJ0445072 | |
| Name : | Janardhana | | Name : | Kumari | | Name : | Kariyappa | |
| Father's Name: | Ramadasa Char | | Father's Name: | Kencha Shetty | | Father's Name: | Chenna Shetty | |
| House No.: | E-211/547/ | | House No.: | E-212/741 | | House No.: | E-214/589 | |
| Age: | 41 | Sex: Male | Age: | 28 | Sex: Female | Age: | 57 | Sex: Male |
| 467 | REJ0448605 | | 468 | REJ3627676 | | 469 | REJ4373890 | |
| Name : | Sarojamma | | Name : | Mahalinge Gowda | | Name : | Rekhavathi | |
| Husband's Name: | Kariyappa | | Father's Name: | Shivalinge Gowda | | Husband's Name: | Kumar | |
| House No.: | E-214/589 | | House No.: | E-216/578 | | House No.: | :350 | |
| Age: | 45 | Sex: Female | Age: | 34 | Sex: Male | Age: | 31 | Sex: Female |
| 470 | REJ0577569 | | 471 | REJ3627627 | | 472 | REJ4374039 | |
| Name : | Babu C B. | | Name : | Venkatesh | | Name : | Vasantha | |
| Father's Name: | Bomme Gowda | | Father's Name: | Chissa Bovi | | Husband's Name: | Suresh H. P | |
| House No.: | :448 | | House No.: | :458 | | House No.: | :487 | |
| Age: | 28 | Sex: Male | Age: | 34 | Sex: Male | Age: | 30 | Sex: Female |
| 473 | REJ4374047 | | 474 | REJ0577676 | | 475 | REJ3627585 | |
| Name : | Suresh H. P | | Name : | Jagannath Rao S | | Name : | Durgabayi M | |
| Father's Name: | Papegowda | | Father's Name: | N Eshwarappa Rao | | Husband's Name: | Jagannath Rao | |
| House No.: | :487 | | House No.: | :571 | | House No.: | :571 | |
| Age: | 35 | Sex: Male | Age: | 61 | Sex: Male | Age: | 42 | Sex: Female |
| 476 | REJ3627684 | | 477 | REJ0577544 | | 478 | REJ0445999 | |
| Name : | Sushila | | Name : | N Dilip | | Name : | Thanuja N | |
| Husband's Name: | Mahalinge Gowda | | Father's Name: | Nagendra Ram | | Husband's Name: | Shivaji Rao A | |
| House No.: | :573 | | House No.: | :580 | | House No.: | :690 | |
| Age: | 29 | Sex: Female | Age: | 28 | Sex: Male | Age: | 26 | Sex: Female |
| 479 | REJ4373924 | | 480 | REJ4373932 | | 481 | REJ4373940 | |
| Name : | Manchashetti | | Name : | Gowramma | | Name : | Prakash M | |
| Father's Name: | Chaudashetty | | Husband's Name: | Manchashetti | | Father's Name: | Manchashetti | |
| House No.: | :729 | | House No.: | :729 | | House No.: | :729 | |
| Age: | 67 | Sex: Male | Age: | 59 | Sex: Female | Age: | 33 | Sex: Male |
| 482 | REJ4374062 | | 483 | REJ0607895 | | 484 | REJ0606707 | |
| Name : | Umesha | | Name : | Hombalaiah | | Name : | Manjula | |
| Father's Name: | Chikka Jogappa | | Father's Name: | Bommaiah | | Husband's Name: | Hombalaiah | |
| House No.: | :734 | | House No.: | :769 | | House No.: | :769 | |
| Age: | 40 | Sex: Male | Age: | 35 | Sex: Male | Age: | 33 | Sex: Female |

Section No.:003)th Shop House Road Hosakere Halli, , Ward No: 160 -560085 Continued

| | | | | | | | | |
|------------------------------|------------|--|------------------------------|------------|--|-------------------------|------------|--|
| 485 | REJ0578740 | | 486 | REJ4374070 | | 487 | REJ4374088 | |
| Name : Lingaraju K | | | Name : Thirumalappa | | | Name : Raju S | | |
| Father's Name: Kencha Shetty | | | Father's Name: Chikkamunippa | | | Father's Name: Sannaiah | | |
| House No.:802 | | | House No.:828 | | | House No.:843 | | |
| Age: 28 Sex: Male | | | Age: 46 Sex: Male | | | Age: 50 Sex: Male | | |
| 488 | REJ4374096 | | 489 | REJ4374104 | | | | |
| Name : Nagabhushana | | | Name : Rajamma | | | | | |
| Father's Name: Ramanna | | | Husband's Name: Nagabhushana | | | | | |
| House No.:849 | | | House No.:849 | | | | | |
| Age: 41 Sex: Male | | | Age: 33 Sex: Female | | | | | |

Section No.:004)5th Cross Hosakerehalli, , Ward No: 160 -560085 Continued

| | | | | | | | | |
|-----|------------|--|-----|------------|---|-----|------------|---|
| 490 | REJ3627742 | Name : Shivalingamma Husband's Name: Puttaiah House No.:E-1/521 Age: 52 Sex: Female | 491 | MBQ0043349 | Name : Shivakumar Father's Name: Puttaiah House No.:E-1/521 Age: 32 Sex: Male | 492 | MBQ0043331 | Name : Lakshmi Husband's Name: Puttaiah House No.:E-1/521 Age: 30 Sex: Female |
| 493 | REJ0449405 | Name : Dhanalakshmi Father's Name: Puttaiah House No.:E-1/521 Age: 28 Sex: Female | 494 | REJ0578500 | Name : Shivaraju Father's Name: Puttaiah House No.:E-1/521 Age: 26 Sex: Male | 495 | REJ0580068 | Name : Soma Shekhar Father's Name: Nagamahadevappa House No.:E-2/520 Age: 26 Sex: Male |
| 496 | REJ3627767 | Name : Raghu Father's Name: Madeva House No.:E-3/522 Age: 27 Sex: Male | 497 | REJ3627775 | Name : Sunitha Father's Name: Madeva House No.:E-3/522 Age: 25 Sex: Female | 498 | REJ3627833 | Name : Bharathi Husband's Name: Kondappa House No.:E-7/504 Age: 27 Sex: Female |
| 499 | REJ3627841 | Name : Rekha C Father's Name: Chandrappa House No.:E-8/502 Age: 26 Sex: Female | 500 | REJ0448134 | Name : Neethu Bai Husband's Name: Vasantha Rao House No.:E-9/474 Age: 27 Sex: Female | 501 | REJ3627874 | Name : Nandini Husband's Name: Papanna House No.:E-11/496 Age: 30 Sex: Female |
| 502 | REJ0573386 | Name : Ashok Kumar Father's Name: Kalachari House No.:E-13/526 Age: 51 Sex: Male | 503 | REJ0440859 | Name : Suvaramma Husband's Name: Ashok Kumar House No.:E-13/526 Age: 48 Sex: Female | 504 | REJ0443333 | Name : Keroji Rao B. M Father's Name: Narasoji Rao B. R House No.:E-17/528 Age: 65 Sex: Male |
| 505 | REJ0443259 | Name : Shankamma Bai Husband's Name: Keroji Rao B. M House No.:E-17/528 Age: 52 Sex: Female | 506 | REJ0443242 | Name : Soubagya B. K Father's Name: Keroji Rao B. M House No.:E-17/528 Age: 35 Sex: Female | 507 | REJ0577973 | Name : Soma Shekhar B. K Father's Name: Keroji Rao B. M House No.:E-17/528 Age: 30 Sex: Male |
| 508 | REJ0577981 | Name : Lokesh B. K Father's Name: Keroji Rao B. M House No.:E-17/528 Age: 28 Sex: Male | 509 | REJ3627916 | Name : Nagamma Husband's Name: Chikkaiah House No.:E-19/539 Age: 52 Sex: Female | 510 | REJ0446963 | Name : Roopa Father's Name: Chikkanna House No.:E-21/544 Age: 26 Sex: Female |
| 511 | REJ0989152 | Name : Mamatha Husband's Name: Prakash House No.:E-22/545 Age: 29 Sex: Female | 512 | REJ0449223 | Name : Eshwaramma Husband's Name: Malagondayya House No.:E-23/481 Age: 47 Sex: Female | 513 | REJ0581983 | Name : Madhav Father's Name: Malagondayya House No.:E-23/481 Age: 25 Sex: Male |
| 514 | REJ0582064 | Name : Shashi Father's Name: Malagondayya House No.:E-23/481 Age: 25 Sex: Female | 515 | REJ0388793 | Name : Yusuf Father's Name: Anen Sab House No.:E-26/863 Age: 28 Sex: Male | 516 | REJ0989228 | Name : Najima Husband's Name: Anen Sab House No.:E-26/863 Age: 25 Sex: Female |
| 517 | REJ0606855 | Name : Thimme Gowda Father's Name: Anke Gowda House No.:E-27/865 Age: 58 Sex: Male | 518 | REJ0443473 | Name : Subhadramma Husband's Name: Thimme Gowda House No.:E-27/865 Age: 53 Sex: Female | 519 | REJ0443911 | Name : Shantha Kumar Father's Name: Thimme Gowda House No.:E-27/865 Age: 33 Sex: Male |

Section No.:004)5th Cross Hosakerehalli, , Ward No: 160 -560085 Continued

| | | | | | | | | |
|-----------------|----------------|-------------|-----------------|----------------|-------------|-----------------|------------------|-------------|
| 520 | REJ0443481 | | 521 | REJ0446443 | | 522 | REJ0574384 | |
| Name : | Sunanda | | Name : | Shantha Kumari | | Name : | Raj Kumar | |
| Father's Name: | Thimme Gowda | | Father's Name: | Thimme Gowda | | Father's Name: | Murugeshan | |
| House No.: | E-27/865 | | House No.: | E-27/865 | | House No.: | E-29/102 | |
| Age: | 31 | Sex: Female | Age: | 32 | Sex: Female | Age: | 45 | Sex: Male |
| 523 | REJ0441832 | | 524 | REJ0578567 | | 525 | REJ0448654 | |
| Name : | Then Moli | | Name : | Mariyappa | | Name : | Gowramma | |
| Husband's Name: | Raj Kumar | | Father's Name: | Ramaiah | | Husband's Name: | Mariyappa | |
| House No.: | E-29/102 | | House No.: | E-30/834 | | House No.: | E-30/834 | |
| Age: | 33 | Sex: Female | Age: | 57 | Sex: Male | Age: | 54 | Sex: Female |
| 526 | REJ3628021 | | 527 | REJ0440289 | | 528 | REJ5500293 | |
| Name : | Kale Gowda | | Name : | Bhagya | | Name : | Hanumantharaya | |
| Father's Name: | Ire Gowda | | Husband's Name: | Mariyappa | | Father's Name: | RAMACHANDRAIAH | |
| House No.: | E-30/834 | | House No.: | E-30/834 | | House No.: | 187 | |
| Age: | 37 | Sex: Male | Age: | 33 | Sex: Female | Age: | 28 | Sex: Male |
| 529 | REJ5500277 | | 530 | REJ3627809 | | 531 | REJ3627965 | |
| Name : | Manjula H | | Name : | Shivagami | | Name : | Chikkanna | |
| Husband's Name: | HANUMANTHARAYA | | Husband's Name: | Nagaraju | | Father's Name: | Doddaiah | |
| House No.: | 187 | | House No.: | 226 | | House No.: | 257 | |
| Age: | 23 | Sex: Female | Age: | 27 | Sex: Female | Age: | 57 | Sex: Male |
| 532 | REJ0574210 | | 533 | REJ0606574 | | 534 | REJ3628005 | |
| Name : | Shivaji Rao | | Name : | Padma Bayi | | Name : | Lakshmi | |
| Father's Name: | Venkoji Rao | | Husband's Name: | Shivaraji Rao | | Husband's Name: | Mahesh | |
| House No.: | 275 | | House No.: | 275 | | House No.: | 282 | |
| Age: | 33 | Sex: Male | Age: | 28 | Sex: Female | Age: | 27 | Sex: Female |
| 535 | REJ3628013 | | 536 | REJ3628062 | | 537 | REJ3628070 | |
| Name : | Mahesh | | Name : | Pushpa | | Name : | Ravi Vaggara | |
| Father's Name: | Dasappa | | Husband's Name: | Ravi Vaggara | | Father's Name: | Halappa | |
| House No.: | 282 | | House No.: | 374 | | House No.: | 374 | |
| Age: | 37 | Sex: Male | Age: | 38 | Sex: Female | Age: | 38 | Sex: Male |
| 538 | REJ0572370 | | 539 | REJ0440305 | | 540 | REJ3628104 | |
| Name : | Chowde Gowda | | Name : | Nagarathna | | Name : | Anand Kumar K B. | |
| Father's Name: | Thimme Gowda | | Father's Name: | Shashidhar | | Father's Name: | Boje gowda | |
| House No.: | 754 | | House No.: | 754 | | House No.: | 755 | |
| Age: | 31 | Sex: Male | Age: | 28 | Sex: Female | Age: | 28 | Sex: Male |
| 541 | REJ3628120 | | | | | | | |
| Name : | Lakkamma | | | | | | | |
| Husband's Name: | Boje Gowda | | | | | | | |
| House No.: | 755 | | | | | | | |
| Age: | 45 | Sex: Female | | | | | | |

Section No.:005)7th Cross Hosakere Halli, , Ward No: 160 -560085 Continued

| | | | | | | | | |
|-----|------------|---|-----|------------|--|-----|------------|---|
| 542 | REJ0606038 | Name : Suresh Father's Name: Mashanayya House No.:E-53/641/1 Age: 32 Sex: Male | 543 | REJ0442368 | Name : Ambika Husband's Name: Suresh House No.:E-53/641/1 Age: 31 Sex: Female | 544 | REJ0576710 | Name : Vani Father's Name: Manjunath House No.:E-55/631/5 Age: 26 Sex: Female |
| 545 | REJ0988907 | Name : Kumar Father's Name: Nanjundappa House No.:E-58/547 Age: 36 Sex: Male | 546 | REJ0989236 | Name : Nagarathna Husband's Name: Kumar House No.:E-58/547 Age: 31 Sex: Female | 547 | REJ0579540 | Name : Shivalingaiah Father's Name: Shambu Shetty House No.:E-63/647/154 Age: 43 Sex: Male |
| 548 | REJ0448381 | Name : Thayamma Husband's Name: Shivalingaiah House No.:E-63/647/1 Age: 41 Sex: Female | 549 | REJ3628336 | Name : Munirathna Naidu Father's Name: Naidu House No.:E-65/659 Age: 62 Sex: Male | 550 | REJ3628344 | Name : Mohan Father's Name: Munirathna Naidu House No.:E-65/659 Age: 39 Sex: Male |
| 551 | REJ3628351 | Name : Bharathi Husband's Name: Mohan House No.:E-65/659 Age: 37 Sex: Female | 552 | REJ3628369 | Name : Jeevamma Husband's Name: Munirathna Naidu House No.:E-65/659/1 Age: 53 Sex: Female | 553 | REJ3628377 | Name : Babu Father's Name: Munirathna Naidu House No.:E-65/659/1 Age: 39 Sex: Male |
| 554 | REJ3628385 | Name : Gayathri Husband's Name: Babu House No.:E-65/659/1 Age: 33 Sex: Female | 555 | REJ3628427 | Name : Krishna Murthy Father's Name: Cheluvaiah House No.:E-67/667 Age: 35 Sex: Male | 556 | REJ0446237 | Name : Bhagya Husband's Name: Mallesh House No.:E-68/631 Age: 29 Sex: Female |
| 557 | REJ0579235 | Name : Shekhar Father's Name: Mahadevappa House No.:E-68/631 Age: 27 Sex: Male | 558 | REJ0446609 | Name : Gowri Father's Name: Mahadevappa House No.:E-68/631 Age: 25 Sex: Female | 559 | REJ0578484 | Name : Mahadeva Father's Name: Mahadevappa House No.:E-70/671 Age: 27 Sex: Male |
| 560 | REJ0576611 | Name : Basavaraju Father's Name: Mahadevappa House No.:E-70/671 Age: 26 Sex: Male | 561 | REJ0440768 | Name : Devamma Husband's Name: Chikkanna House No.:E-75/591 Age: 57 Sex: Female | 562 | REJ0440776 | Name : Saraswathi Husband's Name: Srinivas House No.:E-75/591 Age: 36 Sex: Female |
| 563 | REJ0573626 | Name : Shivanna Father's Name: Chikkanna House No.:E-75/591 Age: 35 Sex: Male | 564 | REJ0389163 | Name : Karpagam Husband's Name: Thambi House No.:E-76/674/1 Age: 35 Sex: Female | 565 | REJ0448688 | Name : Raju Father's Name: Raju House No.:E-77/678/5 Age: 42 Sex: Male |
| 566 | REJ0448613 | Name : Mahadevamma Husband's Name: Raju House No.:E-77/678/5 Age: 37 Sex: Female | 567 | REJ0581165 | Name : Puttamma Husband's Name: Mari Gowda House No.:E-79/684 Age: 57 Sex: Female | 568 | REJ3628559 | Name : Mahesh Father's Name: Mari Gowda House No.:E-79/684 Age: 36 Sex: Male |
| 569 | REJ3628567 | Name : Mahendra Father's Name: Mari Gowda House No.:E-79/684 Age: 32 Sex: Male | 570 | REJ0581173 | Name : Lakshmi Husband's Name: Mahesh House No.:E-79/684 Age: 35 Sex: Female | 571 | REJ0582007 | Name : Sina Father's Name: Singaiah House No.:E-80/686/1 Age: 42 Sex: Male |

Section No.:005)7th Cross Hosakere Halli, , Ward No: 160 -560085 Continued

| | | | | | | | | |
|-----|------------|--|-----|------------|--|-----|------------|---|
| 572 | REJ0449389 | Name : Gowri Husband's Name: Sina House No.:E-80/686/121 Age: 34 Sex: Female | 573 | REJ0446690 | Name : Sumithamma Husband's Name: Narasimha Murthy House No.:E-85/527 Age: 60 Sex: Female | 574 | REJ0574038 | Name : Thulasi Ram Father's Name: Changal Reddy House No.:E-88/504 Age: 49 Sex: Male |
| 575 | REJ0576702 | Name : Prema M T Husband's Name: Thulasi Ram House No.:E-88/504 Age: 36 Sex: Female | 576 | REJ0608364 | Name : Lokesh Father's Name: Chikkanna House No.:E-90/504/1 Age: 32 Sex: Male | 577 | REJ0608372 | Name : Pavithra Husband's Name: Lokesh House No.:E-90/504/1 Age: 28 Sex: Female |
| 578 | REJ3628716 | Name : Anand Father's Name: Putta Mahadeva House No.:E-93/499 Age: 34 Sex: Male | 579 | REJ3628724 | Name : Usha Husband's Name: Anand House No.:E-93/499 Age: 28 Sex: Female | 580 | REJ0446898 | Name : Shanthamma Husband's Name: Nagaraju House No.:E-94/173 Age: 41 Sex: Female |
| 581 | REJ3626025 | Name : Jayalakshmi Husband's Name: Papanna House No.:438 Age: 34 Sex: Female | 582 | REJ3626728 | Name : Anitha Y B Husband's Name: Govindaraju House No.:438 Age: 35 Sex: Female | 583 | REJ0575480 | Name : Narasimha Murthy Father's Name: Veeranna House No.:447 Age: 56 Sex: Male |
| 584 | REJ0443390 | Name : Mahadevamma Husband's Name: Venkatesh House No.:458 Age: 29 Sex: Female | 585 | REJ0607226 | Name : Venkatesh Father's Name: Venkataiah House No.:458 Age: 34 Sex: Male | 586 | REJ5500590 | Name : Shivashankar Father's Name: CHIKKANNA House No.:483 Age: 31 Sex: Male |
| 587 | REJ5500566 | Name : Lakshamma Husband's Name: RAMAIAH House No.:483 Age: 41 Sex: Female | 588 | REJ5500558 | Name : Sakamma Husband's Name: BASAPPA House No.:483 Age: 71 Sex: Female | 589 | REJ0607622 | Name : Devalinga Father's Name: Late. Shivalinge Gowda House No.:492 Age: 38 Sex: Male |
| 590 | REJ0446401 | Name : Uma Husband's Name: Devaling House No.:492 Age: 31 Sex: Female | 591 | REJ0577411 | Name : Giriraju Father's Name: Late. Shivalinge Gowda House No.:492 Age: 38 Sex: Male | 592 | REJ5785795 | Name : Mohan Kumar D Father's Name: DODDATHAMMAIAH House No.:493 Age: 38 Sex: Male |
| 593 | REJ5786074 | Name : Manjunath Father's Name: NANJUNDAPPA House No.:496 Age: 26 Sex: Male | 594 | REJ3621786 | Name : Huchchaiah Father's Name: Huchchaiah House No.:500 Age: 78 Sex: Male | 595 | REJ0443002 | Name : Savitha Husband's Name: Srinivas House No.:593 Age: 27 Sex: Female |
| 596 | REJ0572503 | Name : Suresh Father's Name: Chikkanna House No.:611 Age: 36 Sex: Male | 597 | REJ0441154 | Name : Shanthamma Husband's Name: Suresh H C House No.:611 Age: 29 Sex: Female | 598 | REJ0448803 | Name : Kavitha Husband's Name: Sanjayakumar House No.:613 Age: 26 Sex: Female |
| 599 | REJ0580787 | Name : Sangeetha Husband's Name: Vijayakumar House No.:621 Age: 26 Sex: Female | 600 | REJ3621612 | Name : Dorai Father's Name: Gurappa House No.:644 Age: 42 Sex: Male | 601 | REJ3621638 | Name : Harish Father's Name: Basavaraju House No.:647 Age: 34 Sex: Male |

Section No.:005)7th Cross Hosakere Halli, , Ward No: 160 -560085 Continued

| | | | | | | | | |
|----------------|----------------|-----------|-----------------|------------|-------------|----------------|----------------|-------------|
| 602 | REJ3628864 | | 603 | REJ3628872 | | 604 | REJ0608505 | |
| Name : | Chinnabovi | | Name : | Jayamma | | Name : | Srinivas | |
| Father's Name: | Doddathammayya | | Husband's Name: | Chinnabovi | | Father's Name: | Kuppa Lingaiah | |
| House No.: | 651 | | House No.: | 651 | | House No.: | 665 | |
| Age: | 39 | Sex: Male | Age: | 34 | Sex: Female | Age: | 34 | Sex: Male |
| 605 | REJ0579227 | | 606 | REJ3628880 | | 607 | REJ0580548 | |
| Name : | Harish Kumar S | | Name : | Uma S | | Name : | Prema | |
| Father's Name: | Srinivasa | | Father's Name: | Srinivasa | | Father's Name: | Bailaiah | |
| House No.: | 677 | | House No.: | 677 | | House No.: | 733 | |
| Age: | 28 | Sex: Male | Age: | 26 | Sex: Female | Age: | 34 | Sex: Female |
| 608 | REJ3628914 | | | | | | | |
| Name : | Kambanna | | | | | | | |
| Father's Name: | Rajanna | | | | | | | |
| House No.: | 784 | | | | | | | |
| Age: | 25 | Sex: Male | | | | | | |

Section No.:006)bamgarappa nagara, , Ward No: 160 -560085 Continued

| | | | | | | | | |
|-----|------------|---|-----|------------|---|-----|------------|--|
| 609 | REJ5500624 | Name : Rajashekar S Father's Name: SRINIVAS S House No.:156 Age: 19 Sex: Male | 610 | REJ5257266 | Name : Sujatha S Father's Name: Srinivas B House No.:192/241 Age: 25 Sex: Female | 611 | REJ5785936 | Name : H P Geetha Husband's Name: GANGABASAVIAIAH House No.:244 Age: 41 Sex: Female |
| 612 | REJ4739314 | Name : Kamakshi A Father's Name: Anand House No.:422 Age: 28 Sex: Female | 613 | REJ5500491 | Name : Nagaraju Father's Name: MUNIYAPPA House No.:470 Age: 47 Sex: Male | 614 | REJ0444760 | Name : Sunil Kumar Father's Name: Mahadev House No.:500 Age: 25 Sex: Male |
| 615 | REJ0445122 | Name : Nethravathi Father's Name: Krishnappa V C House No.:500 Age: 30 Sex: Male | 616 | REJ0445080 | Name : Babu Father's Name: Krishnappa V C House No.:500 Age: 29 Sex: Male | 617 | REJ0608448 | Name : Balraju Father's Name: Krishnappa V C House No.:500 Age: 26 Sex: Male |
| 618 | REJ3628922 | Name : H Uma Husband's Name: Gangadhar Gowda House No.:501 Age: 30 Sex: Female | 619 | REJ3628930 | Name : Gangadhar Gowda Father's Name: Sahadev House No.:501 Age: 37 Sex: Male | 620 | REJ0608315 | Name : Geetha Husband's Name: Sahadev House No.:501 Age: 58 Sex: Female |
| 621 | REJ3628955 | Name : Raghavendraswamy Father's Name: Late. Sahadev House No.:501 Age: 33 Sex: Male | 622 | REJ3625860 | Name : Vijayakumar A Father's Name: Annayyappa House No.:524 Age: 25 Sex: Male | 623 | REJ3628153 | Name : Annayyappa Father's Name: Venkataswamy Bovi House No.:524 Age: 51 Sex: Male |
| 624 | REJ5500525 | Name : Thimmakka Husband's Name: ANNAYAPPA House No.:524 Age: 62 Sex: Female | 625 | REJ5500301 | Name : Pedga Bhovi Father's Name: GENDHA BHOVI House No.:524 Age: 81 Sex: Male | 626 | REJ5500632 | Name : Venkatamma Husband's Name: GURUVAIAH House No.:524 Age: 21 Sex: Female |
| 627 | REJ5500640 | Name : Rekha Husband's Name: AJAY House No.:526 Age: 19 Sex: Female | 628 | REJ5500335 | Name : Manjunath N Father's Name: NARASHIMA MURTHI House No.:527/1 Age: 41 Sex: Male | 629 | REJ5500483 | Name : Sakamma K R Husband's Name: SHEKAR House No.:605 Age: 19 Sex: Female |
| 630 | REJ5500285 | Name : Prakash Father's Name: VENKATASHETTI House No.:611 Age: 50 Sex: Male | 631 | REJ5785837 | Name : Ramakrishna S Father's Name: SHIVANNA House No.:624/1 Age: 32 Sex: Male | 632 | REJ5785894 | Name : Shylaja Husband's Name: RAMAKRISHNA S House No.:624/1 Age: 29 Sex: Female |
| 633 | REJ0444364 | Name : Shanthalakshmi Husband's Name: D M Manjunatha House No.:629 Age: 31 Sex: Female | 634 | REJ5500541 | Name : Sunitha P Father's Name: PRAKASH House No.:642/787 Age: 19 Sex: Female | 635 | REJ5500699 | Name : V Chandrashekar Father's Name: VENKATACHALA House No.:658 Age: 19 Sex: Male |
| 636 | REJ5500657 | Name : Chandrakala Husband's Name: MANJUNATH House No.:661 Age: 29 Sex: Female | 637 | REJ5500426 | Name : Siddappa Father's Name: BASAVARAJU House No.:667 Age: 23 Sex: Male | 638 | REJ5500400 | Name : Rajanna Father's Name: BASAVARAJU House No.:667 Age: 24 Sex: Male |

Section No.:006)bamgarappa nagara, , Ward No: 160 -560085 Continued

| | | | | | | | | |
|-----------------|-------------------|-------------|-----------------|------------------|-------------|-----------------|-----------------|-------------|
| 639 | REJ5786017 | | 640 | REJ5500384 | | 641 | REJ5500368 | |
| Name : | R Vijya Kumar | | Name : | Mahesh H M | | Name : | Shakunthala | |
| Mother's Name: | MARY YLET | | Father's Name: | MARIYAPPA | | Husband's Name: | APPAJI | |
| House No.: | 720 | | House No.: | 723 | | House No.: | 729 | |
| Age: | 19 | Sex: Male | Age: | 51 | Sex: Male | Age: | 37 | Sex: Female |
| 642 | REJ0750232 | | 643 | REJ0750224 | | 644 | REJ5500681 | |
| Name : | Kenchashetty | | Name : | Mahadevamma | | Name : | Sunil K | |
| Father's Name: | Kenchashetty | | Husband's Name: | Kenchashetty | | Father's Name: | KANTHARAJU | |
| House No.: | 741 | | House No.: | 741 | | House No.: | 742 | |
| Age: | 62 | Sex: Male | Age: | 48 | Sex: Female | Age: | 23 | Sex: Male |
| 645 | REJ5500756 | | 646 | REJ5500749 | | 647 | REJ5500715 | |
| Name : | Lankesh K B | | Name : | Kousalya Lankesh | | Name : | Anil K | |
| Father's Name: | BYREGOWDA | | Husband's Name: | LANKESH K B | | Father's Name: | KANTHARAJU | |
| House No.: | 742 | | House No.: | 742 | | House No.: | 742 | |
| Age: | 34 | Sex: Male | Age: | 24 | Sex: Female | Age: | 19 | Sex: Male |
| 648 | REJ5500707 | | 649 | REJ5500442 | | 650 | REJ5500723 | |
| Name : | Kantharaju S | | Name : | K Narasimhulu | | Name : | Puneetha S H | |
| Father's Name: | SOMASHEKAR | | Father's Name: | K GOVINDAIAH | | Husband's Name: | ANAND KUMAR K B | |
| House No.: | 749 | | House No.: | 751 | | House No.: | 755 | |
| Age: | 21 | Sex: Male | Age: | 35 | Sex: Male | Age: | 24 | Sex: Female |
| 651 | REJ5500434 | | 652 | REJ5500509 | | 653 | REJ5500467 | |
| Name : | Chikkathayamma | | Name : | Javaregowda P | | Name : | K M Rajanna | |
| Husband's Name: | MALLAIAH | | Father's Name: | PUTTASWAMIGOWDA | | Father's Name: | MADHUREGOWDA | |
| House No.: | 772 | | House No.: | 782 | | House No.: | 782 | |
| Age: | 46 | Sex: Female | Age: | 26 | Sex: Male | Age: | 29 | Sex: Male |
| 654 | REJ5785902 | | 655 | REJ5992987 | | 656 | REJ5500673 | |
| Name : | Megha Shree R | | Name : | Renukamma | | Name : | Vinay Kumar | |
| Father's Name: | D RAJU | | Husband's Name: | Manjunatha | | Father's Name: | MARISWAMI | |
| House No.: | 782 | | House No.: | 803 | | House No.: | 805 | |
| Age: | 20 | Sex: Female | Age: | 29 | Sex: Female | Age: | 22 | Sex: Male |
| 657 | REJ5500533 | | 658 | REJ5785811 | | 659 | REJ5785944 | |
| Name : | Pavithra | | Name : | Jaanachar | | Name : | Sarojamma | |
| Husband's Name: | KUMARSWAMI | | Father's Name: | THAMMANNA CHAR | | Husband's Name: | JAYANNACHARI | |
| House No.: | 809 | | House No.: | 809 | | House No.: | 809 | |
| Age: | 27 | Sex: Female | Age: | 37 | Sex: Male | Age: | 63 | Sex: Female |
| 660 | REJ0605485 | | 661 | REJ0605493 | | 662 | REJ0605501 | |
| Name : | Chandrashekhara D | | Name : | Dasa Prakash D | | Name : | Dase Gowda | |
| Father's Name: | Dase Gowda | | Father's Name: | Dase Gowda | | Father's Name: | Huche Gowda | |
| House No.: | 825 | | House No.: | 825 | | House No.: | 825 | |
| Age: | 29 | Sex: Male | Age: | 32 | Sex: Male | Age: | 59 | Sex: Male |
| 663 | REJ0441535 | | 664 | REJ0989160 | | 665 | REJ0581397 | |
| Name : | Chikkathayamma | | Name : | Chikkanna | | Name : | Kumari | |
| Husband's Name: | Dase Gowda | | Father's Name: | Madaiah | | Husband's Name: | Shankar | |
| House No.: | 825 | | House No.: | 844 | | House No.: | 850 | |
| Age: | 51 | Sex: Female | Age: | 51 | Sex: Male | Age: | 28 | Sex: Female |
| 666 | REJ0581405 | | 667 | REJ4757266 | | | | |
| Name : | Shankar | | Name : | Jayamma | | | | |
| Father's Name: | Bommanna | | Father's Name: | Doddamayagaiah | | | | |
| House No.: | 850 | | House No.: | 1023 | | | | |
| Age: | 34 | Sex: Male | Age: | 41 | Sex: Female | | | |

Section No.:007)6th Cross Hosakere Halli., Ward No: 160 -560085 Continued

| | | | | | | | | |
|-----------------|-----------------|-------------|-----------------|-----------------|-------------|-----------------|----------------|-------------|
| 668 | REJ0607937 | | 669 | REJ0442574 | | 670 | REJ3624327 | |
| Name : | Raju Rao | | Name : | Asha Bai | | Name : | Pal Raj | |
| Father's Name: | Pandu Ranga Rao | | Husband's Name: | Raju Rao | | Father's Name: | Nagaraju | |
| House No.: | E-37/596 | | House No.: | E-37/596 | | House No.: | E-38/598 | |
| Age: | 40 | Sex: Male | Age: | 27 | Sex: Female | Age: | 52 | Sex: Male |
| 671 | REJ3624335 | | 672 | REJ0443903 | | 673 | REJ0388728 | |
| Name : | Gayathri | | Name : | Lakshmi | | Name : | Nirmala Bai | |
| Husband's Name: | Pal Raj | | Husband's Name: | Shivalinga | | Husband's Name: | Venkatesh Rao | |
| House No.: | E-38/598 | | House No.: | E-40/603/2 | | House No.: | E-43/594/1 | |
| Age: | 37 | Sex: Female | Age: | 39 | Sex: Female | Age: | 31 | Sex: Female |
| 674 | REJ0447466 | | 675 | REJ0447508 | | 676 | REJ0578179 | |
| Name : | Uma Devi | | Name : | Roopa | | Name : | Channappa | |
| Husband's Name: | Ramaswamy | | Husband's Name: | Rama Swamy | | Father's Name: | Nagappa | |
| House No.: | E-44/586 | | House No.: | E-44/586 | | House No.: | E-47/503/1 | |
| Age: | 42 | Sex: Female | Age: | 25 | Sex: Female | Age: | 53 | Sex: Male |
| 677 | REJ0441899 | | 678 | REJ0574327 | | 679 | REJ0574350 | |
| Name : | Premakka | | Name : | Varadaraju | | Name : | Ravichandra | |
| Husband's Name: | Channappa | | Father's Name: | Channappa | | Father's Name: | Channappa | |
| House No.: | E-47/503/1 | | House No.: | E-47/503/1 | | House No.: | E-47/503/1 | |
| Age: | 41 | Sex: Female | Age: | 33 | Sex: Male | Age: | 28 | Sex: Male |
| 680 | REJ0441816 | | 681 | REJ0441824 | | 682 | REJ0607135 | |
| Name : | Lakshmi Devi | | Name : | Asha | | Name : | Ramesh | |
| Husband's Name: | Varadaraju | | Father's Name: | Rajanna | | Father's Name: | Venkatesh | |
| House No.: | E-47/503/1 | | House No.: | E-47/503/1 | | House No.: | E-49/641 | |
| Age: | 27 | Sex: Female | Age: | 26 | Sex: Female | Age: | 28 | Sex: Male |
| 683 | REJ0389015 | | 684 | REJ3625951 | | 685 | REJ3627643 | |
| Name : | Santhosh | | Name : | Rajalakshmi L. | | Name : | Vinod | |
| Father's Name: | Roop Singh | | Husband's Name: | Krishnappa B. | | Father's Name: | Kariyappa | |
| House No.: | E-50/535 | | House No.: | :264 | | House No.: | :309 | |
| Age: | 29 | Sex: Male | Age: | 31 | Sex: Female | Age: | 25 | Sex: Male |
| 686 | REJ0446682 | | 687 | REJ3624384 | | 688 | MCL3048451 | |
| Name : | R Manjula | | Name : | Lokesh | | Name : | Siddaraju H R | |
| Husband's Name: | Lokesh M N | | Father's Name: | Nanjundappa | | Father's Name: | Ramaiah | |
| House No.: | :363 | | House No.: | :363 | | House No.: | :418 | |
| Age: | 30 | Sex: Female | Age: | 35 | Sex: Male | Age: | 33 | Sex: Male |
| 689 | MCL3091956 | | 690 | MCL3087822 | | 691 | MCL3086824 | |
| Name : | Brundadevi | | Name : | Velu | | Name : | Kasthuri | |
| Husband's Name: | Siddaraju | | Father's Name: | Huchchagiriappa | | Husband's Name: | Velu | |
| House No.: | :418 | | House No.: | :420 | | House No.: | :420 | |
| Age: | 33 | Sex: Female | Age: | 45 | Sex: Male | Age: | 38 | Sex: Female |
| 692 | MBQ0073049 | | 693 | MBQ7107022 | | 694 | MBQ0072322 | |
| Name : | N Chandra | | Name : | Kumari | | Name : | Uday Kumar | |
| Father's Name: | Narasimhaiah | | Husband's Name: | N Chandra | | Father's Name: | Narasimhaiah | |
| House No.: | :498 | | House No.: | :498 | | House No.: | :521 | |
| Age: | 53 | Sex: Male | Age: | 38 | Sex: Female | Age: | 51 | Sex: Male |
| 695 | MBQ0071852 | | 696 | REJ4374211 | | 697 | REJ0442772 | |
| Name : | Rathnamma | | Name : | Varalakshmi | | Name : | Shobha R | |
| Husband's Name: | Uday Kumar | | Husband's Name: | Somashekhar | | Mother's Name: | Chikkathayamma | |
| House No.: | :521 | | House No.: | :529 | | House No.: | :533 | |
| Age: | 38 | Sex: Female | Age: | 23 | Sex: Female | Age: | 34 | Sex: Female |

Section No.:007)6th Cross Hosakere Halli., Ward No: 160 -560085 Continued

| | | | | | | | | |
|-----------------|---------------|-------------|-----------------|----------------|-------------|-----------------|----------------|-------------|
| 698 | REJ0605618 | | 699 | REJ0440743 | | 700 | MCL3089588 | |
| Name : | Srinivasa | | Name : | Lakshamma | | Name : | Appayyanna | |
| Father's Name: | Sampagaiah | | Husband's Name: | Srinivasa | | Father's Name: | Thammannappa | |
| House No.: | 587 | | House No.: | 587 | | House No.: | 622 | |
| Age: | 34 | Sex: Male | Age: | 28 | Sex: Female | Age: | 52 | Sex: Male |
| 701 | MCL3052602 | | 702 | MCL3051851 | | 703 | MCL3088036 | |
| Name : | Rathnamma | | Name : | Gowramma | | Name : | Mahesha | |
| Husband's Name: | Appayyanna | | Husband's Name: | Nagaraju | | Father's Name: | Mariyappa | |
| House No.: | 622 | | House No.: | 624 | | House No.: | 625 | |
| Age: | 43 | Sex: Female | Age: | 47 | Sex: Female | Age: | 37 | Sex: Male |
| 704 | MCL3048931 | | 705 | MCL3049558 | | 706 | MCL3090248 | |
| Name : | Uma | | Name : | Puttachennamma | | Name : | Shivakumara | |
| Husband's Name: | Mahesha | | Husband's Name: | Nagalingegowda | | Father's Name: | Nagalingegowda | |
| House No.: | 625 | | House No.: | 626 | | House No.: | 626 | |
| Age: | 34 | Sex: Female | Age: | 68 | Sex: Female | Age: | 42 | Sex: Male |
| 707 | MCL3052529 | | 708 | MCL3090040 | | 709 | MCL3053162 | |
| Name : | Latha | | Name : | Ramakrishna | | Name : | Jayalakshmi | |
| Husband's Name: | Shivakumara | | Father's Name: | Madabovi | | Husband's Name: | Ramakrishna | |
| House No.: | 626 | | House No.: | 627 | | House No.: | 627 | |
| Age: | 36 | Sex: Female | Age: | 49 | Sex: Male | Age: | 41 | Sex: Female |
| 710 | MCL3053535 | | 711 | MBQ0072702 | | 712 | MCL3047966 | |
| Name : | Rathnamma | | Name : | Manjunatha | | Name : | Kempachari | |
| Husband's Name: | Mariyappa | | Father's Name: | Mariyappa | | Father's Name: | Chinnachar | |
| House No.: | 628 | | House No.: | 629 | | House No.: | 630 | |
| Age: | 53 | Sex: Female | Age: | 37 | Sex: Male | Age: | 73 | Sex: Male |
| 713 | MBQ7076003 | | 714 | MCL3050895 | | 715 | MCL3090289 | |
| Name : | Ravi | | Name : | Jayamma | | Name : | Venkatesh | |
| Father's Name: | Kempachari | | Husband's Name: | Raju | | Others Name: | Jayamma | |
| House No.: | 630 | | House No.: | 632 | | House No.: | 632 | |
| Age: | 29 | Sex: Male | Age: | 42 | Sex: Female | Age: | 38 | Sex: Male |
| 716 | MBQ0073213 | | 717 | MBQ0072389 | | 718 | REJ0580910 | |
| Name : | Rachamma | | Name : | Ravi | | Name : | Guramalla | |
| Husband's Name: | Madaiah | | Father's Name: | Madaiah | | Father's Name: | Madaiah | |
| House No.: | 633 | | House No.: | 633 | | House No.: | 633 | |
| Age: | 59 | Sex: Female | Age: | 42 | Sex: Male | Age: | 37 | Sex: Male |
| 719 | REJ0442616 | | 720 | MCL3092764 | | 721 | MCL3049830 | |
| Name : | Latha | | Name : | Madeva | | Name : | Lakshamma | |
| Husband's Name: | Ravi | | Father's Name: | Madaiah | | Husband's Name: | Madeva | |
| House No.: | 633 | | House No.: | 634 | | House No.: | 634 | |
| Age: | 33 | Sex: Female | Age: | 45 | Sex: Male | Age: | 39 | Sex: Female |
| 722 | MCL3089398 | | 723 | MCL3050978 | | 724 | MCL3089505 | |
| Name : | Jagannatharao | | Name : | Sumithrabai | | Name : | Mahendra | |
| Father's Name: | Shamarao | | Husband's Name: | Jagannatharao | | Father's Name: | Jagannatharao | |
| House No.: | 635 | | House No.: | 635 | | House No.: | 635 | |
| Age: | 53 | Sex: Male | Age: | 52 | Sex: Female | Age: | 37 | Sex: Male |
| 725 | MCL3051117 | | 726 | MCL3089406 | | 727 | MCL3051109 | |
| Name : | Gayathri | | Name : | Vasudevarao | | Name : | Chandrakala | |
| Husband's Name: | Mahendra | | Father's Name: | G Madhava Rao | | Husband's Name: | Vasudevarao | |
| House No.: | 635 | | House No.: | 636 | | House No.: | 636 | |
| Age: | 33 | Sex: Female | Age: | 38 | Sex: Male | Age: | 33 | Sex: Female |

Section No.:007)6th Cross Hosakere Halli., Ward No: 160 -560085 Continued

| | | | | | | | | |
|-----------------|---------------|-------------|-----------------|----------------|-------------|-----------------|-----------------|-------------|
| 728 | MCL3051372 | | 729 | MCL3054699 | | 730 | MCL3053931 | |
| Name : | Jayamma | | Name : | V Gayathri | | Name : | Pramila | |
| Husband's Name: | Venkataramu | | Father's Name: | Venkataramu | | Husband's Name: | Kumaraswamy | |
| House No.: | 638 | | House No.: | 638 | | House No.: | 639 | |
| Age: | 49 | Sex: Female | Age: | 32 | Sex: Female | Age: | 43 | Sex: Female |
| 731 | MCL3053402 | | 732 | MCL3092756 | | 733 | MCL3049210 | |
| Name : | Hanumakka | | Name : | Ravikumar | | Name : | Lalitha | |
| Husband's Name: | Ramaiah | | Father's Name: | Ramaiah | | Others Name: | Muralikumar | |
| House No.: | 640-A | | House No.: | 640-A | | House No.: | 641 | |
| Age: | 60 | Sex: Female | Age: | 33 | Sex: Male | Age: | 33 | Sex: Female |
| 734 | MCL3049236 | | 735 | MCL3049228 | | 736 | MCL3048022 | |
| Name : | Shanthakumari | | Name : | Nirmala | | Name : | Venkatesh | |
| Husband's Name: | Muralikumar | | Others Name: | Muralikumar | | Father's Name: | Huchchagiriappa | |
| House No.: | 641 | | House No.: | 641 | | House No.: | 643 | |
| Age: | 33 | Sex: Female | Age: | 33 | Sex: Female | Age: | 31 | Sex: Male |
| 737 | MCL3049863 | | 738 | MBQ0042838 | | 739 | MBQ0042846 | |
| Name : | Jayamma | | Name : | Chandrakala | | Name : | Pushpalatha | |
| Husband's Name: | Dorai | | Father's Name: | Gurumurthy | | Father's Name: | Gurumurthy | |
| House No.: | 644 | | House No.: | 645 | | House No.: | 645 | |
| Age: | 37 | Sex: Female | Age: | 34 | Sex: Female | Age: | 32 | Sex: Female |
| 740 | MBQ0042101 | | 741 | REJ3621620 | | 742 | MBQ0042267 | |
| Name : | Basavaraju | | Name : | Nagamma | | Name : | Mahesha | |
| Father's Name: | Basavegowda | | Husband's Name: | Basavaraju | | Father's Name: | Basavaraju | |
| House No.: | 647 | | House No.: | 647 | | House No.: | 647 | |
| Age: | 68 | Sex: Male | Age: | 59 | Sex: Female | Age: | 35 | Sex: Male |
| 743 | MCL3088291 | | 744 | MCL3092533 | | 745 | MCL3054558 | |
| Name : | Venkatesh | | Name : | Lakshmidevi | | Name : | Manjula | |
| Father's Name: | Ramanna | | Husband's Name: | Venkatesh | | Husband's Name: | Raj | |
| House No.: | 654 | | House No.: | 654 | | House No.: | 655 | |
| Age: | 43 | Sex: Male | Age: | 37 | Sex: Female | Age: | 38 | Sex: Female |
| 746 | MCL3089992 | | 747 | MCL3051638 | | 748 | MCL3052099 | |
| Name : | Chandrappa | | Name : | Rathnamma | | Name : | K G Kusuma | |
| Father's Name: | Thimmaiah | | Husband's Name: | Chandrappa | | Husband's Name: | B L Lingappa | |
| House No.: | 656 | | House No.: | 656 | | House No.: | 658 | |
| Age: | 53 | Sex: Male | Age: | 45 | Sex: Female | Age: | 48 | Sex: Female |
| 749 | MCL3051612 | | 750 | MCL3053196 | | 751 | MCL3092137 | |
| Name : | Padma | | Name : | Lakshamma | | Name : | Shankarashetty | |
| Husband's Name: | Venkatesh | | Husband's Name: | Shankarashetty | | Father's Name: | Rajaiah Shetty | |
| House No.: | 659 | | House No.: | 661 | | House No.: | 661 | |
| Age: | 33 | Sex: Female | Age: | 33 | Sex: Female | Age: | 28 | Sex: Male |
| 752 | MCL3092343 | | 753 | MCL3054152 | | 754 | MCL3091634 | |
| Name : | Rudregowda | | Name : | Gowramma | | Name : | Rajanna | |
| Father's Name: | Kuntamaregaud | | Husband's Name: | Rudregowda | | Father's Name: | Kumara | |
| House No.: | 662 | | House No.: | 662 | | House No.: | 664 | |
| Age: | 40 | Sex: Male | Age: | 35 | Sex: Female | Age: | 53 | Sex: Male |
| 755 | MCL3053725 | | 756 | MCL3090982 | | 757 | MCL3053113 | |
| Name : | Lakshamma | | Name : | Narasimhaiah | | Name : | Jayalakshmi | |
| Husband's Name: | Rajanna | | Father's Name: | Venkataiah | | Husband's Name: | Narasimhaiah | |
| House No.: | 664 | | House No.: | 666 | | House No.: | 666 | |
| Age: | 41 | Sex: Female | Age: | 48 | Sex: Male | Age: | 35 | Sex: Female |

Section No.:007)6th Cross Hosakere Halli., Ward No: 160 -560085 Continued

| | | | | | | | | |
|-----------------|-----------------|-------------|-----------------|-----------------|-------------|-----------------|------------------|-------------|
| 758 | MCL3091006 | | 759 | MCL3053188 | | 760 | MCL3053089 | |
| Name : | Cheluvaiah | | Name : | Kempamma | | Name : | Sarasamma | |
| Father's Name: | Bettaiah | | Husband's Name: | Cheluvaiah | | Husband's Name: | Ramachandrappa | |
| House No.: | 667 | | House No.: | 667 | | House No.: | 668 | |
| Age: | 55 | Sex: Male | Age: | 51 | Sex: Female | Age: | 73 | Sex: Female |
| 761 | MCL3090826 | | 762 | MBQ7107048 | | 763 | MCL3053634 | |
| Name : | Dwarakesha | | Name : | Sangeetha | | Name : | Sakamma | |
| Father's Name: | Ramachandrappa | | Husband's Name: | Dwarakesha | | Husband's Name: | Mahadevappa | |
| House No.: | 668 | | House No.: | 668 | | House No.: | 669 | |
| Age: | 38 | Sex: Male | Age: | 31 | Sex: Female | Age: | 58 | Sex: Female |
| 764 | MCL3086196 | | 765 | MCL3051174 | | 766 | MCL3092301 | |
| Name : | Mahadevappa | | Name : | Rathnamma | | Name : | M C Thippeswamy | |
| Father's Name: | Sadappa | | Husband's Name: | Mahadevappa | | Father's Name: | M Chinnaswamappa | |
| House No.: | 671 | | House No.: | 671 | | House No.: | 673 | |
| Age: | 63 | Sex: Male | Age: | 49 | Sex: Female | Age: | 77 | Sex: Male |
| 767 | MCL3053923 | | 768 | MCL3092319 | | 769 | MCL3090115 | |
| Name : | Padmamma | | Name : | M T Madhu | | Name : | Puttaswamegowda | |
| Husband's Name: | M Thippeswamy | | Father's Name: | Thippeswamy M | | Father's Name: | M. Thippeswamy | |
| House No.: | 673 | | House No.: | 673 | | House No.: | 674 | |
| Age: | 51 | Sex: Female | Age: | 32 | Sex: Male | Age: | 65 | Sex: Male |
| 770 | MCL3049996 | | 771 | MCL3088846 | | 772 | MCL3087343 | |
| Name : | Devamma | | Name : | Umesha | | Name : | Shekar | |
| Husband's Name: | Puttaswamegowda | | Father's Name: | Puttaswamegowda | | Father's Name: | Puttaswamegowda | |
| House No.: | 674 | | House No.: | 674 | | House No.: | 674 | |
| Age: | 59 | Sex: Female | Age: | 33 | Sex: Male | Age: | 31 | Sex: Male |
| 773 | MCL3088382 | | 774 | MCL3053915 | | 775 | MCL3052875 | |
| Name : | N S Kumara | | Name : | Padma | | Name : | Rajamma | |
| Father's Name: | Shivannagowda | | Husband's Name: | N S Kumara | | Husband's Name: | Arunachalam | |
| House No.: | 676 | | House No.: | 676 | | House No.: | 677 | |
| Age: | 45 | Sex: Male | Age: | 37 | Sex: Female | Age: | 73 | Sex: Female |
| 776 | MCL3052859 | | 777 | MCL3092525 | | 778 | MCL3092350 | |
| Name : | Parvathamma | | Name : | Padma | | Name : | Srinivas | |
| Husband's Name: | Srinivas | | Husband's Name: | Srinivasu | | Father's Name: | Arunachalam | |
| House No.: | 677 | | House No.: | 677 | | House No.: | 677 | |
| Age: | 49 | Sex: Female | Age: | 41 | Sex: Female | Age: | 37 | Sex: Male |
| 779 | REJ3621703 | | 780 | MCL3092749 | | 781 | MCL3050069 | |
| Name : | Sanjayakumar | | Name : | Vijayakumar | | Name : | Gowramma | |
| Father's Name: | Srinivasu | | Father's Name: | Srinivasu | | Husband's Name: | Chennaviregowda | |
| House No.: | 677 | | House No.: | 677 | | House No.: | 679 | |
| Age: | 33 | Sex: Male | Age: | 31 | Sex: Male | Age: | 43 | Sex: Female |
| 782 | MCL3087269 | | 783 | MCL3049319 | | 784 | MBQ0073031 | |
| Name : | Nagesh | | Name : | Mangala | | Name : | Sadashiva | |
| Father's Name: | Munishetty | | Husband's Name: | Nagesh | | Father's Name: | Govindaswamy | |
| House No.: | 681 | | House No.: | 681 | | House No.: | 684 | |
| Age: | 41 | Sex: Male | Age: | 39 | Sex: Female | Age: | 58 | Sex: Male |
| 785 | MCL3051992 | | 786 | MCL3087293 | | 787 | MCL3053006 | |
| Name : | Selva | | Name : | Jayaram | | Name : | Saroja | |
| Husband's Name: | Sadashiva | | Father's Name: | Manashetti | | Husband's Name: | Jayaram | |
| House No.: | 684 | | House No.: | 685 | | House No.: | 685 | |
| Age: | 43 | Sex: Female | Age: | 43 | Sex: Male | Age: | 40 | Sex: Female |

Section No.:007)6th Cross Hosakere Halli.,, Ward No: 160 -560085 Continued

| | | | | | | | | |
|-----------------|-----------------------|-------------|-----------------|---------------------|-------------|-----------------|----------------|-------------|
| 788 | MBQ0072298 | | 789 | MCL3049871 | | 790 | REJ0442467 | |
| Name : | Muniraja | | Name : | Jayasheela | | Name : | Gopamma | |
| Father's Name: | Muniyappa | | Husband's Name: | Muniraja | | Husband's Name: | Manashetti | |
| House No.: | 686 | | House No.: | 686 | | House No.: | 687 | |
| Age: | 46 | Sex: Male | Age: | 37 | Sex: Female | Age: | 65 | Sex: Female |
| 791 | MCL3054459 | | 792 | MCL3054657 | | 793 | MCL3055795 | |
| Name : | Nagamma | | Name : | Kempamma | | Name : | Umesha | |
| Father's Name: | Manashetti | | Husband's Name: | Ramachandra | | Father's Name: | Ramachandra | |
| House No.: | 687 | | House No.: | 688 | | House No.: | 688 | |
| Age: | 43 | Sex: Female | Age: | 43 | Sex: Female | Age: | 31 | Sex: Male |
| 794 | MCL3091337 | | 795 | MCL3054772 | | 796 | MCL3049889 | |
| Name : | B M Vishweshwaraiah | | Name : | Mahalakshmi N | | Name : | Jayamma | |
| Father's Name: | Muththashetti | | Husband's Name: | B M Vishweshwaraiah | | Husband's Name: | Nagaraju | |
| House No.: | 689 | | House No.: | 689 | | House No.: | 689-A | |
| Age: | 55 | Sex: Male | Age: | 47 | Sex: Female | Age: | 52 | Sex: Female |
| 797 | MCL3088853 | | 798 | REJ0388934 | | 799 | MCL3053808 | |
| Name : | Nagaraju | | Name : | Chennegowda | | Name : | Bharathinayaka | |
| Father's Name: | Doddavenkataramanappa | | Father's Name: | Siddegowda | | Husband's Name: | Chennegowda | |
| House No.: | 689-1 | | House No.: | 691 | | House No.: | 691 | |
| Age: | 57 | Sex: Male | Age: | 42 | Sex: Male | Age: | 39 | Sex: Female |
| 800 | MCL3048352 | | 801 | MCL3051364 | | 802 | MCL3050044 | |
| Name : | Ramaiah | | Name : | Lakshmi | | Name : | Ellamma | |
| Father's Name: | Basappa | | Husband's Name: | Ramaiah | | Husband's Name: | Balagurumurthi | |
| House No.: | 692 | | House No.: | 692 | | House No.: | 693 | |
| Age: | 48 | Sex: Male | Age: | 38 | Sex: Female | Age: | 37 | Sex: Female |
| 803 | MBQ0042291 | | 804 | MCL3049822 | | 805 | MCL3052222 | |
| Name : | Hanumantharayappa | | Name : | Chawdamma | | Name : | Jayamma | |
| Father's Name: | Chikkayellappa | | Husband's Name: | Hanumantharayappa | | Husband's Name: | Krishnappa | |
| House No.: | 695 | | House No.: | 695 | | House No.: | 696 | |
| Age: | 49 | Sex: Male | Age: | 40 | Sex: Female | Age: | 58 | Sex: Female |
| 806 | MBQ0072991 | | 807 | MCL3053469 | | 808 | REJ0576777 | |
| Name : | Byrappa | | Name : | Bharathi | | Name : | Doddanna | |
| Father's Name: | Nanjappa | | Husband's Name: | Byrappa | | Father's Name: | Narasaiah | |
| House No.: | 698 | | House No.: | 698 | | House No.: | 699 | |
| Age: | 48 | Sex: Male | Age: | 41 | Sex: Female | Age: | 46 | Sex: Male |
| 809 | MBQ0043109 | | 810 | MCL3092780 | | 811 | MCL3054749 | |
| Name : | Manjula | | Name : | Jayaram | | Name : | Shivamma | |
| Husband's Name: | Doddanna | | Father's Name: | Huchchaiah | | Husband's Name: | Jayaram | |
| House No.: | 699 | | House No.: | 701 | | House No.: | 701 | |
| Age: | 43 | Sex: Female | Age: | 53 | Sex: Male | Age: | 48 | Sex: Female |
| 812 | MCL3054764 | | 813 | MCL3091261 | | 814 | MCL3091717 | |
| Name : | Prema | | Name : | Narasimhaiah | | Name : | Lakshmidevi | |
| Mother's Name: | Madeva | | Father's Name: | Munivenkatappa | | Others Name: | Narasimhaiah | |
| House No.: | 701 | | House No.: | 702 | | House No.: | 702 | |
| Age: | 45 | Sex: Female | Age: | 78 | Sex: Male | Age: | 58 | Sex: Female |
| 815 | MCL3096146 | | 816 | MCL3096138 | | 817 | REJ0577650 | |
| Name : | Balakrishna | | Name : | Pushpa | | Name : | Chethan | |
| Father's Name: | Narasimhaiah | | Husband's Name: | Balakrishna | | Father's Name: | Chikkanna | |
| House No.: | 702 | | House No.: | 702 | | House No.: | 844 | |
| Age: | 41 | Sex: Male | Age: | 33 | Sex: Female | Age: | 25 | Sex: Male |

Section No.:007)6th Cross Hosakere Halli.,, Ward No: 160 -560085 Continued

| | | | |
|-----------------|-------------|--|--|
| 818 | MCL3050077 | | |
| Name : | Gangamma | | |
| Husband's Name: | Gopal | | |
| House No.: | 6514 | | |
| Age: 53 | Sex: Female | | |

Supplement No. :1

Mother Roll : Basic (Mother) Roll of 2014
 Supplement Process & Year : Summary Revision - 2014
 Supplement Type : Lists of Additions, Deletions & Corrections

I) Additions List

Section No.:001)Shani mahatma Road Bangarappanagar Hosakerehalli, , Ward No: 160 -560085

| | | | | | | | | |
|------------------|-----------------|-------------|-----------------|------------------|-------------|----------------|----------------------|-------------|
| 819 | REJ6287866 | | 820 | REJ6287585 | | 821 | REJ6287643 | |
| Name : | Prema T | | Name : | Honne Gowda | | Name : | Shambulingegowda.N.R | |
| Husband's Name: | Late V Srinivas | | Father's Name: | Ramegowda | | Father's Name: | Ramegowda | |
| House No.: | 350/728 | | House No.: | 41 | | House No.: | 41 | |
| Age: | 46 | Sex: Female | Age: | 34 | Sex: Male | Age: | 41 | Sex: Male |
| 822 | REJ6287700 | | 823 | REJ6287783 | | 824 | REJ6288005 | |
| Name : | Bhavya.B.S | | Name : | Vijaya.D | | Name : | Pushpa K | |
| Husband's Name: | Honnegowda | | Husband's Name: | Shambulingegowda | | Father's Name: | Krishna Murthy | |
| House No.: | 41 | | House No.: | 41 | | House No.: | 640 | |
| Age: | 27 | Sex: Female | Age: | 34 | Sex: Female | Age: | 24 | Sex: Female |
| 825 | REJ6288039 | | | | | | | |
| Name : | Pradeep N | | | | | | | |
| Father's Name: | Ningegowda | | | | | | | |
| House No.: | 651 | | | | | | | |
| Age: | 22 | Sex: Male | | | | | | |
| | | Male | | | Female | | | Others |
| No. of Additions | | 3 | | | 4 | | | 0 |
| | | | | | | | | Total |
| | | | | | | | | 7 |

II) Deletions List

II) Deletions Nil

III) Modifications List

III) Modifications Nil

| Supplement No. :2 | |
|--------------------------------|---|
| | |
| Mother Roll : | Basic (Mother) Roll of 2014 |
| Supplement Process & Year : | Summary Revision - 2014 |
| Supplement Type : | Lists of Additions, Deletions & Corrections |
| I) Additions List | |
| | I) Additions Nil |
| II) Deletions List | |
| | II) Deletions Nil |
| III) Modifications List | |
| | III) Modifications Nil |

Supplement No. :3

Mother Roll : Basic (Mother) Roll of 2014

Supplement Process & Year : Continuous Updation 2014
(01-02-2014 to 26-03-2014)

Supplement Type : Lists of Additions, Deletions & Corrections

I) Additions List

Section No.:001)Shani mahatma Road Bangarappanagar Hosakerehalli, , Ward No: 160 -560085

| | | | | | | | | |
|-----------------|-----------------|-------------|----------------|-----------------|-------------|-----------------|-----------------|-------------|
| 826 | REJ6730204 | | 827 | REJ6730295 | | 828 | REJ6730303 | |
| Name : | Pratibha | | Name : | Shruthi | | Name : | Umesh | |
| Husband's Name: | Umesh | | Father's Name: | Nagaraju | | Father's Name: | Umesh | |
| House No.: | 167 | | House No.: | 167 | | House No.: | 167 | |
| Age: | 26 | Sex: Female | Age: | 21 | Sex: Female | Age: | 26 | Sex: Male |
| 829 | REJ6730147 | | 830 | REJ6730105 | | 831 | REJ6730279 | |
| Name : | Prema.T | | Name : | Govindaraj | | Name : | Shruthi V | |
| Husband's Name: | Late.Srinivas.V | | Father's Name: | Thimmaiah | | Father's Name: | Venkatesha | |
| House No.: | 350/728 | | House No.: | 50 | | House No.: | 613 | |
| Age: | 46 | Sex: Female | Age: | 28 | Sex: Male | Age: | 19 | Sex: Female |
| 832 | REJ6729990 | | 833 | REJ6730154 | | 834 | REJ6730246 | |
| Name : | Pushpa.K | | Name : | Ramesh | | Name : | Radha | |
| Father's Name: | Krishnappa | | Father's Name: | Murthy | | Husband's Name: | Ramesh | |
| House No.: | 640 | | House No.: | 649 | | House No.: | 649 | |
| Age: | 24 | Sex: Female | Age: | 33 | Sex: Male | Age: | 28 | Sex: Female |
| 835 | REJ6730121 | | 836 | REJ6730014 | | 837 | REJ6730261 | |
| Name : | Pradeep.N | | Name : | H E Kumar Swamy | | Name : | Vanjakshi | |
| Father's Name: | Ningegowda | | Father's Name: | Eshappa | | Husband's Name: | H E Kumar Swamy | |
| House No.: | 651 | | House No.: | 735 | | House No.: | 735 | |
| Age: | 23 | Sex: Male | Age: | 37 | Sex: Male | Age: | 34 | Sex: Female |
| 838 | REJ6730162 | | 839 | REJ6730212 | | | | |
| Name : | Usharani V | | Name : | Raghavendra A G | | | | |
| Father's Name: | Venkatesh | | Father's Name: | Amanajappa | | | | |
| House No.: | 814 | | House No.: | 88 | | | | |
| Age: | 18 | Sex: Female | Age: | 29 | Sex: Male | | | |

| | Male | Female | Others | Total |
|------------------|------|--------|--------|-------|
| No. of Additions | 6 | 8 | 0 | 14 |

II) Deletions List

II) Deletions Nil

III) Modifications List

III) Modifications Nil

| | | | | | | |
|---|--|------------------------------------|------------|--------------|---------------------|--------------|
| State Code & Name : S10 - KARNATAKA | | | | | | |
| No., Name and reservation Status of Assembly Constituency : | 154 - Rajarajeshwarinagar (Gen) | | | | Part No.:322 | |
| A) NUMBER OF ELECTORS | | | | | | |
| | Roll Identification | Roll Type | Men | Women | Others | Total |
| I) Original | Mother Roll | Basic (Mother) Roll of 2014 | 403 | 415 | 0 | 818 |
| II) Additions List | | | | | | |
| | Supplement - 1 | Summary Revision - 2014 | 3 | 4 | 0 | 7 |
| | Supplement - 2 | Summary Revision - 2014 | 0 | 0 | 0 | 0 |
| | Supplement - 3 | Continuous Updation 2014 | 6 | 8 | 0 | 14 |
| III) Deletions List | | | | | | |
| | Supplement - 1 | Summary Revision - 2014 | 0 | 0 | 0 | 0 |
| | Supplement - 2 | Summary Revision - 2014 | 0 | 0 | 0 | 0 |
| | Supplement - 3 | Continuous Updation 2014 | 0 | 0 | 0 | 0 |
| Net Electors in the Roll after Continuous Updation 2014 (I+II-III) | | | 412 | 427 | 0 | 839 |

| | | |
|---------------------------------|----------------------------|---------------------------|
| B) NUMBER OF CORRECTIONS | | |
| Roll Type | Roll Identification | No. of Corrections |
| | | |
| Supplement - 1 | Summary Revision - 2014 | 0 |
| Supplement - 2 | Summary Revision - 2014 | 0 |
| Supplement - 3 | Continuous Updation 2014 | 0 |

Place **Rajarajeshwarinagar.**
Date **26-03-2014**

Electoral Registration Officer
154-Rajarajeshwarinagar Assembly Constituency
And
Revenue Officer, Bruhat Bangalore Mahanagar
Palike, Rajarajeshwarinagar
Zone,, Rajarajeshwarinagar.